

SYSTEM COMPONENT REFL BOLT

Accessories

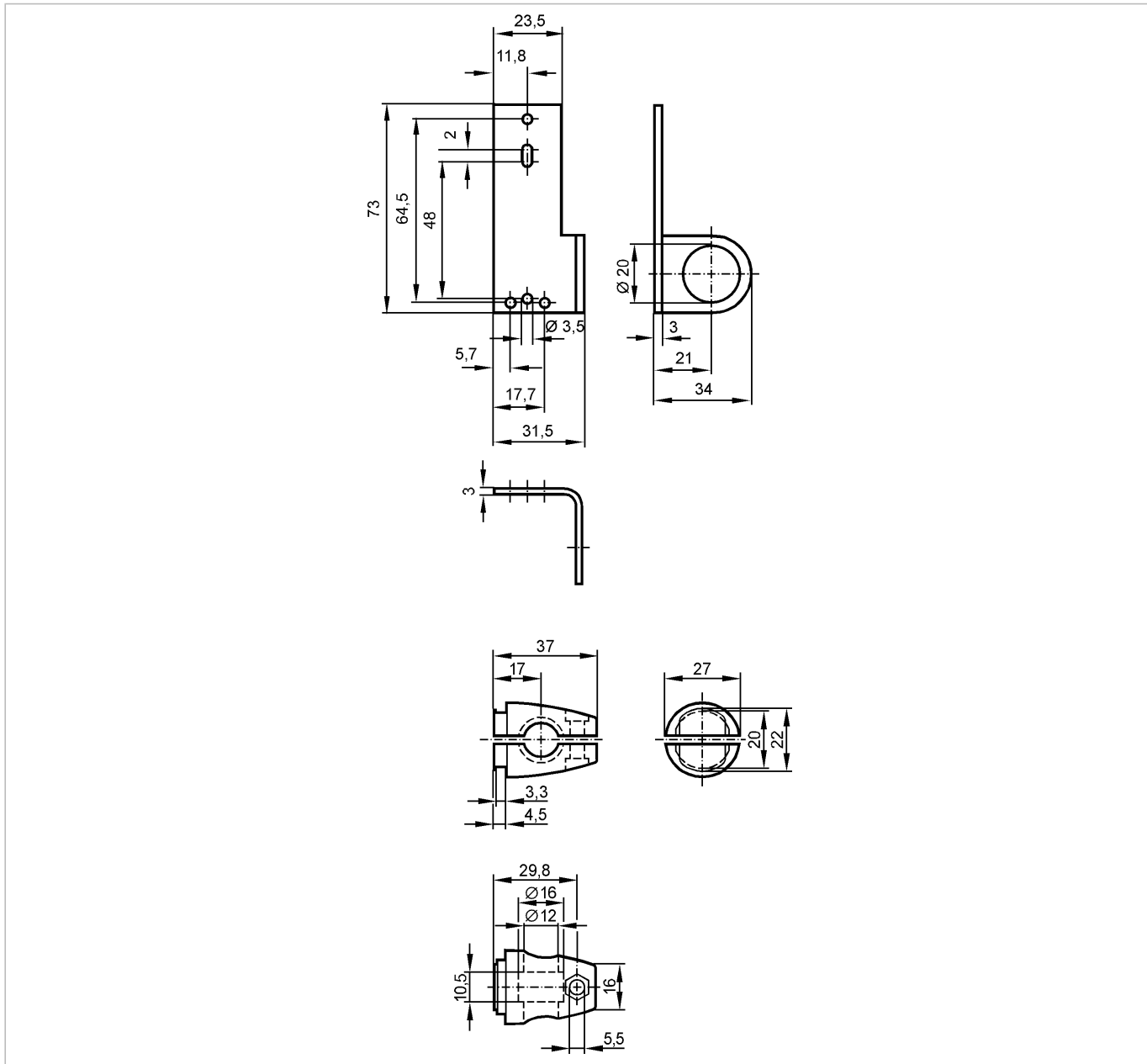

Product characteristics

Mounting set

Clamp mounting

Mechanical data

Design

for reflector; 72.5 x 19 mm

Housing materials

fixture: stainless steel 316Ti / 1.4571; clamp: stainless steel (316C)

Type of mounting

Free-standing M10

Weight [kg]

0.215

Accessories

Accessories (included)

Head cap screw; M10 x 55

Remarks

Pack quantity [piece]

1