

E80100

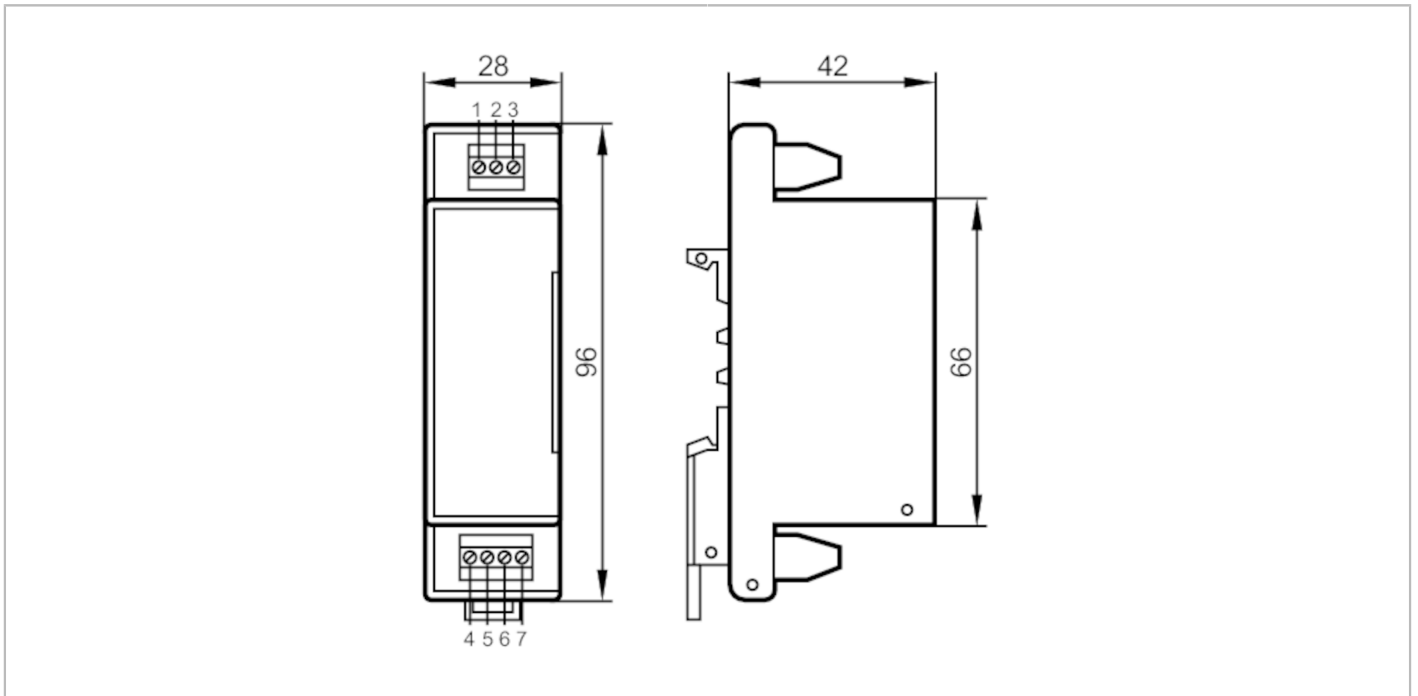

Pulse divider

PULSE DIVIDER/10:1



Product characteristics

Dimensions [mm] 96 x 28 x 42

Application

Application adaptation of fast pulse sequences to the setting ranges of the control monitor or slow plc inputs; averaging; Ratio input/output pulse 10:1

Electrical data

Operating voltage tolerance [%] 10
Operating voltage [V] 24 DC
Current consumption [mA] < 13

Operating conditions

Ambient temperature [°C] -20...70

Tests / approvals

MTTF [years] 2154

Mechanical data

Weight [g] 79.5
Dimensions [mm] 96 x 28 x 42
Materials plastics

E80100



Pulse divider

PULSE DIVIDER/10:1

Electrical connection

Connection

