



RCD- MODULE RCD510 BASIC RCD TYPE A SIDE MOUNTED ADJUSTABLE 0,03...5A AT 50/60HZ ADJUSTABLE TV 0...1000MSEC 3- POLE IN=160A UE=127-480V ACCESSORY FOR: 3VA1 WITH CABLE LUG

Figure similar

Model		
product brand name		SENTRON
General technical data		
Number of poles		3
Supply voltage		
Supply voltage frequency / Rated value	Hz	60
Protection class		
Protection class IP / on the front		IP40
Dissipation		
Active power loss		
• maximum	W	12
Electricity		
Current / with AC / Rated value	A	160
Current / for combination of MCCB and RCD		
• at 40 °C / Rated value	A	160
• at 45 °C / Rated value	A	144
• at 50 °C / Rated value	A	122.4
• at 55 °C / Rated value	A	97.92
• at 60 °C / Rated value	A	73.44
• at 65 °C / Rated value	A	51.408
• at 70 °C / Rated value	A	33.4152
Frequency / of fault current		
• minimum	Hz	50

- maximum

Hz	60
----	----

Product details

Product component / Trip indicator		Yes
Product property / sealable		Yes



Product function

Product function		
• remote tripping		No
• Integrated / alarm management		Yes

Environmental conditions

Ambient temperature		
• during operation / minimum	°C	-25
• during operation / maximum	°C	70
• during storage / minimum	°C	-40
• during storage / maximum	°C	80

Certificates

General Product Approval	EMC	Declaration of Conformity	other
	other	 EG-Konf.	other

Further information

- Information- and Downloadcenter (Catalogs, Brochures,...)**
<http://www.siemens.com/lowvoltage/catalogs>
- Industry Mall (Online ordering system)**
<https://eb.automation.siemens.com/mall/en/WW/Catalog/Product/3VA91130RS20>
- Service&Support (Manuals, Certificates, Characteristics, FAQs,...)**
<http://support.automation.siemens.com/WW/view/en/3VA91130RS20/all>
- Image database (product images, 2D dimension drawings, 3D models, device circuit diagrams, ...)**
http://www.automation.siemens.com/bilddb/cax_en.aspx?mlfb=3VA91130RS20
- CAX-Online-Generator**
<http://www.siemens.com/cax>
- Tender specifications**
<http://ausschreibungstexte.siemens.com/tiplv>

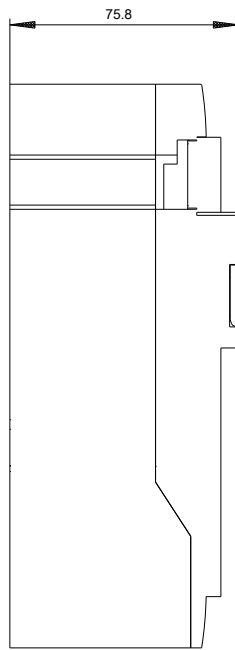
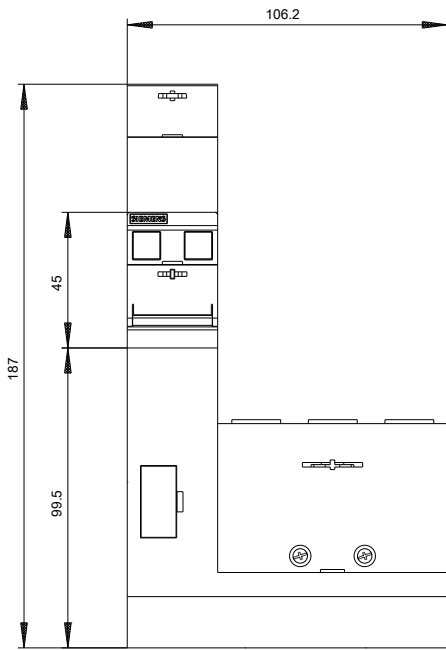

last modified:

11.03.2015