

EAO – Your Expert Partner for Human Machine Interfaces

82-6151.1123 - Illuminated pushbutton 16 mm stainless-steel, momentary

82-6151.1123 - Illuminated pushbutton 16 mm stainless-steel, momentary



Attention: The preview is based on a sample product. This can differ from your current configuration.

Mounting

Mounting cut-out	Ø 19 mm
Design	flush

Front

Front dimension	Ø 22 mm
Front shape	round
Front ring shape	flush

Other Attributes

Operating voltage	12 V AC/DC
Weight	0.018 kg
Operation current	14 mA

Operating-/Indication part

Lens optics	opaque
Lens material	Stainless steel
Lens profile	flat
Lens illumination	illuminative
Lens colour	Stainless steel

IP-Rating

Front protection	IP 67
------------------	-------

Connection Method

Terminal	Solder 2.8 x 0.5 mm
----------	---------------------

Actuator

Switching action	Momentary
------------------	-----------

Switching element

Switching current	5 A
Contact material	Silver
Contacts	1 C
Switching system	Snap-action switching element
Switching voltage	250 V AC

Illumination

Illumination	Ring with blue LED
--------------	--------------------

Function

Illuminated pushbutton

EAO – Your Expert Partner for Human Machine Interfaces

82-6151.1123 - Illuminated pushbutton 16 mm stainless-steel, momentary

Dimensions

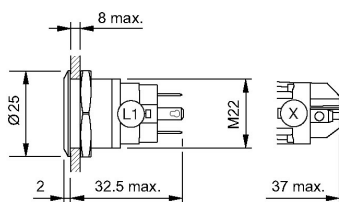

Mounting cut-outs

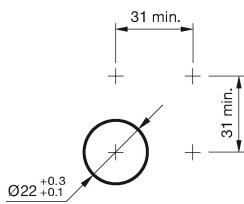

Wiring diagram

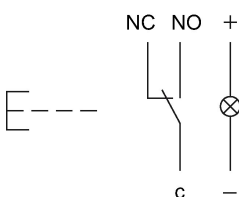

Component layout



Legend

Switching action: B = Momentary

Contacts: C = Changeover