

## AS Weld connector

Butt weld / EO 24° cone end

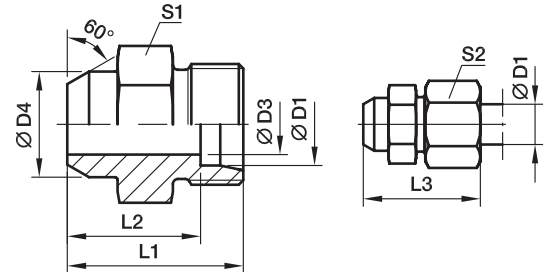

Series	D1	D3	D4	L1	L2	L3	S1	S2	Weight g/1 piece	Order code	PN (bar) <sup>1)</sup>	
											Steel	Stainless Steel
L <sup>3)</sup>	06	4	10	21	14.0	29	12	14	11	<b>AS06L</b>	315	315
	08	6	12	23	16.0	31	14	17	15	<b>AS08L</b>	315	315
	10	8	14	25	18.0	33	17	19	22	<b>AS10L</b>	315	315
	12	10	16	25	18.0	33	19	22	25	<b>AS12L</b>	315	315
	15	12	19	29	22.0	37	22	27	44	<b>AS15L</b>	315	315
	18	15	22	31	23.5	40	27	32	67	<b>AS18L</b>	315	315
	22	19	27	36	28.5	45	32	36	98	<b>AS22L</b>	160	160
	28	24	32	38	30.5	47	41	41	165	<b>AS28L</b>	160	160
	35	30	40	43	32.5	54	46	50	232	<b>AS35L</b>	160	160
	42	36	46	46	35.0	58	55	60	342	<b>AS42L</b>	160	160
S <sup>4)</sup>	06	4	11	26	19.0	34	14	17	21	<b>AS06S</b>	630	630
	08	5	13	28	21.0	36	17	19	31	<b>AS08S</b>	630	630
	10	7	15	30	22.5	39	19	22	41	<b>AS10S</b>	630	630
	12	8	17	32	24.5	41	22	24	93	<b>AS12S</b>	630	630
	14	10	19	35	27.0	45	24	27	55	<b>AS14S</b>	630	630
	16	12	21	35	26.5	45	27	30	82	<b>AS16S</b>	400	400
	20	16	26	40	29.5	51	32	36	131	<b>AS20S</b>	400	400
	25	20	31	44	32.0	56	41	46	219	<b>AS25S</b>	400	400
	30	25	36	49	35.5	62	46	50	297	<b>AS30S</b>	400	400
	38	32	44	54	38.0	69	55	60	448	<b>AS38S</b>	315	315

<sup>1)</sup> Pressure shown = item deliverable

<sup>3)</sup> L = light series; <sup>4)</sup> S = heavy series

$$\frac{\text{PN (bar)}}{10} = \text{PN (MPa)}$$

Delivery without nut and ring. Information on ordering complete fittings or alternative sealing materials see page I7.

\*Please add the **suffixes** below according to the material/surface required.

Order code suffixes		
Material	Suffix surface and material	Example
Steel		AS16SX
Stainless Steel	71X	AS16S71X