

# EPIC® H-B 6 Housings

Housing style H-B. The industry standard.



## H-B 6 TG

### Suitable inserts:

- EPIC® H-BE 6 Screw termination see page 443
- EPIC® H-DD 24 see page 440
- EPIC® H-EE 10 see page 449
- EPIC® MCR 6 see page 462
- EPIC® H-BE 6 Crimp termination see page 443
- EPIC® H-BE 6 Cage clamp see page 443

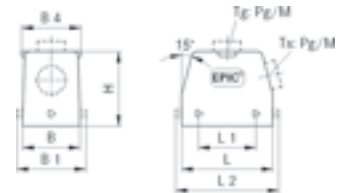

## H-B 6 TGH

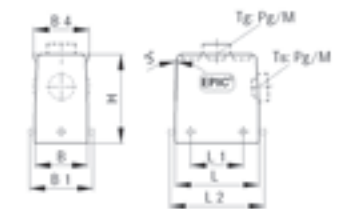

## H-B 6 TS

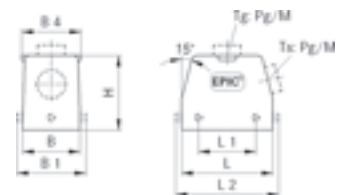

Part number	Part	PG	M	ZW	L	I2	B	B4	H
<b>H-B housing: Hood (straight cable entry, bolts for single lever)</b>									
10011000	H-B 6 TG 13,5	13,5		yes	60	74,8	43	45	52
10021000	H-B 6 TG 16	16		yes	60	74,8	43	45	52
19011000	H-B 6 TG M20		20		60	74,8	43	45	52
19021000	H-B 6 TG M25		25		60	74,8	43	45	52
<b>H-B housing: Hood (straight cable entry, bolts for single lever, high version)</b>									
70020200	H-B 6 TGH 21	21		yes	60	74,8	43	45	72
70020400	H-B 6 TGH 29	29		yes	60	74,8	43	45	72
79020200	H-B 6 TGH M25		25		60	74,8	43	45	72
79020400	H-B 6 TGH M32		32		60	74,8	43	45	72
<b>H-B housing: Hood (side cable entry, bolts for single lever)</b>									
10012000	H-B 6 TS 13,5	13,5		yes	60	74,8	43		52
10022000	H-B 6 TS 16	16		yes	60	74,8	43		52
19012000	H-B 6 TS M20		20	yes	60	74,8	43		52
19022000	H-B 6 TS M25		25	yes	60	74,8	43		52

# EPIC® H-B 6 Housings

Housing style H-B. The industry standard.



## H-B 6 TSH

### Suitable inserts:

- EPIC® H-BE 6 Screw termination see page 443
- EPIC® H-DD 24 see page 440
- EPIC® H-EE 10 see page 449
- EPIC® MCR 6 see page 462
- EPIC® H-BE 6 Crimp termination see page 443
- EPIC® H-BE 6 Cage clamp see page 443



## H-B 6 AG-LB



## H-B 6 AD-LB

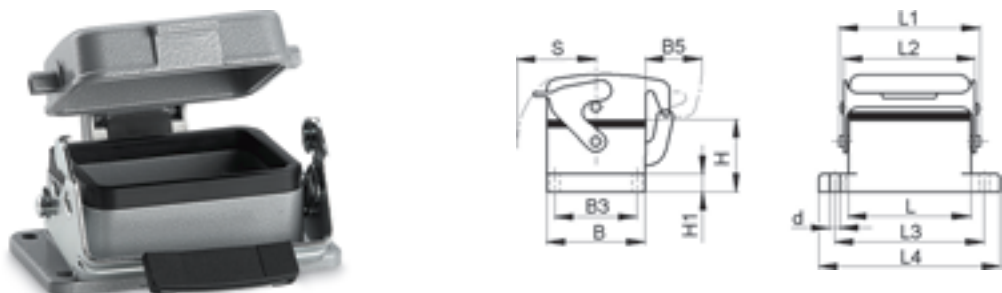

Part number	Part	PG	M	ZW	L	L1	I2	L3	L4	B	B3	B4	B5	H	H1	s	d
<b>H-B housing: Hood (side cable entry, bolts for single lever, high version)</b>																	
70022200	H-B 6 TSH 21	21		yes	60		74,8			43		45		72			
70022400	H-B 6 TSH 29	29		yes	60		74,8			43		45		72			
79022200	H-B 6 TSH M25		25		60		74,8			43		45		72			
79022400	H-B 6 TSH M32		32		60		74,8			43		45		72			
<b>H-B housing: Panel mount base (single lever)</b>																	
10003000	H-B 6 AG-LB				60	74,8	70	70	80	43	32		25	27,8	4	44	4,3
<b>H-B housing: Panel mount base (cover, single lever)</b>																	
10004000	H-B 6 AD-LB				60	74,8	70	70	80	43	32		25	27,8	4	44	4,3

The standard inserts with screw termination, crimp termination and cage clamp termination



## H-BE 6 screw termination

The characteristic qualities of the proven EPIC® H-BE series are their suitability for applications with high voltages and current as well as their high reliability.

Ranges of application:  
From machine building to control cabinet manufacturing, Light & Sound, polymer engineering

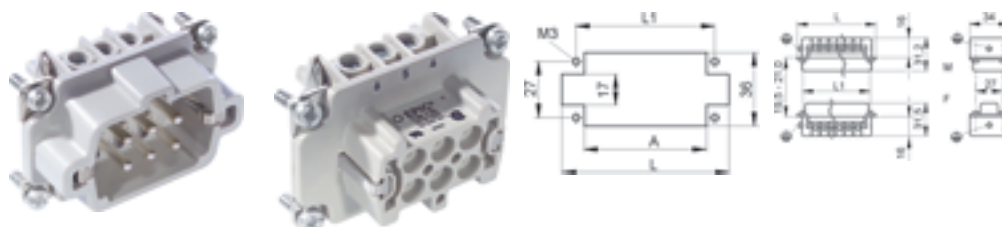

## Suitable housing:

EPIC® H-B 6 Housings see page 485

## H-BE 6 crimp termination

## Suitable housing:

EPIC® H-B 6 Housings see page 485

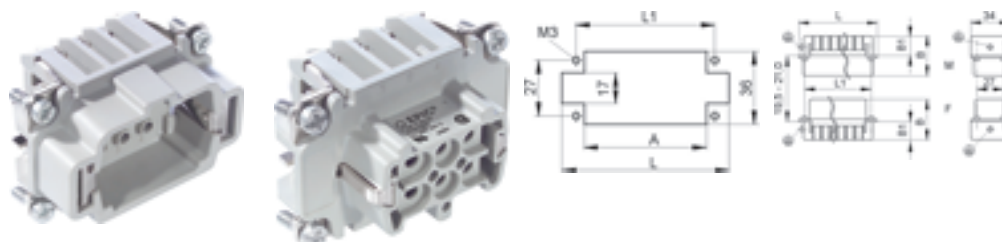

## Suitable contacts:

EPIC® H-BE 2,5 machined contacts see page 466

## H-BE 6 cage clamp

## Suitable housing:

EPIC® H-B 6 Housings see page 485

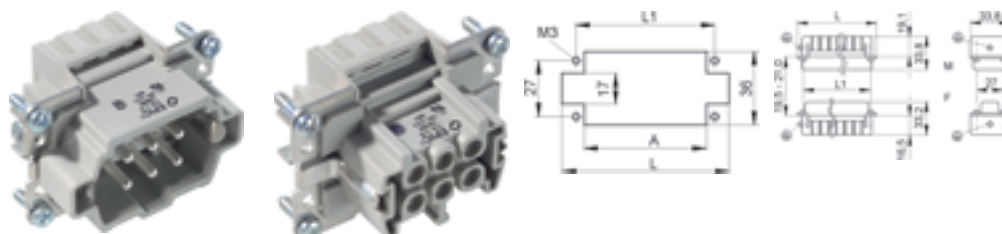

## Technical Data

Rated voltage  
IEC: 500 V  
UL: 600 V  
CSA: 600 V

Rated impulse Voltage  
6 kV

Rated current  
IEC: 16 A  
UL: 16 A  
CSA: 16 A

Pollution degree  
3

Contact resistance  
EPIC® H-BE 6 Screw termination  
< 2 mOhm  
EPIC® H-BE 6 Crimp termination  
< 2 mOhm  
EPIC® H-BE 6 Cage clamp  
1.5 - 4 mOhm

Contacts  
EPIC® H-BE 6 Screw termination  
Copper alloy, hard silver plated  
EPIC® H-BE 6 Crimp termination  
Copper alloy, hard silver / gold plated  
EPIC® H-BE 6 Cage clamp  
Copper alloy, hard silver plated

Numbers of contacts  
6 + PE

Termination methods  
EPIC® H-BE 6 Screw termination  
Screw termination: 0.5 - 2.5 mm<sup>2</sup>  
EPIC® H-BE 6 Crimp termination  
Crimp termination: 0.5 - 4.0 mm<sup>2</sup>  
EPIC® H-BE 6 Cage clamp  
Cage clamp termination: 0.5 - 2.5 mm<sup>2</sup>

Cycle of mechanical operation  
100

Range of temperature  
-40°C - +100°C, temporary up to +125°C

Part number	Part	Version	Type	Wire protection	Contacts	L	L1	A	B	B1
<b>H-BE 6 screw termination</b>										
10190000	H-BE 6 SS	male		yes	1 - 6	51	44	39		
10191000	H-BE 6 BS	female		yes	1 - 6	51	44	39		
10190100	H-BE 6 SS	male		-	1 - 6	51	44	39		
10191100	H-BE 6 BS	female		-	1 - 6	51	44	39		
<b>H-BE 6 crimp termination</b>										
10180000	H-BE 6 SCM	male	machined		1 - 6	51	44	39	33	18
10181000	H-BE 6 BCM	female	machined		1 - 6	51	44	39	34	18
<b>H-BE 6 cage clamp termination</b>										
10400000	H-BE 6 SF	male			1 - 6	49,8	44	39		
10401000	H-BE 6 BF	female			1 - 6	49,8	44	39		

VDE approval is not valid for applications using the cage clamp termination

## 5.1 EPIC® CERTOSA M & PG

Kabelverschraubungen PG / Cable glands PG thread / Presse-étoupes pas PG

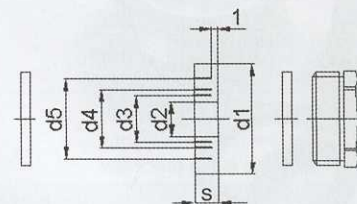

### EPIC® SP

Art.Nr. part No. N° art.	PG	d1	d2	Kabel Ø cable Ø câble Ø	d3	Kabel Ø cable Ø câble Ø	d4	Kabel Ø cable Ø câble Ø	d5	Kabel Ø cable Ø câble Ø	s	SW mm opening of the spanner ouverture de clef	VPE packing unit conditionnement
12957100	11	16,5	7,5	6,5-8,5	10	9-11	12,5	11,5-12			6	19	10
12957200	13,5	18,3	7,5	6,5-8,5	10	9-11	12,5	11,5-13,5			6	21	10
12957300	16	20,4	7,5	6,5-8,5	10	9-11	12,5	11,5-13,5	15	14,9-16	7	23	10
12957400	21	25,9	10	9-11	13	12-14	16	15-17	19	18-20	8	30	10

Material / material / matière: Polystyrol

Schutzart / protection class / degré de protection: IP 54 (DIN 46320)

Temperaturbereich / temperature range / gamme de température: -20 °C bis +55 °C

5

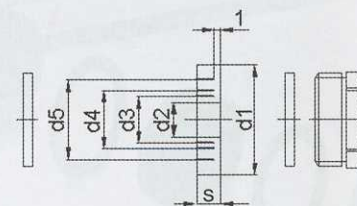

### EPIC® SM

Art.Nr. part No. N° art.	PG	d1	d2	Kabel Ø cable Ø câble Ø	d3	Kabel Ø cable Ø câble Ø	d4	Kabel Ø cable Ø câble Ø	d5	Kabel Ø cable Ø câble Ø	s	SW mm opening of the spanner ouverture de clef	VPE packing unit conditionnement
12954100	9	13,3	5	4-6	7,5	6,5-8,5	10	9-10			5,5	15	25
12954200	11	16,5	7,5	6,5-8,5	10	9-11	12,5	11,5-12			6	18	5
12954300	13,5	18,3	7,5	6,5-8,5	10	9-11	12,5	11,5-13,5			6	20	5
12954400	16	20,4	7,5	6,5-8,5	10	9-11	12,5	11,5-13,5	15	14-16	7	22	5
12954500	21	25,9	10	9-11	13	12-14	16	15-17	19	18-20	8	28	5
12954600	29	34,7	18	17-19	21	20-22	24	23-25	27	26-28	9,5	37	5
12954700	36	44,7	24	23-25	27	26-28	30	29-31	33	32-34	12	47	5
12954800	42	51,7	30	29-31	33	32-34	36	35-37	39	38-40	14	54	5

Material / material / matière: Metall, Messing vernickelt / metal, brass, nickel plated / métallique, laiton nickelage

Schutzart / protection class / degré de protection: IP 54 (DIN 46320)

Temperaturbereich / temperature range / gamme de température: -40 °C bis +80 °C