

RSDF 4/0,2 M

Einbausteckverbinder, M5-Stecker für die Frontmontage, konfektioniert mit Schalllitze, Leiteranschlussbereich vergossen, einbauseitig M5 x 0,5-Verschraubung (Befestigung über RSKFM 5)

Receptacle connector, M5 male connector for front mounting, assembled stranded wire, solder contacts potted with epoxy, chassis side thread M5 x 0.5 (panel nut RSKFM 5)

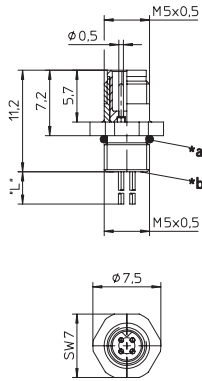

RSMF/0,5 M

Einbausteckverbinder, M8-Stecker für die Frontmontage, konfektioniert mit Schalllitze, Leiteranschlussbereich vergossen, einbauseitig M8 x 0,5-Verschraubung (Befestigung über RSKF 8)

Receptacle connector, M8 male connector for front mounting, assembled stranded wire, solder contacts potted with epoxy, chassis side thread M8 x 0.5 (panel nut RSKF 8)

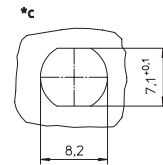
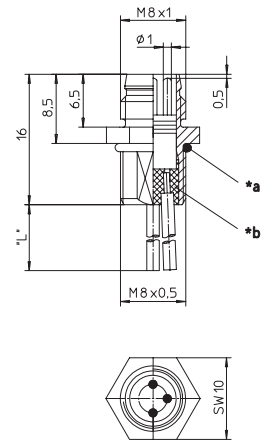

*a O-Ring
O-ring
*b Leiteranschlussbereich vergossen
solder contacts potted with epoxy
"L" 0,2 m

*a O-Ring lose beige stellt
O-ring enclosed separately
*b Leiteranschlussbereich vergossen
solder contacts potted with epoxy
*c Einbauöffnung
cut out
"L" 0,5 m

Pinbelegung Pin assignment

4-polig M5 4 poles M5

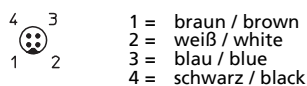

3-polig M8 3 poles M8

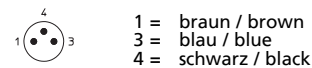

4-polig M8 4 poles M8

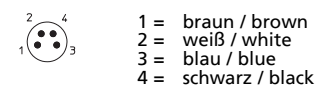



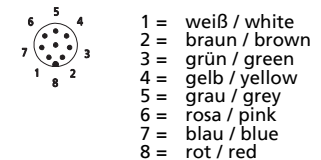

8-polig M8 8 poles M8



Technische Daten	
Umgebungstemperatur	-25°C / +80°C
Werkstoffe	
Gehäuse / Griffkörper	CuZn, vernickelt
Kontaktträger	PA
Kontakt	RSDf: CuZn, unternickelt und vergoldet RSMF: CuZn, unternickelt und 0,8 µm vergoldet
O-Ring	FKM
Mechanische Daten	
Schutzart	IP 67 Nur im verriegelten oder verschraubten Zustand mit den dazugehörigen Gegenstücken.
Elektrische Daten	
Durchgangswiderstand	RSDf: ≤ 3 mΩ RSMF: ≤ 5 mΩ
Nennstrom bei 40°C	RSDf / RSMF 8: 1 A RSMF: 4 A
Nennspannung	60 V RSMF 8: 32 V
Prüfspannung	1,5 kV eff. / 60 s RSMF 8: 0,8 kV eff. / 60 s
Isolationswiderstand	RSDf: > 10 ¹⁰ Ω RSMF: > 10 ⁹ Ω
Verschmutzungsgrad	3

Technical data	
Operating temperature range	-25°C / +80°C
Materials	
Housing / Molded body	CuZn, nickel-plated
Insert	PA
Contact	RSDf: CuZn, pre-nickel and gold-plated RSMF: CuZn, pre-nickel and 0.8 microns gold-plated
O-ring	FKM
Mechanical data	
Degree of protection	IP 67 Only in locked position with its proper counterparts.
Electrical data	
Contact resistance	RSDf: ≤ 3 mΩ RSMF: ≤ 5 mΩ
Nominal current at 40°C	RSDf / RSMF 8: 1 A RSMF: 4 A
Nominal voltage	60 V RSMF 8: 32 V
Test voltage	1.5 kV eff. / 60 s RSMF 8: 0.8 kV eff. / 60 s
Insulation resistance	RSDf: > 10 ¹⁰ Ω RSMF: > 10 ⁹ Ω
Pollution degree	3

Bestellbezeichnung Designation	Polzahl Poles	Leiter (mm ²) Lead (mm ²)	
RSMF 3/0,5 M	3	0.22	 
RSDf 4/0,2 M	4	0.22	
RSMF 4/0,5 M		0.22	 
RSMF 8/0,5 M	8	0.22	