

PIN

AISI 303 stainless steel.

PAWLS

AISI 304 stainless steel.

SPRING AND LIFTING RING

AISI 301 stainless steel.

PUSH BUTTON

AISI 303 stainless steel.

FEATURES AND APPLICATIONS

GN 214.6 lock pins are generally used for quick fixation of components or parts to be machined, in particular for elements which need to be removed and reset continuously.

ACCESSORIES

To optimise the use of these lock pins, have been designed:

- ball chains GN 111 (see page 818);
- retaining cables GN 111.2 (see page 817);
- spiral retaining cables GN 111.4 (see page 818).

INSTRUCTIONS OF USE

The two pawls exert a radial retaining action thanks to the internal spring.

By pressing the push button the two pawls are freed and the pin can be engaged or disengaged.



Application example

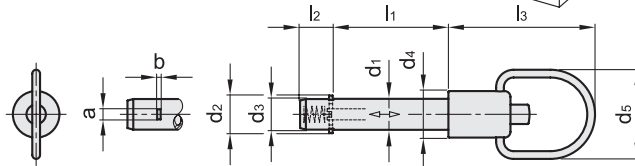
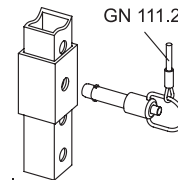

Code	Description	d1-0.01	d2	d3	d4	d5	l1+0.4	l2	l3	a	b	Double sided shearing force [KN]	⚖️
GN.37151	GN 214.6-6-16	6	7.5 +0.5	5.9	12	23	16	7	38	2.3	0.5	17	20
GN.37152	GN 214.6-6-20	6	7.5 +0.5	5.9	12	23	20	7	38	2.3	0.5	17	21
GN.37153	GN 214.6-6-25	6	7.5 +0.5	5.9	12	23	25	7	38	2.3	0.5	17	22
GN.37154	GN 214.6-6-30	6	7.5 +0.5	5.9	12	23	30	7	38	2.3	0.5	17	23
GN.37155	GN 214.6-6-40	6	7.5 +0.5	5.9	12	23	40	7	38	2.3	0.5	17	25
GN.37161	GN 214.6-8-20	8	10 +0.5	7.9	12	23	20	8.4	38	2.8	0.6	35	25
GN.37162	GN 214.6-8-25	8	10 +0.5	7.9	12	23	25	8.4	38	2.8	0.6	35	27
GN.37163	GN 214.6-8-30	8	10 +0.5	7.9	12	23	30	8.4	38	2.8	0.6	35	29
GN.37164	GN 214.6-8-40	8	10 +0.5	7.9	12	23	40	8.4	38	2.8	0.6	35	32
GN.37165	GN 214.6-8-50	8	10 +0.5	7.9	12	23	50	8.4	38	2.8	0.6	35	36
GN.37171	GN 214.6-10-20	10	12 +1	9.9	16	28	20	9.8	42	3.3	1	47	49
GN.37172	GN 214.6-10-25	10	12 +1	9.9	16	28	25	9.8	42	3.3	1	47	52
GN.37173	GN 214.6-10-30	10	12 +1	9.9	16	28	30	9.8	42	3.3	1	47	55
GN.37174	GN 214.6-10-40	10	12 +1	9.9	16	28	40	9.8	42	3.3	1	47	60
GN.37175	GN 214.6-10-50	10	12 +1	9.9	16	28	50	9.8	42	3.3	1	47	66
GN.37181	GN 214.6-12-25	12	14 +1	11.9	16	28	25	11.3	42	3.8	1	75	61
GN.37182	GN 214.6-12-30	12	14 +1	11.9	16	28	30	11.3	42	3.8	1	75	65
GN.37183	GN 214.6-12-40	12	14 +1	11.9	16	28	40	11.3	42	3.8	1	75	73
GN.37184	GN 214.6-12-50	12	14 +1	11.9	16	28	50	11.3	42	3.8	1	75	82
GN.37185	GN 214.6-12-60	12	14 +1	11.9	16	28	60	11.3	42	3.8	1	75	91
GN.37191	GN 214.6-16-30	16	19 +1	15.9	20	32	30	14.2	46.5	4.8	1.2	138	119
GN.37192	GN 214.6-16-35	16	19 +1	15.9	20	32	35	14.2	46.5	4.8	1.2	138	128
GN.37193	GN 214.6-16-40	16	19 +1	15.9	20	32	40	14.2	46.5	4.8	1.2	138	135
GN.37194	GN 214.6-16-50	16	19 +1	15.9	20	32	50	14.2	46.5	4.8	1.2	138	150
GN.37195	GN 214.6-16-60	16	19 +1	15.9	20	32	60	14.2	46.5	4.8	1.2	138	165
GN.37196	GN 214.6-16-70	16	19 +1	15.9	20	32	70	14.2	46.5	4.8	1.2	138	183

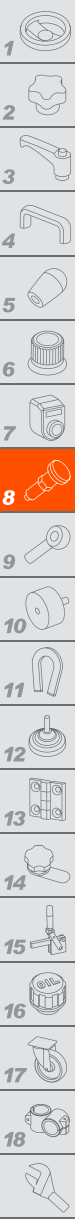

Indexing and positioning elements