



SOLID-STATE TIME-DELAY AUXILIARY SWITCH,  
OFF-DELAY WITH AUXILIARY VOLTAGE RELAY 1  
CO CONTACT 24...240V AC/DC TIME RANGE  
0.05...100S FOR SNAPPING ONTO THE FRONT; FOR  
3RT2 S00-S2 CONTACTORS SCREW TERMINALS  
INTEGRATED VARISTOR FOR DAMPING  
CONTACTOR COILS

General technical data:

<b>product brand name</b>		SIRIUS
<b>Product designation</b>		auxiliary switch
<b>Design of the product</b>		off-delayed with auxiliary voltage
<b>Protection class IP on the front</b>		IP20
<b>Protection class IP of the terminal</b>		IP20
<b>Degree of pollution</b>		3
Insulation voltage with degree of pollution 3 Rated value	V	300
<b>Installation altitude at height above sea level maximum</b>	m	2 000
<b>Ambient temperature</b>		
• during storage	°C	-40 ... +85
• during operation	°C	-25 ... +60
• during transport	°C	-40 ... +85
EMI immunity acc. to IEC 60947-1		ambience A (industrial sector)
EMC emitted interference acc. to IEC 60947-1		CISPR11, ambience A (industrial sector)
Conducted interference due to burst acc. to IEC 61000-4-4		2 kV network connection / 1 kV control connection
Conducted interference due to conductor-earth surge acc. to IEC 61000-4-5		2 kV
Conducted interference due to conductor-conductor surge acc. to IEC 61000-4-5		1 kV
Electrostatic discharge acc. to IEC 61000-4-2		8 kV
Field-bound parasitic coupling acc. to IEC 61000-4-3		10 V/m
<b>Shock resistance</b>		15g / 11 ms

<b>Vibration resistance</b>		10 ... 55 Hz / 0.35 mm
<b>Surge voltage resistance Rated value</b>	kV	4
<b>Equipment marking acc. to DIN 40719 extended according to IEC 204-2 acc. to IEC 750</b>		K
<b>Equipment marking acc. to DIN EN 61346-2</b>		K
<b>Adjustable time</b>	s	0.05 ... 100
<b>Switching function</b>		
• ON-delay		No
• OFF delay		Yes
<b>Switching function</b>		
• with control signal		
— OFF delay		Yes
— pulse-shaping		No
• without control signal OFF delay		No
<b>Product component semi-conductor output</b>		No
<b>Product expansion</b>		
• optional remote control		No
• required remote control		No
<b>Product function</b>		
• star-delta circuit		No
• at the relay outputs Switchover delayed/without delay		No

#### Control circuit/ Control:

<b>Design of the surge suppressor</b>		with varistor
Supply voltage required Auxiliary voltage		Yes
Type of voltage of the control supply voltage		AC/DC
<b>Control supply voltage frequency 1</b>	Hz	50 ... 60
<b>Control supply voltage 1</b>		
• for DC	V	24 ... 240
• with AC		
— at 50 Hz	V	24 ... 240
— at 60 Hz	V	24 ... 240
Operating range factor control supply voltage rated value of the magnet coil		0.85 ... 1.1

#### Auxiliary circuit:

<b>Operating current of the auxiliary contacts</b>		
• at AC-15 at 250 V	A	3
• at DC-13		
— at 24 V	A	1
— at 125 V	A	0.2
— at 250 V	A	0.1

### Installation/ mounting/ dimensions:

<b>Mounting type</b>		clip-on
<b>Width</b>	mm	45
<b>Height</b>	mm	38
<b>Depth</b>	mm	74
<b>Required spacing with side-by-side mounting</b>		
• upwards	mm	0
• downwards	mm	0
• forwards	mm	0
• Backwards	mm	0
• at the side	mm	0
<b>Required spacing for grounded parts</b>		
• upwards	mm	0
• downwards	mm	0
• forwards	mm	0
• Backwards	mm	0
• at the side	mm	0
<b>Required spacing for live parts</b>		
• upwards	mm	0
• downwards	mm	0
• forwards	mm	0
• Backwards	mm	0
• at the side	mm	0

### Connections/ Terminals:

Type of electrical connection for auxiliary and control current circuit		screw-type terminals
Product function removable terminal for auxiliary and control circuit		Yes
<b>Type of connectable conductor cross-section</b>		
• for auxiliary contacts		
— solid		0.5 ... 4 mm <sup>2</sup> , 2x (0.5 ... 2.5 mm <sup>2</sup> )
— finely stranded		
— with core end processing		1x (0.5 ... 2.5 mm <sup>2</sup> ), 2x (0.5 ... 1.5 mm <sup>2</sup> )
• for AWG conductors for auxiliary contacts		2x (20 ... 14)

### Certificates/ approvals:

<b>Certificate of suitability</b>		CE / UL / CSA
• EC declaration of conformity		Yes
• CSA-approval		Yes
• UL approval		Yes

## General Product Approval



CCC



CSA



UL



## Test Certificates

[Special Test Certificate](#)

[Type Test Certificates/Test Report](#)

## Shipping Approval



ABS



BUREAU VERITAS



DNV



GL



LRS



RMRS

## other

[Declaration of Conformity](#)

[Environmental Confirmations](#)

[other](#)

## UL/CSA ratings:

Contact rating of the auxiliary contacts acc. to UL

B300 / R300

## Further information

**Information- and Downloadcenter (Catalogs, Brochures,...)**

<http://www.siemens.com/industrial-controls/catalogs>

**Industry Mall (Online ordering system)**

<http://www.siemens.com/industrymall>

**Cax online generator**

<http://support.automation.siemens.com/WW/CAXorder/default.aspx?lang=en&mlfb=3RA28141AW10>

**Service&Support (Manuals, Certificates, Characteristics, FAQs,...)**

<http://support.automation.siemens.com/WW/view/en/3RA28141AW10/all>

**Image database (product images, 2D dimension drawings, 3D models, device circuit diagrams, EPLAN macros, ...)**

<http://www.automation.siemens.com/bilddb/index.aspx?attID9=3RA28141AW10&lang=en>

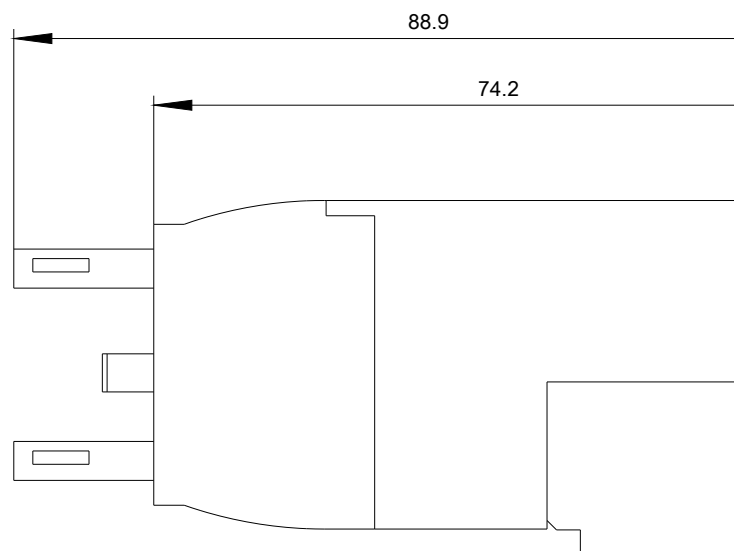
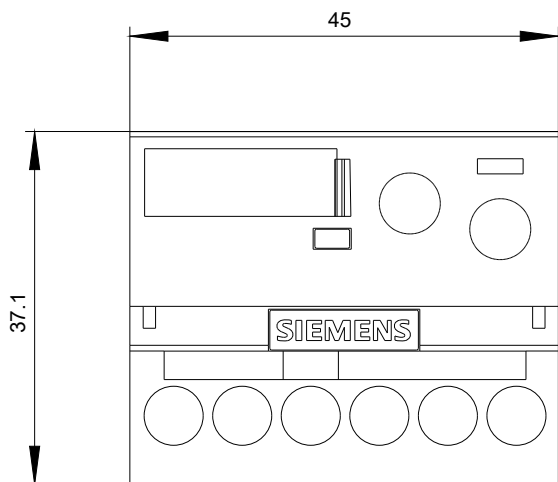

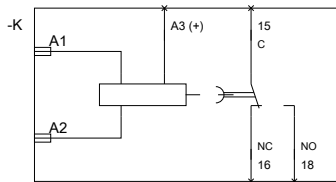

last modified:

09.03.2015