

DETAIL A
SCALE: 5:1

NOTES:

- COSMETIC SPECIFICATION REFER TO WI-QA-038.

SCALE DRAWING 1:1

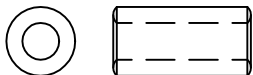

28B0375-300

RoHS

IMPEDANCE (Z)

Frequency	25 MHz	100 MHz	300 MHz
Nominal (REF)	100 Ω	194 Ω	310 Ω
Minimum	- Ω	155 Ω	- Ω

Z vs. FREQUENCY
(REF. ONLY)

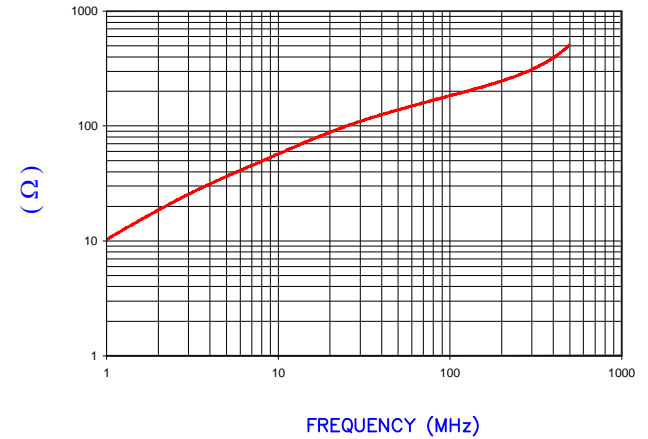

AGILENT E4991A Impedance/Material Analyzer
HP 16092A Test Fixture

DIMENSIONS

A	9.53 [.375]	+	0.20 [.008]
B	5.08 [.200]	+	0.15 [.006]
C	19.05 [.750]	+	0.51 [.020]

WEIGHT/1000 4.73 kgs 10.42 lbs

DIMENSIONS ARE IN MM [INCHES].

This print is the property of Laird Tech. and is loaned in confidence subject to return upon request and with the understanding that no copies shall be made without the written consent of Laird Tech. All rights to design or invention are reserved.



G	UPDATE LOGO AND ADD NOTES	10/10/14	Jcai	PROJECT/PART NUMBER: 28B0375-300	REV	PART TYPE:	DRAWN BY:
F	UPDATE LOGO REVISE CHAMFER DESIGN	11/03/08	JRK		G	CNZ CORE	LNK
E	ADD CURVE UPDATE Z SPECS, REMOVE COATING SPECS CHG P/N FROM 30*	05/12/03	JRK		SCALE:	3 : 1	MATERIAL:
D	UPDATE PRINT FORMAT	11/12/01	JRK		DATE:	8/04/92	Ferrite
C	CHG P/N TO 28B0375-30*, ADD COATING SPECS	03/26/99	I.S.		TOOL #	B0375	
B	UPDATED P/N FOR NEW CATALOG	12/11/95	JBE	CAD #	28B0375-300-G		
A	ORIGINAL DRAFT	8/04/92	LNK				
REV	DESCRIPTION	DATE	INT				