

## MOTOR FEATURES

| REFERENCE NUMBER<br>REFERENCIA<br>REFERENZNUMMERN | NOMINAL VOLTAGE<br>TENSION NOMINALE<br>NENNSPANNUNG | NOMINAL TORQUE<br>PAR NOMINAL<br>DREHMOMENT NOMINAL | NOMINAL SPEED<br>VELOCIDAD NOMINAL<br>VITESSE NOMINALE<br>GESCHWINDIGKEIT NOMINAL | NOMINAL CURRENT<br>CORRIENTE NOMINAL<br>COURANT NOMINAL<br>NOMINALSTROM | STARTING TORQUE<br>PAR DE ARRANQUE<br>COUPLE DE DEMARRAGE<br>ANZUGSDREHMOMENT | STARTING CURRENT<br>CORRIENTE DE ARRANQUE<br>COUPLET DE DEMARRAGE<br>ANZUGSTROM | SHAFT<br>EJE<br>ARBRE<br>WELLE | CONNECTIONS<br>CONEXIONES<br>CONNEXIONS<br>ANSCHLUSSART | WIRING DIAGRAM<br>ESQUEMA ELECTRICO<br>SCHEMA ELECTRIQUE<br>SCHALTPLAN | TRANSMISSION RATIO<br>RELACION DE REDUCCION<br>RAPPORT DE REDUCTEUR<br>UNTERSATZUNG | APPROXIMATE WEIGHT<br>PESO APROXIMADO<br>POIDS APPROXIMATIF<br>GEWICHT (ca.) | WATER TIGHTNESS<br>GRADO DE ESTANQUEIDAD<br>ETANCHÉITÉ<br>FEUCHTIGKEITSSCHUTZKLASSE | WHEEL MATERIAL<br>MATERIAL RUEDA<br>MATERIAU ROUE<br>MATERIAL DES SCHNELLERENDES | DESIGN: A, B, C<br>DISEÑO: A, B, C<br>Dessin: A, B, C<br>ABBILDUNG: A, B, C | CURVE<br>CURVA<br>COURBE<br>KURVE |
|---|---|---|---|---|---|---|--------------------------------|---|--|---|--|---|--|---|-----------------------------------|
|   | Un<br>(V)   | Mn<br>(N.m./lbf.in)                                 | Pn<br>(r.p.m.)  | In<br>(A)   | Ma<br>(N.m./lbf.in)   | Ia<br>(A)   |                                |   |  | i   | P<br>(kg/lb)   | IP  |  |   |                                   |
| 11137112000                                       | 12  | 5 / 44.2  | 40  | 5   | 25 / 221.2  | 25  | E22                            | C25   | EE2  | 62:1  | 1.25 / 2.76  | IP53  | PLA  | A   | 1                                 |
| 11137113000                                       | 24  | 5 / 44.2  | 40  | 2.5   | 25 / 221.2  | 13  | E22                            | C25   | EE2  | 62:1  | 1.25 / 2.76  | IP53  | PLA  | A   | 1                                 |
| 11137612000                                       | 12  | 5 / 44.2  | 40  | 5   | 25 / 221.2  | 25  | E23                            | C25   | EE2  | 62:1  | 1.25 / 2.76  | IP53  | PLA  | A   | 1                                 |
| 11137613000                                       | 24  | 5 / 44.2  | 40  | 2.5   | 25 / 221.2  | 13  | E23                            | C25   | EE2  | 62:1  | 1.25 / 2.76  | IP53  | PLA  | A   | 1                                 |
| 11137612000E                                      | 12  | 5 / 44.2  | 40  | 5   | 25 / 221.2  | 25  | E23                            | C25   | F2   | 62:1  | 1.25 / 2.76  | IP53  | PLA  | A   | 1                                 |
| 11137613000E                                      | 24  | 5 / 44.2  | 40  | 2.5   | 25 / 221.2  | 13  | E23                            | C25   | F2   | 62:1  | 1.25 / 2.76  | IP53  | PLA  | A   | 1                                 |
| 11137632000                                       | 12  | 6 / 53.1  | 25  | 4   | 25 / 221.2  | 15  | E23                            | C25   | EE2  | 62:1  | 1.25 / 2.76  | IP53  | PLA  | A   | 3                                 |
| 11137633000                                       | 24  | 6 / 53.1  | 25  | 2   | 25 / 221.2  | 8   | E23                            | C25   | EE2  | 62:1  | 1.25 / 2.76  | IP53  | PLA  | A   | 3                                 |
| 11147613000                                       | 24  | 5 / 44.2  | 40  | 2.5   | 25 / 221.2  | 13  | E23                            | C25   | EE2  | 62:1  | 1.25 / 2.76  | IP53  | PLA  | B   | 1                                 |
| 11190312000                                       | 12  | 3 / 26.5  | 70  | 6   | 25 / 221.2  | 34  | E23                            | C25   | EE2  | 62:1  | 1.25 / 2.76  | IP53  | PLA  | A   | 2                                 |
| 11190313000                                       | 24  | 3 / 26.5  | 70  | 3   | 25 / 221.2  | 17  | E23                            | C25   | EE2  | 62:1  | 1.25 / 2.76  | IP53  | PLA  | A   | 2                                 |
| 11190392000                                       | 12  | 1.5 / 13.2  | 240   | 8   | 10 / 88.5   | 46  | E23                            | C26   | EE1  | 49:4  | 1.25 / 2.76  | IP53  | PLA  | A   | 4                                 |
| 11190393000                                       | 24  | 1.5 / 13.2  | 240   | 4   | 10 / 88.5   | 23  | E23                            | C26   | EE1  | 49:4  | 1.25 / 2.76  | IP53  | PLA  | A   | 4                                 |
| 11190413000                                       | 24  | 5 / 44.2  | 40  | 2.5   | 25 / 221.2  | 13  | E24                            | C25   | EE2  | 62:1  | 1.30 / 2.87  | IP53  | BRO  | A   | 1                                 |
| 11190942000                                       | 12  | 5 / 44.2  | 40  | 5   | 25 / 221.2  | 25  | E52                            | C2  | EE2  | 62:1  | 1.25 / 2.76  | IP53  | PLA  | A   | 1                                 |
| 11191073000                                       | 24  | 1.5 / 13.2  | 240   | 4   | 14 / 123.9  | 23  | E24/E53                        | C26   | EE1  | 49:4  | 1.25 / 2.76  | IP40  | CEL  | C   | 4                                 |
| 11191992000                                       | 12  | 3 / 26.5  | 100   | 6   | 20 / 177.01   | 48  | E67                            | C26   | F3   | 59:2  | 1.25 / 2.76  | IP53  | PLA  | A   | 59                                |
| 11191993000                                       | 24  | 3 / 26.5  | 100   | 3   | 20 / 177.01   | 24  | E67                            | C26   | F3   | 59:2  | 1.25 / 2.76  | IP53  | PLA  | A   | 59                                |

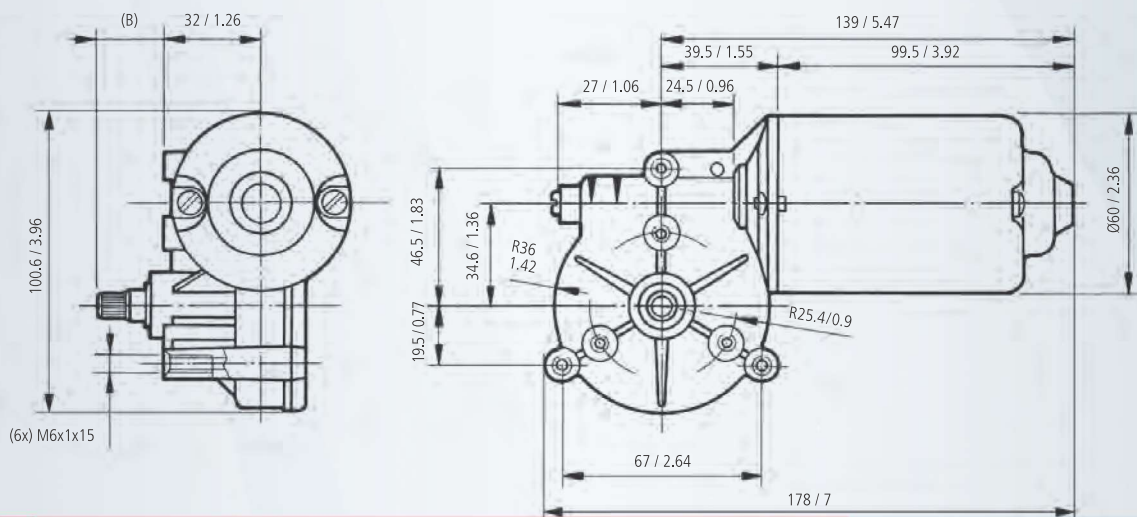

mm / inch

SHAFT EJE ARBRE WELLE

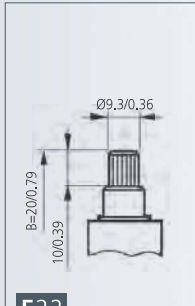

E22

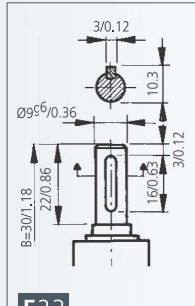

E23

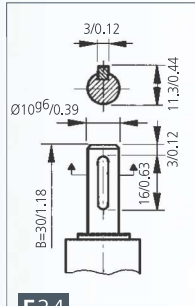

E24

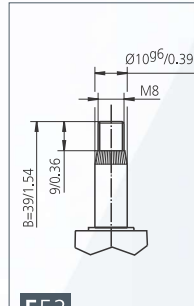

E52

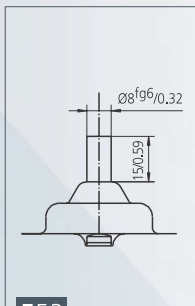

E53

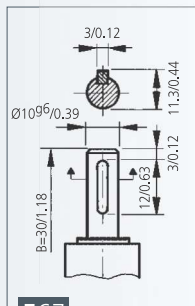

E67

CONNECTIONS CONEXIONES CONNEXIONS ANSCHLUSSART

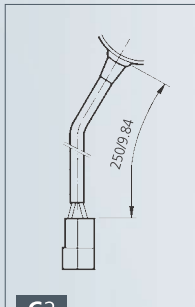

C2

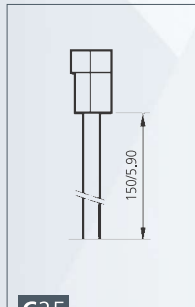

C25

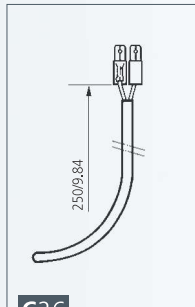

C26

WIRING DIAGRAM ESQUEMA ELÉCTRICO SCHEMA ÉLECTRIQUE SCHALTBILD

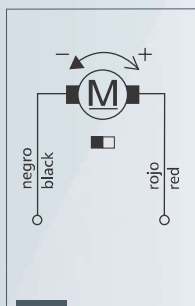

EE1

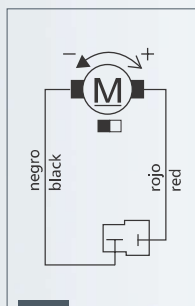

EE2

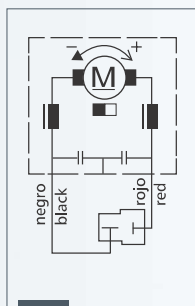

F2

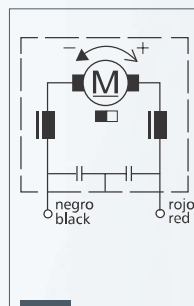

F3

CURVES CURVAS COURBES KURVEN

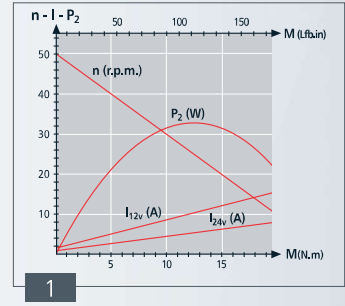

1

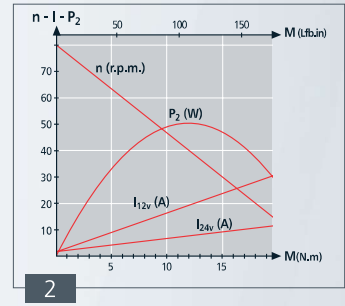

2

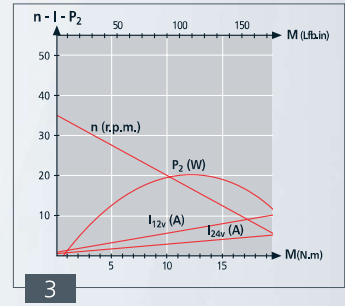

3

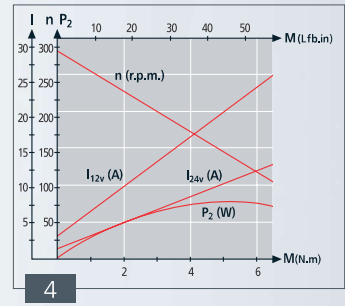

4

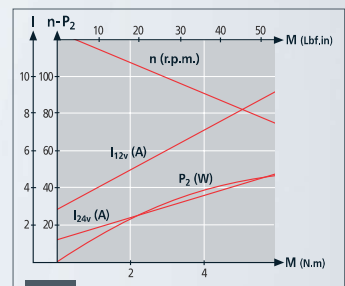

59