

Linear Bearings KB-3-ST5 ISO Series 3, Closed Design

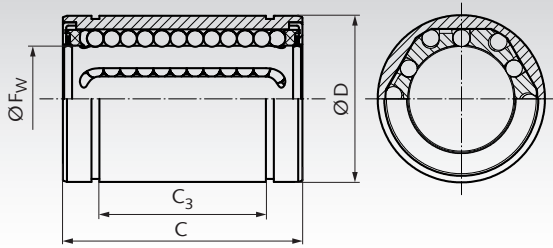

Material: With Steel jacket. Ball cage from steel.

These linear bearings can be fitted inside a customer's housing or as spare parts for our closed units ISO Series 3.

The bearings are greased at the factory. In order to prevent the ingress of dirt and the leakage of lubricant, the linear ball bearings are sealed on both sides.

Recommended shaft tolerance h6, housing tolerance H7.

Ordering Details: e.g.: Product No. 64600806S, Linear Bearing KB-3-ST5, Internal-Ø 8 mm

Product No.	F _w mm	D mm	C mm	C ₃ mm	Load rating		Weight g	Product No. Retaining Ring DIN 471 Page 726	Weight g
					dyn. C N	stat. C ₀ N			
646 008 06S	8	16	25	14,3 ^{-0,2}	350	410	20	617 416 00	0,7
646 010 06S*	10	19	29	19,4 ^{-0,2*}	370	540	30	617 419 00	1,0
646 012 06S	12	22	32	20,3 ^{-0,2}	555	800	40	617 422 00	1,5
646 016 06S	16	26	36	22,3 ^{-0,2}	1045	910	60	617 426 00	2,0
646 020 06S	20	32	45	28,3 ^{-0,2}	1170	1400	90	617 432 00	3,5
646 025 06S	25	40	58	40,4 ^{-0,3}	1330	1600	210	617 440 00	6,0
646 030 06S	30	47	68	48,4 ^{-0,3}	2120	2800	320	617 447 00	7,5
646 040 06S	40	62	80	56,3 ^{-0,3}	2920	4100	700	617 462 00	14,3

* ISO series 5.

Shaft steel, Shaft blocks and Precision housings at www.maedler.de.

Tandem Linear Bearings KBT-ST, Closed, Long Design

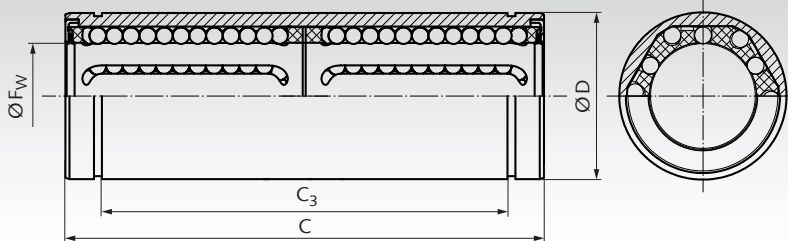

Material: With Steel jacket. Ball cage from plastic.

These linear bearings can be fitted inside a customer's housing. The bearings are greased at the factory. In order to prevent the

ingress of dirt and the leakage of lubricant, the linear ball bearings are sealed on both sides.

Recommended shaft tolerance h6, housing tolerance H7.

Ordering Details: e.g.: Product No. 64600806T, Tandem Linear Bearing KBT-ST, Internal-Ø 8 mm

Product No.	F _w mm	D mm	C mm	C ₃ mm	Load rating		Weight g	Product No. Retaining Ring DIN 471 Page 726	Weight g
					dyn. C N	stat. C ₀ N			
646 008 06T	8	16	46	30,8	421	804	40	617 416 00	0,7
646 012 06T	12	22	61	43,2	813	1570	80	617 422 00	1,5
646 016 06T	16	26	68	47,2	921	1780	115	617 426 00	2,0
646 020 06T	20	32	80	57,8	1370	2740	180	617 432 00	3,5
646 025 06T	25	40	112	78,3	1570	3140	430	617 440 00	6,0
646 030 06T	30	47	123	100,5	2500	5490	615	617 447 00	7,5
646 040 06T	40	62	151	116,9	3420	8040	1400	617 462 00	14,3
646 050 06T	50	75	192	149,9	6080	15900	2320	617 475 00	24,6
646 060 06T	60	90	209	163,7	7550	20000	3920	-	-

Shaft steel and Shaft blocks at www.maedler.de.