

# EAO – Your Expert Partner for Human Machine Interfaces

## 45-2131.1190.000 - Pushbutton actuator, Momentary

### 45-2131.1190.000 - Pushbutton actuator, Momentary



*Attention: The preview is based on a sample product. This can differ from your current configuration.*

#### Mounting

Design raised  
Mounting cut-out Ø 22.5 mm

#### Front

Front shape round  
Front dimension Ø 29.45 mm  
Front ring material Plastic  
Front ring colour black

#### Other Attributes

Weight 0.013 kg

#### Operating-/Indication part

Lens optics opaque  
Lens material Plastic  
Lens colour white  
Lens profile flat / level with front ring

#### IP-Rating

Front protection IP66, IP67, IP69K

#### Actuator

Switching action Momentary  
Housing material Plastic

#### Switching element

max. number of switching elements 6

#### Function

Pushbutton

# EAO – Your Expert Partner for Human Machine Interfaces

45-2131.1190.000 - Pushbutton actuator, Momentary

## Dimensions

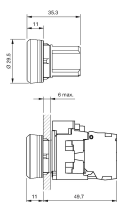

## Mounting cut-outs

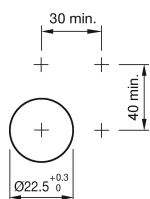

## Wiring diagram



## Legend

Switching action: B = Momentary