

SIGNALLING COLUMN REP.-FLASH LIGHT ELEMENT  
LED YELLOW, 230V AC



Figure similar

**General technical data:**

product brand name		SIRIUS
Product component Light source		Yes
Design of the optical signal		blinklight
Type of voltage of the operating voltage		AC
Operating voltage		
• 1 with AC at 50 Hz Rated value	V	230
• 1 with AC at 60 Hz Rated value	V	230
Equipment marking acc. to DIN EN 61346-2		P

**Mechanical data:**

Outer diameter of the signal column element	mm	70
---	----	----

**Lamp:**

Type of light source		LED
----------------------	--	-----

**Ambient conditions:**

Ambient temperature during operation	°C	-20 ... +50
Protection class IP		IP65
Height	mm	65.5
Width	mm	70

**Certificates/ approvals:**

General Product Approval	EMC	Declaration of Conformity	Shipping Approval
--------------------------	-----	---------------------------	-------------------



Further information

Information- and Downloadcenter (Catalogs, Brochures,...)

<http://www.siemens.com/industrial-controls/catalogs>

Industry Mall (Online ordering system)

<http://www.siemens.com/industrymall>

Cax online generator

<http://support.automation.siemens.com/WW/CAXorder/default.aspx?lang=en&mlfb=8WD44505BD>

Service&Support (Manuals, Certificates, Characteristics, FAQs,...)

<https://support.industry.siemens.com/cs/ww/en/ps/8WD44505BD>

Image database (product images, 2D dimension drawings, 3D models, device circuit diagrams, EPLAN macros, ...)

[http://www.automation.siemens.com/bilddb/cax\\_de.aspx?mlfb=8WD44505BD&lang=en](http://www.automation.siemens.com/bilddb/cax_de.aspx?mlfb=8WD44505BD&lang=en)

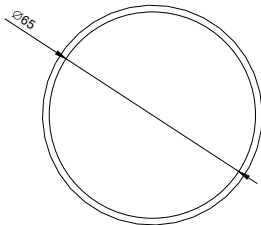
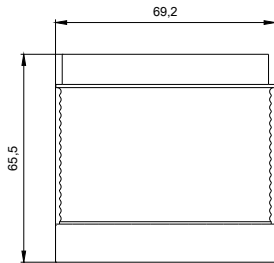

WB:8333: 8WD44... ALL

last modified:

15.01.2015