

About Amphenol Commercial Products

Amphenol's commercial connector products are used in a variety of end user applications including networking, telecom, server & computer, storage & HDD, consumer electronics and entertainment, professional audio & Industrial & Military/Aerospace.

Related Products

RJSSE

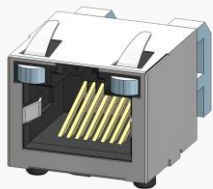

P/N RJSSE-5081 SHOWN SINGLE PORT, 8 POSITION, WITH SHIELD AND LIGHT PIPE

RJULE

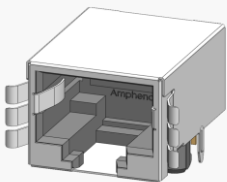

P/N RJULE-4X182-01 SHOWN SINGLE PORT REGULAR MOUNT, STANDARD SHIELD WITH SMT

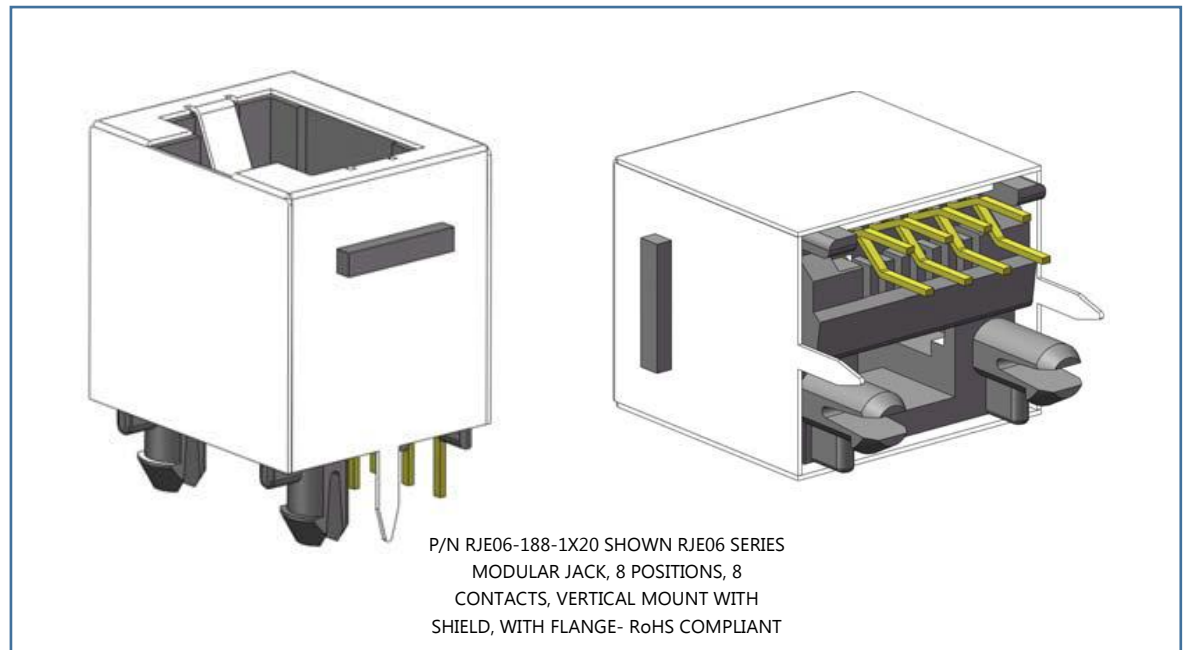

OVERVIEW

This product specification defines the general use and performance parameters for Amphenol's RJE06 series of modular jacks.

Availability: Single port, 6P6C, 8P8C available, flanged and shielding options.

USAGE

The RJE06 series of modular jack supports Ethernet Protocols.

APPLICATIONS

Intended for use in applications such as:

Data

- Storage
- Servers
- Routers
- Switches
- Hubs

Networking & Telecom

- 5G Wireless
- Telephones
- Modems
- Fax Machines

Consumer Goods

- Security Systems
- Set Top Boxes
- Video Game Systems
- PCs, Laptops
- Copiers, Printers

Medical

- Analysis Equipment
- Mass Spectrometers

Industrial and Instrumentation

- Uninterruptible Power Supply (UPS)
- ATMs
- Vending Machines
- POS Terminals
- Industrial IoT Platforms

About Amphenol Commercial Products

Amphenol's commercial connector products are used in a variety of end user applications including networking, telecom, server & computer, storage & HDD, consumer electronics and entertainment, professional audio & Industrial & Military/Aerospace.

Related Products

FRJAE

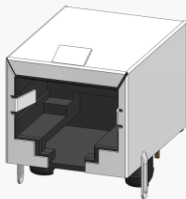

P/N FRJAE-418 SHOWN SINGLE PORT, 8 POSITION, WITH FERRITE FILTER AND SHIELD (FRONT TABS)

RJLSE

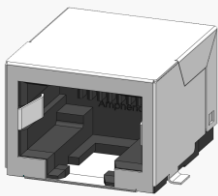

P/N RJLSE-41181-01 SHOWN SINGLE PORT REGULAR MOUNT, STANDARD SHIELD WITH SMT

ELECTRICAL CHARACTERISTICS

Contact Resistance	20 mΩ maximum
Insulation Resistance	500 MΩ minimum at 500V DC for 2 minutes maximum
Current Rating	1.5 Amps per contact
Voltage Rating	125 Volts AC
DWV	Contact to contacts is 1000 VAC, 60 Hz. 1 min

Supports PoE, PoE+, and PoE++ per IEEE PoE standards

IP20 rated per IEC 60529

MECHANICAL CHARACTERISTICS

Mating Connector Insertion Force	5.0 lbs maximum
Mating Connector Pull Retention Force	20.0 lbs minimum
Durability	750 mating and unmating cycles for 50μ" gold plating
Recommended Soldering Temperature	Wave soldering peaked at 260°C for 5 seconds
Operating Temperature	-40°C to +85°C

UL File #: E136228

MATERIAL REQUIREMENTS

RJE06 connectors are RoHS compliant.

Unless otherwise specified, the materials for component shall be:

Insulator	Engineering thermoplastic, complies with UL 94V-0
Contacts	-Phosphor Bronze hard temper with gold thickness options (6μ", 15μ" 30μ", 50μ") over 50μ" minimum Nickel on contact mating area -100μ" minimum matte Tin or gold flash plating on tail area
Shield	Copper alloy, Nickel plating over all

AVAILABLE DOCUMENTS

Below is a list of the most popular standard sales drawings:

Contact our website, sales, or an authorized Amphenol representation for additional drawings.

RJE06-188-0X10	Single port. Vertical mount, unshielded without flange
RJE06-188-1X11	Single port, vertical mount, standard shield without panel stop
RJE06-184-0X10	Single port, vertical mount, unshielded without flange
RJE06-188-1X20	Single port, vertical mount, with shield and flange
RJE06-166-1X10	Single port, vertical mount, with shield

Amphenol Canada Corp.
605 Milner Avenue
Toronto, Ontario, Canada M1B 5X6

www.amphenolcanada.com (www.amphenol-icc.com)
(416) 291-4401
sales@amphenolcanada.com

Copyright © Amphenol Corporation 2018 · All rights reserved

Page 2 of 2

Amphenol