

EAO – Your Expert Partner for Human Machine Interfaces

704.062.718 - Illuminated pushbutton round - Actuator

704.062.718 - Illuminated pushbutton round - Actuator



Attention: The preview is based on a sample product. This can differ from your current configuration.

Attribute

Design	flush
Front dimension	Ø 35 mm
Front form	square
IP front protection	IP65
Mounting cut-out	Ø 30.5 mm
Front bezel surface	anodised
Housing colour	Grey
Housing material	Plastic
Lens colour	Colourless
Lens illumination	illuminative
Lens material	Plastic
Lens optics	transparent
Lens shape	flush
Switching action	Maintained
Terminal	Screw terminal
Weight	0.067 kg
Front bezel colour	Nature
Front bezel material	Aluminium

Schaltelement

max. number of switching elements	3
-----------------------------------	---

Function

Illuminated pushbutton

EAO – Your Expert Partner for Human Machine Interfaces

704.062.718 - Illuminated pushbutton round - Actuator

Dimensions

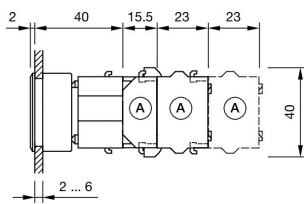

Mounting cut-outs

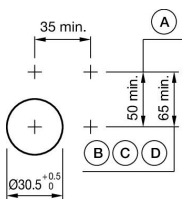

Wiring diagrams

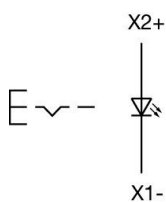

Additional information

Max. 3 switching elements can be clipped on
The lamp block will be delivered with screw terminal
The colour of anodised aluminium parts can vary due to technical production reasons
Max. 3 switching elements can be clipped on
The lamp block will be delivered with screw terminal
The colour of anodised aluminium parts can vary due to technical production reasons