



# AllDisc

## Cellular Antenna

2G / 3G / 4G / 5G / NB-IoT

AllDisc antenna is a 5G ready, low profile antenna with durable design. It is ground plane independent enabling flexible and easy installation. It is the perfect choice for Smart City/metering, EV-charging, M2M applications and load handling. The superior RF performance enables high connectivity and throughput. The AllDisc has been successfully tested for durability according to Volkswagen automotive test standards.

### Features

- Cellular: 698-960MHz, 1710-2690MHz and 3400-3800MHz
- 5G ready
- IP6K9K class
- Cable approved according to ECE-R118
- Designed in Sweden with design registration

### Applications

- Smart City
- Smart Metering
- EV charging poles
- Cargo/load handling
- Wireless broadband
- Public safety

## Specifications

### Electrical

Frequencies	698-960MHz	
	1710-2690MHz	
	3400-3800MHz	
Impedance	50Ω	
Polarization	Vertical	
VSWR (0.5m cable)	698-790MHz	≤ 2:1
	790-880MHz	≤ 2.0:1
	880-960MHz	≤ 2.7:1
	1710-1880MHz	≤ 2.5:1
	1880-2170MHz	≤ 2:1
	2500-2690MHz	≤ 3.0:1
Gain, on ground plane (peak gain, excluding cable)	3400-3800MHz	≤ 3.0:1
	698-960MHz	4.5dBi
	1710-1880MHz	5dBi
	1920-2170MHz	4.5dBi
Gain, on non-conducting material (peak gain, excluding cable)	2500-2690MHz	3.5dBi
	3400-3800MHz	7dBi
	698-880MHz	1dBi
	880-960MHz	1.5dBi
	1710-1880MHz	4dBi
Max power	1920-2170MHz	3dBi
	2500-2690MHz	3dBi
	3400-3800MHz	6.5dBi
	10W	

### Mechanical

Dimensions (D x H)	138 x 55mm	
Installation	Hole mount with center screw	
	Hole dimension Ø19mm	
	Installation thickness ≤ 8.5mm	
	Min. installation radius 2000mm	
Cable	RG316, grey	
	Other cable length upon request	
Connector	SMA-Male, Other connector type upon request	
Weight	~200g	
Material	PC/PBT/Aluminum alloy	
Color	Black, White, Grey (RAL7035)	
IP class	IP6K9K	
Temperature	Storage	-40°C to +85°C
	Operating	-40°C to +85°C

Smarteq, based in Stockholm, Sweden, is a leading developer of antennas and antenna systems for increased availability. Smarteq aims towards the market segments industry, energy and vehicles.

smarteq.com info@smarteq.com +46 8 792 92 00



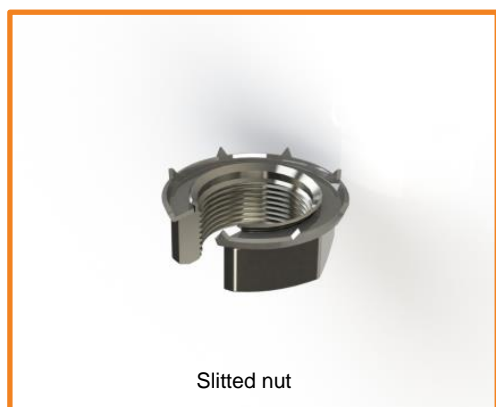

#### Selection of Alldisc Combi versions

Part Number	Color	Cable length	Cable	Connector
710259	Black	0.5m	RG316 grey	SMA-Male
710266	Black	2.5m	RG316 grey	SMA-Male
710542	White	0.5m	RG316 grey	SMA-Male

#### Other

RoHS

REACH compliant

ECE-R118 compliant

#### Accessories

Part number	
710452	Alldisc Bracket White
710598	Slitted nut
710206	Extension nut

#### Extension cables

Part number	Cable LL58	Connector	Gender	Color
201417-1	3m	SMA	Female/Male	White
201417-2	5m	SMA	Female/Male	White
201417-3	10m	SMA	Female/Male	White
201417-7	5m	SMA	Female/Male	Black

Part number	Cable Low Loss	Connector	Gender	Color
707220	3m	SMA	Female/Male	Black
710298	5m	SMA	Female/Male	Black
707222	10m	SMA	Female/Male	Black

Smarteq reserves the right to change specifications without prior notice.