

Gearboxes

Order code	Manufacturer code	Description
37-1196	n/a	SUB MIN EPICYCLIC GEARBOX & MOTOR 4:1 RC
37-1198	n/a	SUB MIN EPICYCLIC GEARBOX&MOTOR 62:1 RC
37-1200	n/a	SUB MIN EPICYCLIC GEARBOX/MOTOR 231:1 RC

Gearboxes	Page 1 of 3
The enclosed information is believed to be correct, Information may change without notice due to product improvement. Users should ensure that the product is suitable for their use. E. & O. E.	Revision A 20/02/2007

Fans & Motors

Fixed Ratio Epicyclic Gearbox and Motors

Manufacturers Code	Description
941D41	Sub miniature 4:1
941D621	Sub miniature 62:1
941D2311	Sub miniature 231:1

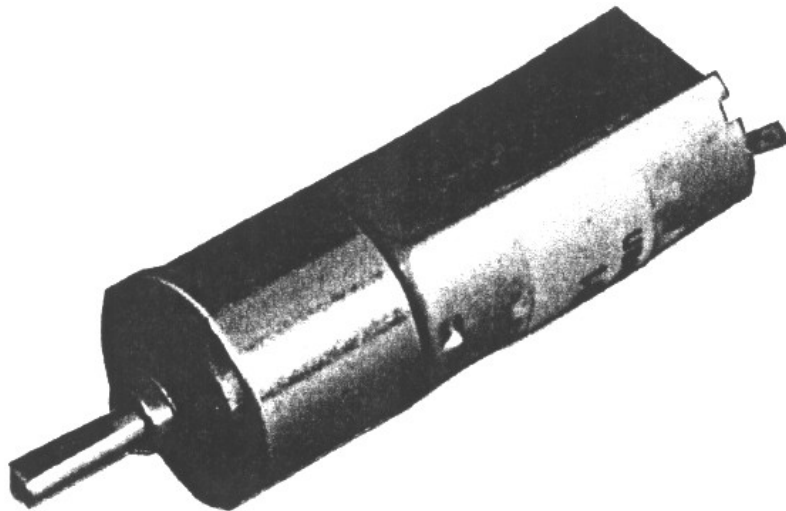

941D Series Planetary (Epicyclic) Sub Miniature Metal Gearbox

Designed for heavy-duty industrial and model applications this robust unit boasts a powerful high quality, five-pole motor with sintered bronze bearings. The all-metal gearbox incorporated bronze output bearings, enabling the high torque transfer from the motor to be transmitter through the gearbox.

Motor Data

Model	Voltage		No Load		At Maximum Efficiency						Stall Torque	
	Operating range	Nominal	Speed	Current	Speed	Current	Torque		Output	Eff	-	G-cm
			R.P.M	mA	-	-	-	-	-	-		
941D	1.5 – 12.0	12.0V Constant	8000	19	-	-	-	-	-	-	-	26

Reduction Table R.P.M

Supply Voltage	1.5V	3.0V	6.0V	9.0V	12.0V
941D41	250	500	1000	1500	2000
941D621	16	32	65	98	130
941D2311	4	9	18	27	35

Weight	
941D41	37g
941D621	45g
941D2311	49g

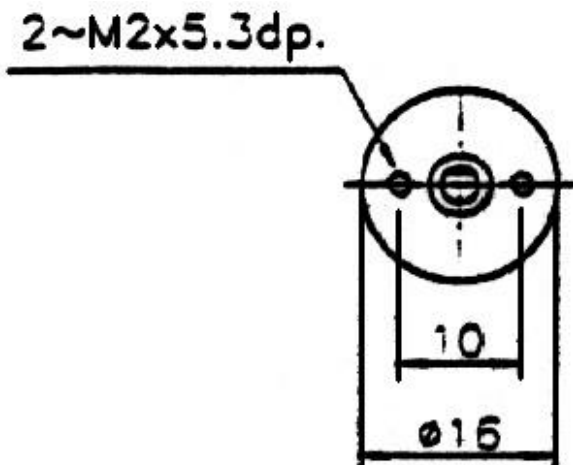

Gearbox Ref.	L
941D41	15.0
941D621	22.2
941D2311	25.8

