

# EAO – Your Expert Partner for Human Machine Interfaces

## 704.012.418 - Pushbutton round - Actuator

### 704.012.418 - Pushbutton round - Actuator



*Attention: The preview is based on a sample product. This can differ from your current configuration.*

#### Attribute

Design	flush
Front dimension	Ø 35 mm
Front form	round
IP front protection	IP65
Mounting cut-out	Ø 30.5 mm
Front bezel colour	Nature
Front bezel material	Aluminium
Front bezel surface	anodised
Housing colour	Grey
Housing material	Plastic
Lens colour	Yellow
Lens illumination	non illuminative
Lens material	Plastic
Lens optics	transparent
Lens shape	flush
Switching action	Momentary
Weight	0.051 kg

#### Schaltelement

max. number of switching elements	3
-----------------------------------	---

#### Function

Pushbutton

# EAO – Your Expert Partner for Human Machine Interfaces

704.012.418 - Pushbutton round - Actuator

## Dimensions

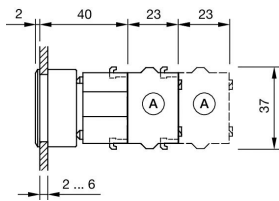

## Mounting cut-outs

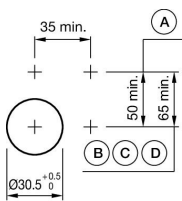

## Wiring diagrams

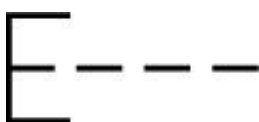

## Additional information

Max. 3 switching elements can be clipped on  
The colour of anodised aluminium parts can vary due to technical production reasons  
Max. 3 switching elements can be clipped on  
The colour of anodised aluminium parts can vary due to technical production reasons