

Swivel plate non machined

Swivel plate, not machined, for RÖHM MSR machine vices



Application:

For milling machines and machining centres.

Execution:

- Made of alloyed steel.
- Hardened (60 HRC) and polished guides.
- Clamping repeatability: 0.02 mm.
- Clamping repeatability: 0.02 mm.
- Rigging pins can be used for rough adjustment of the clamping range.
- 4 adjustable clamps are required for optimal clamping.

Delivery:

1x swivel plate; spanner and workpiece stop

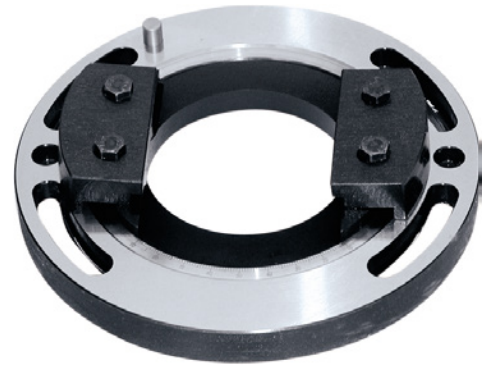

Art. no.	28721 120
Brand	RÖHM
Manufacturer Part Number	476867
Rotating plate diameter	226 mm
Turntable height	23 mm
Aperture	95 mm
Clamping shoe height	47 mm
Gross Weight	5.671 kg
Product Group	203

EAN

4019208192215