



**Part no.: 50135196**  
**MD 708-21-42/D4-12**  
**Ethernet switch**



Figure can vary

## Contents

- Technical data
- Dimensioned drawings
- Electrical connection
- Operation and display
- Accessories

## Technical data

<b>Basic data</b>	
Suitable for	Ethernet
<b>Functions</b>	
Functions	Autocrossing Autonegotiation Full duplex Unmanaged
<b>Electrical data</b>	
<b>Performance data</b>	
Supply voltage $U_B$	18 ... 30 V , DC , Redundant
<b>Interface</b>	
Type	Ethernet
<b>Ethernet</b>	
Address assignment	None
Transmission speed	10 / 100 Mbit/s
Switch functionality	Integrated
<b>Connection</b>	
Number of connections	5 Piece(s)
Connections for voltage supply	1 Piece(s)
Number of interface connections	4 Piece(s)
<b>Connection 1</b>	
Type of connection	Connector
Function	Voltage supply
Thread size	M12
Type	Male
Material	Metal
No. of pins	5 -pin
Encoding	A-coded
<b>Connection 2</b>	
Type of connection	Connector
Function	Data interface
Thread size	M12
Type	Female
Material	Metal
No. of pins	4 -pin
Encoding	D-coded
<b>Connection 3</b>	
Type of connection	Connector
Function	Data interface
Thread size	M12
Type	Female
Material	Metal
No. of pins	4 -pin
Encoding	D-coded

**Connection 4**

Type of connection	Connector
Function	Data interface
Thread size	M12
Type	Female
Material	Metal
No. of pins	4 -pin
Encoding	D-coded

**Connection 5**

Type of connection	Connector
Function	Data interface
Thread size	M12
Type	Female
Material	Metal
No. of pins	4 -pin
Encoding	D-coded

**Mechanical data**

Dimension (W x H x L)	55 mm x 21 mm x 95 mm
Housing material	Metal
Net weight	335 g

**Environmental data**

Ambient temperature, operation	-25 ... 60 °C
Ambient temperature, storage	-40 ... 80 °C

**Certifications**

Degree of protection	IP 67
Certifications	c UL US

**Classification**

Customs tariff number	85176200
eCl@ss 8.0	19170106
eCl@ss 9.0	19170106
ETIM 5.0	EC000734
ETIM 6.0	EC000734

## Dimensioned drawings

All dimensions in millimeters

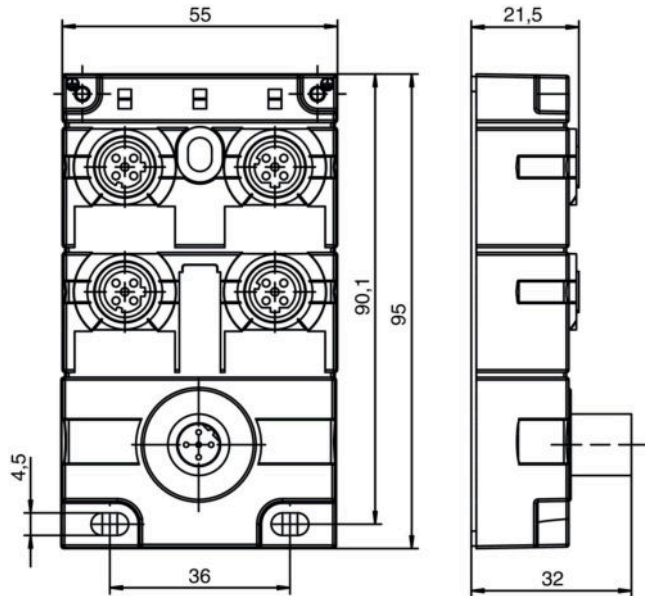

## Electrical connection

Connection 1	
Type of connection	Connector
Function	Voltage supply
Thread size	M12
Type	Male
Material	Metal
No. of pins	5 -pin
Encoding	A-coded

Pin	Pin assignment
1	+24 V DC
2	+24 V DC
3	0 V DC
4	0 V DC
5	GND / Ground

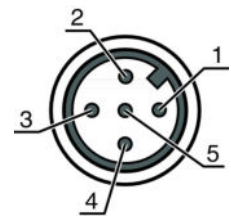

Connection 2	
Type of connection	0
Type of connection	Connector
Function	Data interface
Thread size	M12
Type	Female
Material	Metal
No. of pins	4 -pin
Encoding	D-coded

**Part no.: 50135196 – MD 708-21-42/D4-12 – Ethernet switch**

Pin	Pin assignment
1	Tx+
2	Rx+
3	Tx-
4	Rx-

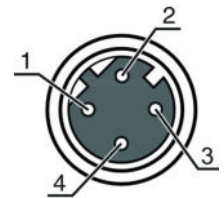

Connection 3	1
Type of connection	Connector
Function	Data interface
Thread size	M12
Type	Female
Material	Metal
No. of pins	4 -pin
Encoding	D-coded

Pin	Pin assignment
1	Tx+
2	Rx+
3	Tx-
4	Rx-

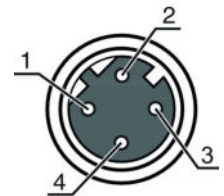

Connection 4	2
Type of connection	Connector
Function	Data interface
Thread size	M12
Type	Female
Material	Metal
No. of pins	4 -pin
Encoding	D-coded

Pin	Pin assignment
1	Tx+
2	Rx+
3	Tx-
4	Rx-

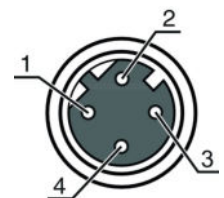

Connection 5	3
Type of connection	Connector
Function	Data interface
Thread size	M12
Type	Female
Material	Metal
No. of pins	4 -pin
Encoding	D-coded

Pin	Pin assignment
1	Tx+
2	Rx+
3	Tx-
4	Rx-

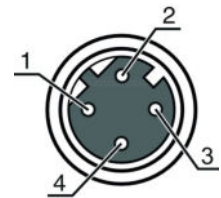



## Operation and display

### LEDs

LED	Display	Meaning	
1	UB1	Green, continuous light	Voltage supply OK
		Red, continuous light	Undervoltage < 17 V
2	UB2	Green, continuous light	Voltage supply OK
		Red, continuous light	Undervoltage < 17 V
3	0 to 3	Green, continuous light	100 Mbit/s
		Yellow, continuous light	10 Mbit/s
		Green, flashing	Data exchange active
		Yellow, flashing	Data exchange active

## Accessories

### Connection technology - Connection cables

	Part no.	Designation	Article	Description
	50130726	KD S-M12-4A-P1-050	Connection cable	Connection 1: Connector, M12, Axial, Female, A-coded, 4 -pin Connection 2: Open end Shielded: Yes Cable length: 5,000 mm Sheathing material: PUR
	50130729	KD S-M12-4W-P1-050	Connection cable	Connection 1: Connector, M12, Angled, Female, A-coded, 4 -pin Connection 2: Open end Shielded: Yes Cable length: 5,000 mm Sheathing material: PUR

### Connection technology - Interconnection cables

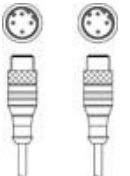
	Part no.	Designation	Article	Description
	50137078	KSS ET-M12-4A-M12-4A-P7-050	Interconnection cable	Suitable for interface: Ethernet Connection 1: Connector, M12, Axial, Male, D-coded, 4 -pin Connection 2: Connector, M12, Axial, Male, D-coded, 4 -pin Shielded: Yes Cable length: 1,000 mm Sheathing material: PUR

Part no.: 50135196 – MD 708-21-42/D4-12 – Ethernet switch

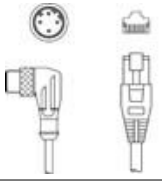
	Part no.	Designation	Article	Description
	50136183	KSS ET-M12-4W-RJ45-A-P7-050	Interconnection cable	Suitable for interface: Ethernet Connection 1: Connector, M12, Angled, Male, D-coded, 4 -pin Connection 2: RJ45 Shielded: Yes Cable length: 5,000 mm Sheathing material: PUR

**Note**

A list with all available accessories can be found on the Leuze electronic website in the Download tab of the article detailed page.