



# HID-PrimaVision CDM

HID-PV C 150 /S CDM 220-240V 50/60Hz

Compact, lightweight and easy to use high performance range of electronic gears for optimal performance of 35W, 70W, 100W and 150W CDM lamps

## Product data

### • General Characteristics

Rated Number of Lamps	1 piece
Rated Ballast-Lamp Power	150
Rated Lamptype	CDM
Line Voltage	220-240 V
Line Frequency	50/60 Hz
Housing	/S
Suitable for Outdoor use?	No

### • Operating Characteristics

Automatic restart	Yes
Constant wattage deviation	-3%/+3%
Inrush current Peak	50 (max) A
Inrush current Width	.50 ms
Max ballast on MCB(16A type B)	6 x
Mains voltage safety (AC)	-18%/+10%
Mains voltage performance (AC)	-10%/+6%
Operating frequency *	0.14 kHz
Overvoltage protection 320Vac	48 hr
PowerFactor 100% output power	0.95 -
Ignition switch-off time	20 min
Ignition Voltage	5.0 (max) kV
Hum and Noise level	Inaudible

### • Wiring Characteristics

Cable-Cap output-wires mutual	200 pF
Connector type	Insert
Max. cable length	2.0 m
Device/Lamp Striplength	10.0-11.0 mm
Wcs Ballast contacts	0.50-2.50 mm <sup>2</sup>

### • Temperature Characteristics

Active temperature protection	Yes
F-marking	Yes
T-case life	75 C
T-case maximum	85 (max) C
T-ambient	-20 (min), 60 (max) C
T-storage	-25 (min), 85 (max) C

### • Approval & Application Chars

EMI 9 kHz ... 300MHz	CISPR 15 ed 7.2
Vibrations	IEC 60068-2-6 Fc
Bumps	IEC 60068-2-29 Eb
CE marking	Yes
ENEC certificate	No
VDE certificate	Yes
VDE-EMV certificate	Yes
CB Certificate	Yes

### • Product Dimensions

Length A1	135.0 mm
Width B1	75.0 mm
Height C1	32.0 mm
Fixing Hole Diameter D1	4.8 mm



asimpleswitch.com

# PHILIPS

sense and simplicity

• Product Data

Order code 913700614066  
 Full product code 913700614066  
 Full product name HID-PV C 150 /S CDM 220-240V 50/60Hz  
 Order product name HID-PV C 150 /S CDM 220-240V 50/60Hz  
 Pieces per pack 1

Packing configuration 12  
 Packs per outerbox 12  
 Bar code on pack - EAN1 8711500910523  
 Bar code on outerbox - EAN3 8711500910530  
 Logistic code(s) - 12NC 913700614066  
 Net weight per piece 0.360 kg

Dimensional drawing

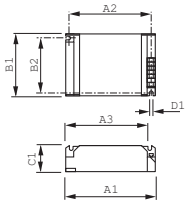

Product	A1 (Norm)	A2 (Norm)	A3 (Norm)	A4 (Norm)	B1 (Norm)	B2 (Norm)	B3 (Norm)	C1 (Norm)	D1 (Norm)	F1 (Norm)
HID-PV C 150 /S CDM 220-240V 50/60Hz	135.0	-	-	-	75.0	-	-	32.0	4.8	-

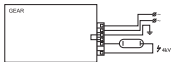

© 2011 Koninklijke Philips Electronics N.V.  
 All rights reserved.

Specifications are subject to change without notice. Trademarks are the property of Koninklijke Philips Electronics N.V. or their respective owners.

[www.philips.com/lighting](http://www.philips.com/lighting)

2011, May 14  
 data subject to change