

Fixed Diameter Cable Clamps

• Durable Nylon 6.6 cable clamps

• Fully radiused edges



Part Number	Max. Bundle Dia.		Width		Bundle Offset		Mounting Method	Std. Pkg. Qty.	Std. Ctn. Qty.
	In.	mm	In.	mm	In.	mm			
CCS12-S8-C	.12	3.1	.37	9.4	.33	8.4	#8 (M4) Screw	100	500
CCS19-S8-C	.19	4.8	.37	9.4	.43	10.9	#8 (M4) Screw	100	500
CCS25-S8-C	.25	6.3	.37	9.4	.41	10.4	#8 (M4) Screw	100	500
CCS25-S10-C	.25	6.3	.37	9.4	.41	10.4	#10 (M5) Screw	100	500
CCS31-S8-C	.31	7.9	.37	9.4	.49	12.4	#8 (M4) Screw	100	500
CCS38-S8-C	.38	9.5	.37	9.4	.59	15.0	#8 (M4) Screw	100	500
CCS44-S8-C	.44	11.1	.37	9.4	.57	14.5	#8 (M4) Screw	100	500
CCS50-S8-C	.50	12.7	.37	9.4	.60	15.2	#8 (M4) Screw	100	500
CCH12-S10-C	.12	3.1	.50	12.7	.36	9.1	#10 (M5) Screw	100	500
CCH19-S10-C	.19	4.8	.50	12.7	.42	10.7	#10 (M5) Screw	100	500
CCH25-S10-C	.25	6.3	.50	12.7	.46	11.7	#10 (M5) Screw	100	500
CCH31-S10-C	.31	7.9	.50	12.7	.50	12.7	#10 (M5) Screw	100	500
CCH38-S10-C	.38	9.5	.50	12.7	.53	13.5	#10 (M5) Screw	100	500
CCH44-S10-C	.44	11.1	.50	12.7	.56	14.2	#10 (M5) Screw	100	500
CCH50-S10-C	.50	12.7	.50	12.7	.59	15.0	#10 (M5) Screw	100	500
CCH56-S10-C	.56	14.2	.50	12.7	.61	15.5	#10 (M5) Screw	100	500
CCH62-S10-C	.62	15.7	.50	12.7	.65	16.5	#10 (M5) Screw	100	500
CCH69-S10-C	.69	17.5	.50	12.7	.75	19.1	#10 (M5) Screw	100	500
CCH75-S10-C	.75	19.1	.50	12.7	.78	19.8	#10 (M5) Screw	100	500
CCH81-S10-C	.81	20.6	.50	12.7	.81	20.6	#10 (M5) Screw	100	500
CCH87-S10-C	.87	22.1	.50	12.7	.84	21.3	#10 (M5) Screw	100	500
CCH100-S10-C	1.00	25.4	.50	12.7	.91	23.1	#10 (M5) Screw	100	500
CCH112-S10-C	1.12	28.4	.50	12.7	.97	24.6	#10 (M5) Screw	100	500
CCH119-S10-C	1.19	30.2	.50	12.7	1.00	25.4	#10 (M5) Screw	100	500
CCH125-S10-C	1.25	31.8	.50	12.7	1.06	26.9	#10 (M5) Screw	100	500
CCH138-S10-C	1.37	34.8	.50	12.7	1.12	28.4	#10 (M5) Screw	100	500
CCH150-S10-C	1.50	38.1	.50	12.7	1.19	30.2	#10 (M5) Screw	100	500

All parts listed are also available in black weather resistant material (add suffix 0). Bulk package only.

A.
System
Overview

Fixed Diameter Cable Clamps

B1.
Cable Ties

- Durable Nylon 6.6 cable clamps



B2.
Cable
Accessories

B3.
Stainless
Steel Ties

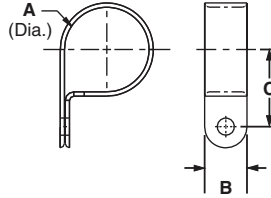

C1.
Wiring
Duct

C2.
Surface
Raceway

C3.
Abrasion
Protection

C4.
Cable
Management

D1.
Terminals

D2.
Power
Connectors

D3.
Grounding
Connectors

E1.
Labeling
Systems

E2.
Labels

E3.
Pre-Printed
& Write-On
Markers

E4.
Permanent
Identification

E5.
Lockout/
Tagout
& Safety
Solutions

F.
Index

Part Number	Max. Bundle Diameter A		Width B		Bundle Offset C		Mounting Method	Std. Pkg. Qty	Std. Ctn. Qty.
	In.	mm	In.	mm	In.	mm			
CCS12-S8-C	.12	3.1	.37	9.4	.33	8.4	#8 (M4) Screw	100	500
CCS19-S8-C	.19	4.8	.37	9.4	.43	10.9	#8 (M4) Screw	100	500
CCS25-S8-C	.25	6.3	.37	9.4	.41	10.4	#8 (M4) Screw	100	500
CCS25-S10-C	.25	6.3	.37	9.4	.41	10.4	#10 (M5) Screw	100	500
CCS31-S8-C	.31	7.9	.37	9.4	.49	12.4	#8 (M4) Screw	100	500
CCS38-S8-C	.38	9.5	.37	9.4	.59	15.0		100	500
CCS44-S8-C	.44	11.1	.37	9.4	.57	14.5		100	500
CCS50-S8-C	.50	12.7	.37	9.4	.60	15.2		100	500
CCH12-S10-C	.12	3.1	.50	12.7	.36	9.1	#10 (M5) Screw	100	500
CCH19-S10-C	.19	4.8	.50	12.7	.42	10.7		100	500
CCH25-S10-C	.25	6.3	.50	12.7	.46	11.7		100	500
CCH31-S10-C	.31	7.9	.50	12.7	.50	12.7		100	500
CCH38-S10-C	.38	9.5	.50	12.7	.53	13.5		100	500
CCH44-S10-C	.44	11.1	.50	12.7	.56	14.2		100	500
CCH50-S10-C	.50	12.7	.50	12.7	.59	15.0		100	500
CCH56-S10-C	.56	14.2	.50	12.7	.61	15.5		100	500
CCH62-S10-C	.62	15.7	.50	12.7	.65	16.5		100	500
CCH69-S10-C	.69	17.5	.50	12.7	.75	19.1		100	500
CCH75-S10-C	.75	19.1	.50	12.7	.78	19.8		100	500
CCH81-S10-C	.81	20.6	.50	12.7	.81	20.6		100	500
CCH87-S10-C	.87	22.1	.50	12.7	.84	21.3		100	500
CCH100-S10-C	1.00	25.4	.50	12.7	.91	23.1		100	500
CCH112-S10-C	1.12	28.4	.50	12.7	.97	24.6		100	500
CCH119-S10-C	1.19	30.2	.50	12.7	1.00	25.4	100	500	
CCH125-S10-C	1.25	31.8	.50	12.7	1.06	26.9	100	500	
CCH138-S10-C	1.37	34.8	.50	12.7	1.12	28.4	100	500	
CCH150-S10-C	1.50	38.1	.50	12.7	1.19	30.2	100	500	

All parts listed are also available in black weather resistant material (add suffix 0). Bulk package only.