

freeVoice

# CURVED SCREEN LAMP USER MANUAL



**LED DIMMABLE  
SCREEN LAMP**  
With eye Protection

MODEL: FWP-SB-009



ANTI-GLARE

EYE PROTECTED

NO MULTI-SHADOW

SERVICE LIFE: 25000H

## PARTS & DESCRIPTION

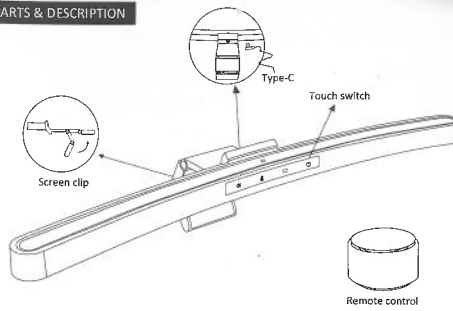

## SPECIFICATION

MODEL	POWER	LUMEN	CRI	INPUT	SIZE
FWP-SB-009	5W	275LM	RA>95	5V 1A type-c	45cm

## APPLICABLE SCENE

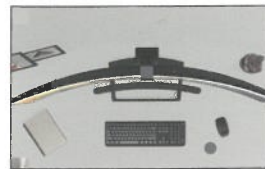

- DESKTOP
- DESKTOP COMPUTER
- LAPTOP COMPUTER
- CURVED SCREEN
- etc.

1

## INSTRUCTIONS FOR KEYS

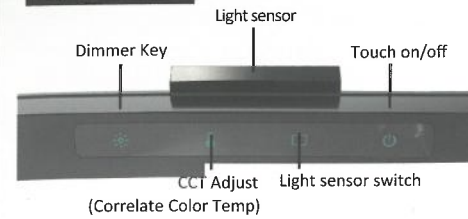

- ⏻ On/off:** short touch once to on/off the lamp, with memory function. Long press the button for 3 seconds, the light will flash once and a 2-hour timer will be set. During this time, if long press the button for 3 seconds once again, the light will flash again and 2-hour timer will be reset.
  - 📷 Light sensor switch:** short touch once to adjust the light automatically according to the environment lighting. The indicator light will be green when the sensor is working.

    1. Short touch once to turn on/off the function
    2. The light will lighten/dim with the surrounding environment when the light sensor is ON
    3. If you want to stop this function, there are 2 methods:
      - Touch the function button
      - Touch the dimmable button
  - ⚙️ CCT change:** 4 levels to control the color temperature: 3000K-4000K-5000K-6500K. Long touch can stepless adjust color temperature.
  - ☼ Dimmable:** 5 levels to adjust brightness: 5%-10%-25%-60%-100%. Long touch can stepless dimmable.
- Memory function:**
1. Lamp will remember the last settings when turn on again.
  2. Lamp will automatically on after connecting the power supply if the power was directly cut off without turning off switch last time

2

## SUITABLE FOR ALL KINDS OF COMPUTERS

### 1. Suitable for curved screen



Curved surface screen

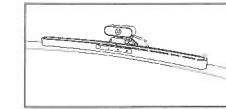

Camera placement

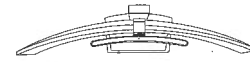

Curved screen (top view)



Curved screens (1000R-1800R)

### 2. Applicable to a variety of screens



Thin screen

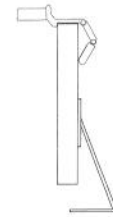

Thick screen

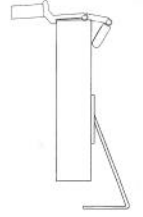

Super thick screen

3

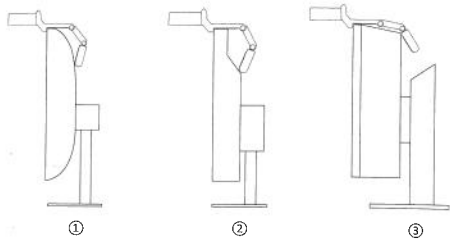

Irregular screens

**HOW TO MOUNT THE REMOTE CONTROL**

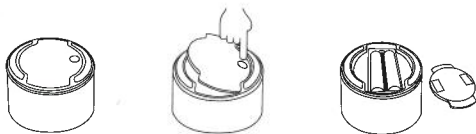

1. The battery box is at the bottom of the remote control. Turn the bottom of the battery box upward.
2. Press the circular depression at the bottom, the battery cover will pop up.
3. Insert the battery according to the positive and negative poles.
4. Put the battery cover back to bottom of remote control.

**FUNCTION DIAGRAM OF REMOTE CONTROL**

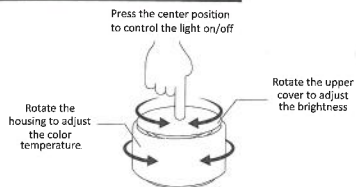

**HOW TO USE THE REMOTE CONTROL**

1. Turn on/off: short press center position once
2. 2-hour timer: long press the center position for 5 seconds, the light flash once, then turn on the 2-hour timer.
2. Adjust brightness: rotate the upper cover plate clockwise rota on: light up counterclockwise rota on: light dims
3. adjust color temperature (3000k-6500k): rotate the housing clockwise rota on: 6500K cold light counterclockwise rota on: 3000K warm light
4. Automatic light sensor function: short press twice, the small indica on light turns green, this function will start working: Environment turns bright, the lamp turns dark gradually; Environment turns dark, the lamp turns bright gradually. Short press the remote control for twice(or rotatethe upper cover plate), the blue indicator light will turn off, this function will also turn off.

**CODE SETTING**

The remote control will need to be re-coded after batteries were properly installed or replaced. Please refer to steps below:

1. Connect the light to power, and long press the center position within 5 seconds, meanwhile rotate the housing clockwise or counterclockwise
2. If the light flashes, the code was successfully matched.



**USAGE SCENARIO**

**USING 1**



**USING 2**



**UMINANCE PARAMETER**

WORKING HEIGHT	ILLUMINANCE ( LUX )			
	6500K COOL LIGHT	5000K DAY LIGHT	4000K NEUTRAL LIGHT	3000K WARM LIGHT
30CM	1850LUX	1835LUX	1800LUX	1345LUX
40CM	1200LUX	1100LUX	1008LUX	825LUX
45CM	820LUX	750LUX	705LUX	575LUX
50CM	725LUX	625LUX	598LUX	510LUX

**HOW TO LIGHT**

**NO GLARE , GOOD FOR EYES!**

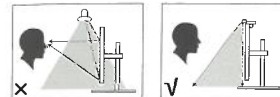

1. Ordinary light source on the screen then reflects to eyes and causing damage for eyes.
2. The screen lamp only light the table not the screen, so there'no glare to harm eyes.

**PARTS LIST**

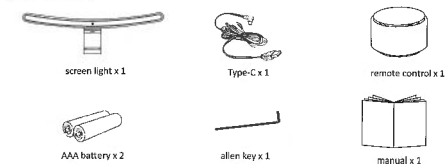

**NOTE**

The allen key is only used for adjust the screen clip. If the clip is too loose, please ghten it. If the screen clip is too tight, please loose the screw instead of removing it. If you don't need to adjust, please skip these steps.

Step 1: take off the cover on the screen clip

Step 2: use the allen key to the screw.

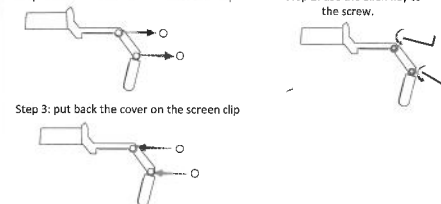

Step 3: put back the cover on the screen clip