

Basic series

4 mm not embeddable

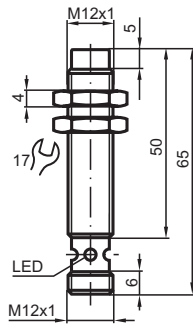

Switching element function	PNP	Make function
Rated operating distance s_n	4 mm	
Installation	not embeddable	
Assured operating distance s_a	0 ... 3,24 mm	
Reduction factor r_{AI}	0,5	
Reduction factor r_{Cu}	0,4	
Reduction factor r_{V2A}	0,8	
Operating voltage U_B	10 ... 30 V	
Switching frequency f	0 ... 1200 Hz	
Reverse polarity protection	yes	
Short circuit protection	pulsing	
Voltage drop U_d	≤ 3 V	
Operating current I_L	0 ... 200 mA	
Off-state current I_r	0 ... 0,5 mA typ.	
No-load supply current I_0	≤ 17 mA	
Indication of the switching state	ring LED, yellow	
Standards	EN 60947-5-2	
Ambient temperature	-25 ... 70 °C (248 ... 343 K)	
Connection type	V1-connector	
Core cross-section	-	
Housing material	brass, nickel-plated	
Sensing face	PBT	
Protection degree	IP67	

Connection_type:

E2

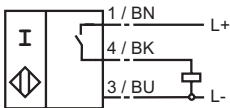

087768_ENG.xml

2003-03-24

www.pepperl-fuchs.com

PEPPERL+FUCHS GmbH