

THE INFORMATION CONTAINED IN THIS DRAWING IS THE SOLE PROPERTY OF L-COM, INC. ANY REPRODUCTION IN PART OR WHOLE WITHOUT THE WRITTEN PERMISSION OF L-COM, INC. IS PROHIBITED.

REVISIONS			
REV	DESCRIPTION	DATE	APPROVED
A	INITIAL RELEASE	4/26/12	D.GRIFFIN

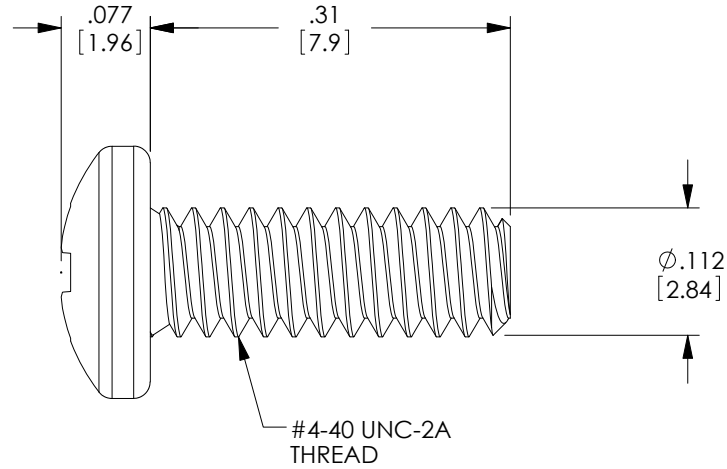
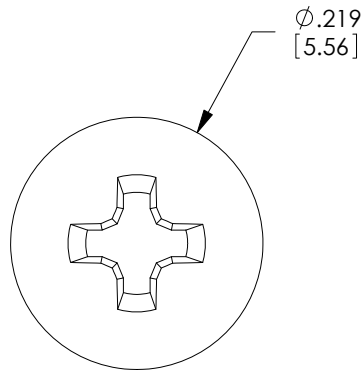

NOTES:

MATERIAL: STEEL  
FINISH: ZINC PLATED

COMPONENT SHALL BE PACKAGED IN BULK IN QUANTITIES OF 100.

UNLESS OTHERWISE SPECIFIED, DIMENSIONS ARE IN INCHES [mm] OVERALL CABLE LENGTH TOLERANCE: ≤12 [305] = +1 [25] / -0 >12 [305] ≤60 [1524] = +2 [51] / -0 >60 [1524] ≤120 [3048] = +4 [102] / -0 >120 [3048] ≤300 [7620] = +6 [152] / -0 >300 [7620] = +3% / -0% ALL OTHER DIMENSIONAL TOLERANCES: .X = ± .2 .XX = ± .02 .XXX = ±.005	APPROVALS DRAWN BY D.FRISIELLO	DATE 4/26/12		45 BEECHWOOD DRIVE NORTH ANDOVER, MA 01845			
	CHECKED BY D.DESJARDIN APPROVED BY D.FRISIELLO	DATE 4/26/12		CATEGORY HARDWARE			
PROJECTION 	CONFIGURATION DETAILS OF UNDIMENSIONED FEATURES MAY VARY	COLOR VARIATIONS MAY OCCUR	PRODUCT DESCRIPTION SCREW MACH 4-40 PAN HD PHILLIPS ZINC PLT	SIZE <b>A</b>	FSCM NO. <b>43321</b>	DWG. NO. <b>ECF440</b>	REV. <b>A</b>
SCALE: NONE			CAD FILE: ECF440.SLDDRW		SHEET 1 OF 1		