

Copy and face milling cutter heads with thread

For milling cutter indexable inserts RD..0501., RD..0702., RD..12T3..

ATORN[®]

Application

For face milling and copy milling, light and medium chipping

Version

- Wear-resistant, nickel-plated version
- With internal cooling
- Clamping screw tightening torque (indexable insert) M1.8 = 0.7 Nm, M2.5 = 1.2 Nm, M3.5 = 3.5 Nm

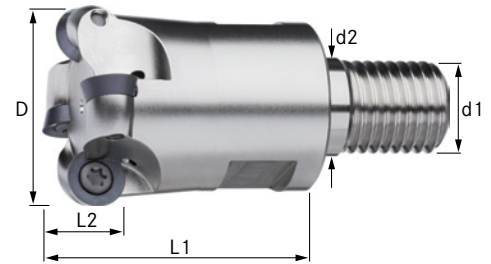

Art. No.	16035 236
Max. cutting edge diameter	35 mm
Clearance length	43 mm
Thread dimension	M16
max. ap	2.5 mm
Number of cutting edges	4 PCS
Suitable indexable insert no.	32

EAN-Code

4050293320244