

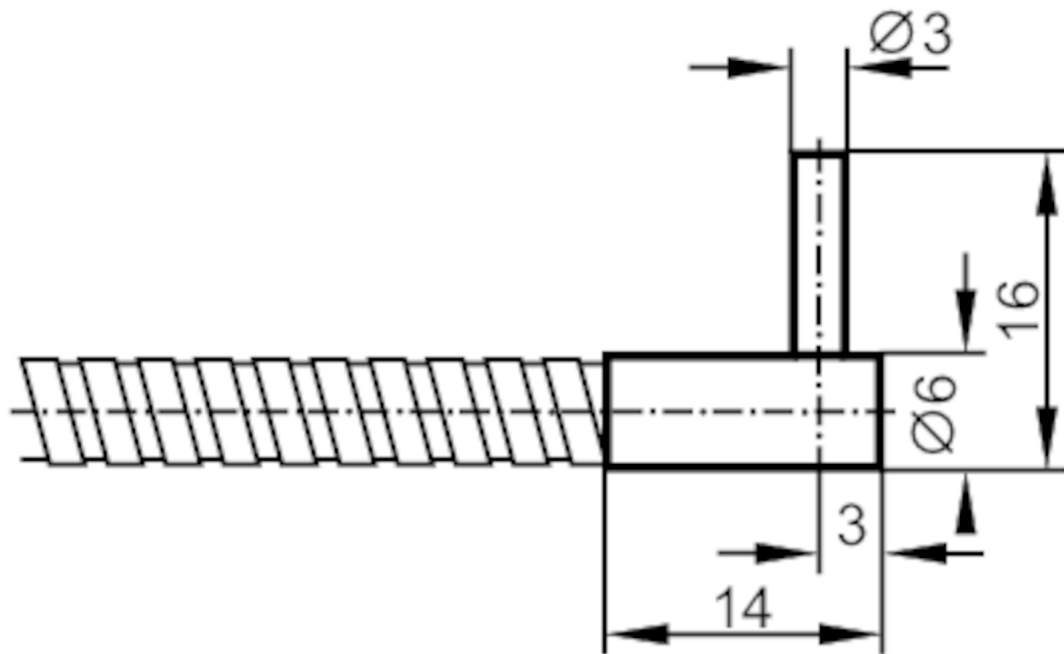

Fibre optic through beam sensor

FE-00-A-A-R3



Application

Function principle Through-beam sensor

Detection zone

Range with fibre optic amplifier type OKF; OUF; OOF

OKF

Range of fibre optics [mm] 120

OOF

Range of fibre optics [mm] 400

OUF

Range of fibre optics [mm] 120

Operating conditions

Ambient temperature [°C] -40...290

E20129



Fibre optic through beam sensor

FE-00-A-A-R3

Mechanical data	
Weight [g]	69.5
Version of sensing head	angled
Sensing head diameter [mm]	3
Sensing head length [mm]	10
Total length [mm]	600
Min. bending radius [mm]	20; (for fixed installation)
Fibre arrangement	
Materials	Adapter: ABS
Fibre material	glass
Fibre head material	aluminium
Fibre sheath material	aluminium
Accessories	
Accessories (supplied)	E20103
Remarks	
Pack quantity	1 pcs.