

# EAO – Your Expert Partner for Human Machine Interfaces

82-6151.2000.B002 - Pushbutton 22 mm Stand-By Symbol

## 82-6151.2000.B002- Pushbutton 22mm stainless-steel



### Mounting

Mounting cut-out Ø 22,3 mm  
Design flush

### Front

Front dimension Ø 25 mm  
Front shape round  
Front ring shape flush  
Front bezel material Stainless steel

### Other Attributes

Weight 0,018 kg

### Operating-/Indication part

Lens optics opaque  
Lens material Stainless steel  
Lens colour Stainless steel  
Lens profile flat  
Lens illumination non-illuminative

### IP-Rating

Front protection IP65, IP67

### Connection Method

Terminal Solder 2.8 x 0.5 mm

### Actuator

Switching action Maintained

### Switching element

Switching current 3 A  
Contact material Silver  
Contacts 1 C  
Switching system Snap-action switching element  
Switching voltage 240 V AC/DC

### Function

Pushbutton

# EAO – Your Expert Partner for Human Machine Interfaces

82-6151.2000.B002 - Pushbutton 22 mm Stand-By Symbol

## Dimensions

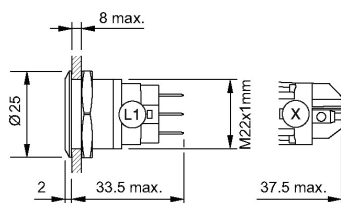

## Mounting cut-outs

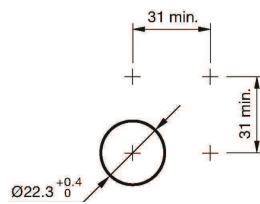

## Wiring diagram

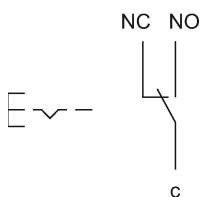

## Component layout

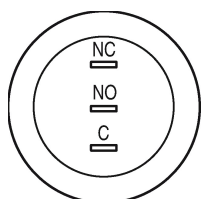

## Legend

Switching action: C = Maintained

Contacts: C = Changeover