

| | |
|----|---|
| 1 | THREADED BODY |
| 2 | PLUNGER |
| 3 | SPRING |
| 4 | LOCKING NUT |
| 5 | LEVER |
| 6 | LEVER COVER |
| 8 | STANDARD EXECUTIONS |
| 9 | Version index: |
| 10 | - RA: plunger retracted position by anti-clockwise rotation, without locking nut. |
| 11 | - RAK: plunger retracted position by anti-clockwise rotation, with locking nut. |
| 12 | - LA: plunger retracted position by clockwise rotation, without locking nut. |
| 13 | - LAK: plunger retracted position by clockwise rotation, with locking nut. |
| 14 | - RB: plunger retracted position by anti-clockwise rotation, without locking nut, with lever cover. |
| 15 | - RBK: plunger retracted position by anti-clockwise rotation, with locking nut, with lever cover. |
| 16 | - LB: plunger retracted position by clockwise rotation, without locking nut, with lever cover. |
| 17 | - LBK: plunger retracted position by clockwise rotation, with locking nut, with lever cover. |

1 **THREADED BODY**
AISI 303 stainless steel.

2 **PLUNGER**
AISI 303 stainless steel.
Suggested tolerance for plunger insertion hole = H7.

3 **SPRING**
AISI 301 stainless steel.

4 **LOCKING NUT**
AISI 304 stainless steel.

5 **LEVER**
AISI 303 stainless steel.

6 **LEVER COVER**
High-resilience polyamide based (PA) technopolymer, black colour, matte finish.

8 **STANDARD EXECUTIONS**
- **GN 721.5:** without rest position.
- **GN 721.6:** with a stop notch in the retracted position.

Version index:
- **RA:** plunger retracted position by anti-clockwise rotation, without locking nut.
- **RAK:** plunger retracted position by anti-clockwise rotation, with locking nut.
- **LA:** plunger retracted position by clockwise rotation, without locking nut.
- **LAK:** plunger retracted position by clockwise rotation, with locking nut.
- **RB:** plunger retracted position by anti-clockwise rotation, without locking nut, with lever cover.
- **RBK:** plunger retracted position by anti-clockwise rotation, with locking nut, with lever cover.
- **LB:** plunger retracted position by clockwise rotation, without locking nut, with lever cover.
- **LBK:** plunger retracted position by clockwise rotation, with locking nut, with lever cover.

FEATURES AND APPLICATIONS
GN 721.5 and GN 721.6 lever indexing plungers are used when the plunger must be retracted quickly. By rotating the lifting lever by 180°, the plunger is retracted.
In GN 721.6 execution the lever is kept in this position by a notch.

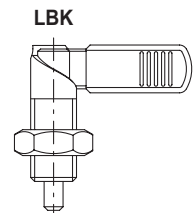
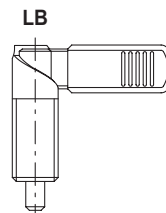
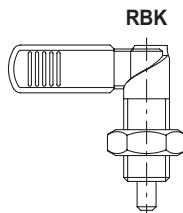
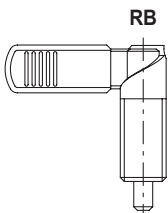
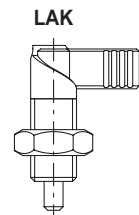
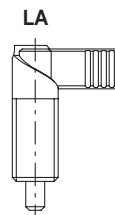
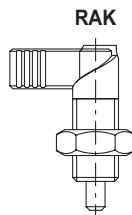
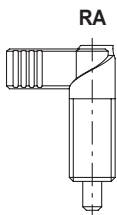
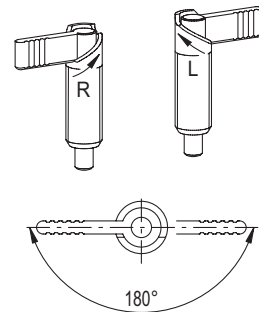

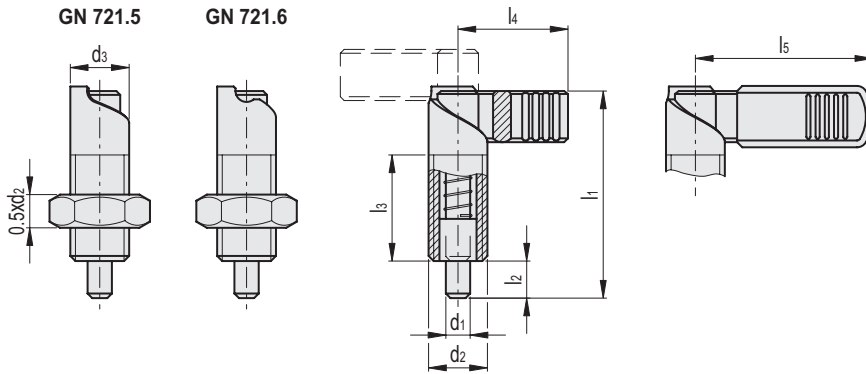

INOX STAINLESS STEEL

GN 721.5-RA

GN 721.5-RAK

| Code | Description | Code | Description | d1 | | d2 | d3 | l1 | l2 | l3+1.5 | l4 | l5 | [N]* | [N]# | Δ |
|----------|------------------------|----------|-------------------------|---------|---------|----|------|----|----|--------|----|----|------|------|---|
| | | | | Plunger | Hole H7 | | | | | | | | | | |
| GN.39719 | GN 721.5-5-M10X1-RA | GN.39759 | GN 721.5-5-M10X1-RAK | 5 | M10x1 | 10 | 37.5 | 6 | 19 | 21 | 7 | 20 | 90 | | |
| GN.39720 | GN 721.5-6-M12X1,5-RA | GN.39760 | GN 721.5-6-M12X1,5-RAK | 6 | M12x1.5 | 12 | 47 | 8 | 26 | 26 | 8 | 18 | 190 | | |
| GN.39721 | GN 721.5-8-M16X1,5-RA | GN.39761 | GN 721.5-8-M16X1,5-RAK | 8 | M16x1.5 | 16 | 56 | 10 | 30 | 32 | 11 | 29 | 64 | | |
| GN.39722 | GN 721.5-10-M20X1,5-RA | GN.39762 | GN 721.5-10-M20X1,5-RAK | 10 | M20x1.5 | 20 | 69 | 12 | 37 | 37 | 21 | 57 | 129 | | |

GN 721.5-LA

GN 721.5-LAK

| | | | | | | | | | | | | | | | |
|----------|------------------------|----------|-------------------------|----|---------|----|------|----|----|----|----|----|-----|--|--|
| GN.39711 | GN 721.5-5-M10X1-LA | GN.39751 | GN 721.5-5-M10X1-LAK | 5 | M10x1 | 10 | 37.5 | 6 | 19 | 21 | 7 | 20 | 90 | | |
| GN.39712 | GN 721.5-6-M12X1,5-LA | GN.39752 | GN 721.5-6-M12X1,5-LAK | 6 | M12x1.5 | 12 | 47 | 8 | 26 | 26 | 8 | 18 | 190 | | |
| GN.39713 | GN 721.5-8-M16X1,5-LA | GN.39753 | GN 721.5-8-M16X1,5-LAK | 8 | M16x1.5 | 16 | 56 | 10 | 30 | 32 | 11 | 29 | 64 | | |
| GN.39714 | GN 721.5-10-M20X1,5-LA | GN.39754 | GN 721.5-10-M20X1,5-LAK | 10 | M20x1.5 | 20 | 69 | 12 | 37 | 37 | 21 | 57 | 129 | | |

GN 721.5-RB

GN 721.5-RBK

| Code | Description | Code | Description | d1 | | d2 | d3 | l1 | l2 | l3+1.5 | l4 | l5 | [N]* | [N]# | Δ |
|----------|------------------------|----------|-------------------------|---------|---------|----|----|----|----|--------|----|----|------|------|---|
| | | | | Plunger | Hole H7 | | | | | | | | | | |
| GN.39724 | GN 721.5-6-M12X1,5-RB | GN.39764 | GN 721.5-6-M12X1,5-RBK | 6 | M12x1.5 | 12 | 47 | 8 | 26 | 32 | 8 | 18 | 155 | | |
| GN.39725 | GN 721.5-8-M16X1,5-RB | GN.39765 | GN 721.5-8-M16X1,5-RBK | 8 | M16x1.5 | 16 | 56 | 10 | 30 | 42 | 11 | 29 | 66 | | |
| GN.39726 | GN 721.5-10-M20X1,5-RB | GN.39766 | GN 721.5-10-M20X1,5-RBK | 10 | M20x1.5 | 20 | 69 | 12 | 37 | 52 | 21 | 57 | 132 | | |

GN 721.5-LB

GN 721.5-LBK

| | | | | | | | | | | | | | | | |
|----------|------------------------|----------|-------------------------|----|---------|----|----|----|----|----|----|----|-----|--|--|
| GN.39716 | GN 721.5-6-M12X1,5-LB | GN.39756 | GN 721.5-6-M12X1,5-LBK | 6 | M12x1.5 | 12 | 47 | 8 | 26 | 32 | 8 | 18 | 156 | | |
| GN.39717 | GN 721.5-8-M16X1,5-LB | GN.39757 | GN 721.5-8-M16X1,5-LBK | 8 | M16x1.5 | 16 | 56 | 10 | 30 | 42 | 11 | 29 | 66 | | |
| GN.39718 | GN 721.5-10-M20X1,5-LB | GN.39758 | GN 721.5-10-M20X1,5-LBK | 10 | M20x1.5 | 20 | 69 | 12 | 37 | 52 | 21 | 57 | 132 | | |

GN 721.6-RA

GN 721.6-RAK

| Code | Description | Code | Description | d1 | | d2 | d3 | l1 | l2 | l3+1.5 | l4 | [N]* | [N]# | Δ | |
|----------|------------------------|----------|-------------------------|---------|---------|----|------|----|----|--------|----|------|------|---|--|
| | | | | Plunger | Hole H7 | | | | | | | | | | |
| GN.39819 | GN 721.6-5-M10X1-RA | GN.39859 | GN 721.6-5-M10X1-RAK | 5 | M10x1 | 10 | 37.5 | 6 | 19 | 21 | 7 | 20 | 18 | | |
| GN.39820 | GN 721.6-6-M12X1,5-RA | GN.39860 | GN 721.6-6-M12X1,5-RAK | 6 | M12x1.5 | 12 | 47 | 8 | 26 | 26 | 8 | 18 | 31 | | |
| GN.39821 | GN 721.6-8-M16X1,5-RA | GN.39861 | GN 721.6-8-M16X1,5-RAK | 8 | M16x1.5 | 16 | 56 | 10 | 30 | 32 | 11 | 29 | 65 | | |
| GN.39822 | GN 721.6-10-M20X1,5-RA | GN.39862 | GN 721.6-10-M20X1,5-RAK | 10 | M20x1.5 | 20 | 69 | 12 | 37 | 37 | 21 | 57 | 130 | | |

GN 721.6-LA

GN 721.6-LAK

| | | | | | | | | | | | | | | | |
|----------|------------------------|----------|-------------------------|----|---------|----|------|----|----|----|----|----|-----|--|--|
| GN.39811 | GN 721.6-5-M10X1-LA | GN.39851 | GN 721.6-5-M10X1-LAK | 5 | M10x1 | 10 | 37.5 | 6 | 19 | 21 | 7 | 20 | 18 | | |
| GN.39812 | GN 721.6-6-M12X1,5-LA | GN.39852 | GN 721.6-6-M12X1,5-LAK | 6 | M12x1.5 | 12 | 47 | 8 | 26 | 26 | 8 | 18 | 31 | | |
| GN.39813 | GN 721.6-8-M16X1,5-LA | GN.39853 | GN 721.6-8-M16X1,5-LAK | 8 | M16x1.5 | 16 | 56 | 10 | 30 | 32 | 11 | 29 | 66 | | |
| GN.39814 | GN 721.6-10-M20X1,5-LA | GN.39854 | GN 721.6-10-M20X1,5-LAK | 10 | M20x1.5 | 20 | 69 | 12 | 37 | 37 | 21 | 57 | 129 | | |

GN 721.6-RB

GN 721.6-RBK

| Code | Description | Code | Description | d1 | | d2 | d3 | l1 | l2 | l3+1.5 | l4 | l5 | [N]* | [N]# | Δ |
|----------|------------------------|----------|-------------------------|---------|---------|----|----|----|----|--------|----|----|------|------|---|
| | | | | Plunger | Hole H7 | | | | | | | | | | |
| GN.39824 | GN 721.6-6-M12X1,5-RB | GN.39864 | GN 721.6-6-M12X1,5-RBK | 6 | M12x1.5 | 12 | 47 | 8 | 26 | 32 | 8 | 18 | 31 | | |
| GN.39825 | GN 721.6-8-M16X1,5-RB | GN.39865 | GN 721.6-8-M16X1,5-RBK | 8 | M16x1.5 | 16 | 56 | 10 | 30 | 42 | 11 | 29 | 68 | | |
| GN.39826 | GN 721.6-10-M20X1,5-RB | GN.39866 | GN 721.6-10-M20X1,5-RBK | 10 | M20x1.5 | 20 | 69 | 12 | 37 | 52 | 21 | 57 | 133 | | |

GN 721.6-LB

GN 721.6-LBK

| | | | | | | | | | | | | | | | |
|----------|------------------------|----------|-------------------------|----|---------|----|----|----|----|----|----|----|-----|--|--|
| GN.39816 | GN 721.6-6-M12X1,5-LB | GN.39856 | GN 721.6-6-M12X1,5-LBK | 6 | M12x1.5 | 12 | 47 | 8 | 26 | 32 | 8 | 18 | 31 | | |
| GN.39817 | GN 721.6-8-M16X1,5-LB | GN.39857 | GN 721.6-8-M16X1,5-LBK | 8 | M16x1.5 | 16 | 56 | 10 | 30 | 42 | 11 | 29 | 68 | | |
| GN.39818 | GN 721.6-10-M20X1,5-LB | GN.39858 | GN 721.6-10-M20X1,5-LBK | 10 | M20x1.5 | 20 | 69 | 12 | 37 | 52 | 21 | 57 | 133 | | |

* Spring preload

Spring maximum load

