

# ABM-2A ABSTANDSBOLZEN



## Merkmale

- beidseitiges Aussengewinde
- Material: Stahl glanzverzinkt, Messing vernickelt oder Edelstahl
- Wahlweise mit oder ohne Hinterstich nach DIN76
- Gewindefreistich nach DIN76

## Abmessungen

► Einheit = mm

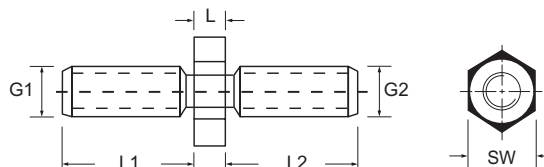

Art.-Nr.	L in mm	Material	SW	G1 in mm	G2 in mm	L1 in mm	L2 in mm
106 53 01,7H	1,7	Stahl verzinkt	5,5	M3	M3	6,0	8,0
107 54 02H	2,0	Stahl verzinkt	7,0	M4	M4	6,0	7,0
104 51 03HB5	3,0	Stahl verzinkt	5,0	M2,5	M2,5	5,0	5,0
106 53 03,0H	3,0	Messing vernickelt	5,5	M3	M3	5,0	5,0
106 53 03HA2	3,0	Edelstahl	5,5	M3	M3	6,0	8,0
104 53 04,5H	4,5	Stahl verzinkt	5,0	M3	M3	6,0	6,0
106 53 04,5	4,5	Stahl verzinkt	5,5	M3	M3	6,5	6,5
104 53 04,7H	4,7	Stahl verzinkt	5,0	M3	M3	6,0	6,0
106 53 05H	5,0	Stahl verzinkt	5,5	M3	M3	6,0	8,0
106 53 06H	6,0	Messing vernickelt	5,5	M3	M3	6,0	6,0
107 54 05H	5,0	Stahl verzinkt	7,0	M4	M4	6,0	8,0
104 53 10H	10,0	Messing vernickelt	5,0	M3	M3	8,0	8,0
106 53 10H	10,0	Stahl verzinkt	5,5	M3	M3	6,0	8,0
109 56 10HB11A2	10,0	Edelstahl	10,0	M6	M6	11,0	11,0
106 53 12HB7	12,0	Stahl verzinkt	5,5	M3	M3	7,0	7,0
102 53 14H	14,0	Stahl verzinkt	6,0	M3	M3	6,0	6,0
104 53 15HB8MN	15,0	Messing vernickelt	5,0	M3	M5	8,0	8,0
106 53 30	30,0	Stahl verzinkt	5,5	M3	M3	6,0	8,0
108 55 40HB8	40,0	Stahl verzinkt	8,0	M5	M5	8,0	8,0
106 53 73H	73,0	Stahl verzinkt	5,5	M3	M3	6,0	8,0
109 55 80H	80,0	Stahl verzinkt	10,0	M5	M5	10,0	10,0

