

# threaded fittings

## 3609 male elbow — fractional inch tube to NPT

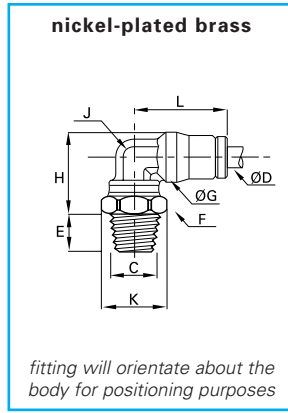
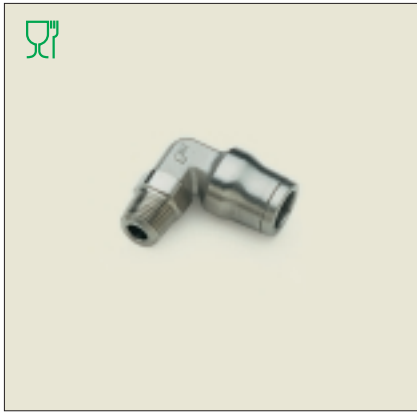

ØD in	C NPT		E in	F mm	G in	H in	J in	K in	L in	
5/32	1/8	3609 04 11	.30	11	.39	.59	.28	.47	.71	.56
5/32	1/4	3609 04 14	.43	14	.39	.67	.28	.60	.71	.81
1/4	1/8	3609 56 11	.30	11	.49	.69	.32	.47	.87	.92
1/4	1/4	3609 56 14	.43	14	.49	.75	.32	.60	.87	1.09
1/4	3/8	3609 56 18	.45	18	.49	.75	.32	.77	.87	1.20
3/8	1/4	3609 60 14	.43	15	.67	.93	.47	.63	1.14	2.40
3/8	3/8	3609 60 18	.45	18	.67	1.02	.47	.77	1.14	2.36
3/8	1/2	3609 60 22	.59	22	.67	1.06	.47	.94	1.14	2.54
1/2	3/8	3609 62 18	.45	18	.79	1.14	.59	.77	1.22	3.28
1/2	1/2	3609 62 22	.59	22	.79	1.14	.59	.94	1.22	3.49

## 3609 male elbow — metric tube to BSPT

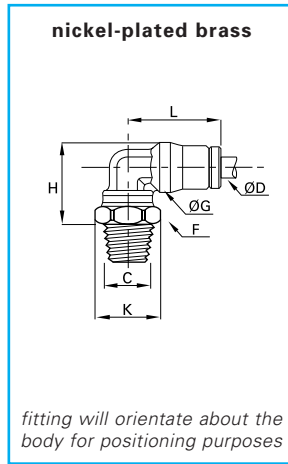
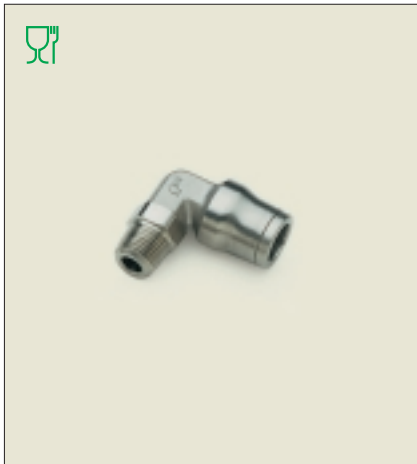

ØD mm	C BSPT		F mm	G mm	H mm	K mm	L mm	
4	R1/8	3609 04 10	11	10	15	12	18	.016
4	R1/4	3609 04 13	14	10	17	15	18	.023
6	R1/8	3609 06 10	11	12	17.5	12	21.5	.026
6	R1/4	3609 06 13	14	12	19	15	21.5	.031
8	R1/8	3609 08 10	11	15	19.5	12	23.5	.040
8	R1/4	3609 08 13	14	15	21	15	23.5	.044
8	R3/8	3609 08 17	17	15	21	18.5	23.5	.048
10	R1/4	3609 10 13	15	17.5	23.5	16	29	.068
10	R3/8	3609 10 17	17	17.5	25.5	18.5	29	.067
12	R1/4	3609 12 13	15	19.5	26	16	31	.087
12	R3/8	3609 12 17	17	19.5	28.5	18.5	31	.093
12	R1/2	3609 12 21	21	19.5	28.5	23	31	.099
14	R3/8	3609 14 17	19	21.5	29	21	34	.066
14	R1/2	3609 14 21	24	21.5	30	26	34	.076

## 3669 extended male elbow — metric tube to BSPP or M5

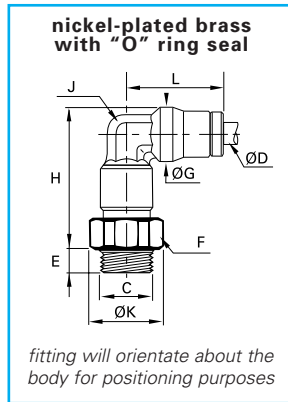
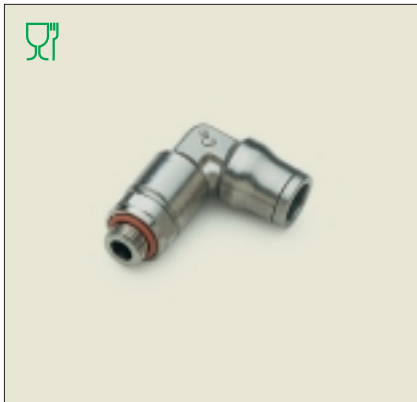

ØD mm	C BSPP/ M5		F mm	G mm	H mm	K mm	L mm	
4	M5x0.8	3669 04 19	10	10	27.5	11	18	0.015
4	G1/8	3669 04 10	13	10	25.5	14	18	0.017
6	G1/8	3669 06 10	13	12	31	14	18	0.023
6	G1/4	3669 06 13	16	12	30.5	17.5	21.5	0.028
8	G1/8	3669 08 10	14	15	33.5	15	23.5	0.031
8	G1/4	3669 08 13	16	15	34	17.5	23.5	0.036
10	G1/4	3669 10 13	18	17.5	42	19.5	29	0.053
10	G3/8	3669 10 17	20	17.5	41	22	29	0.056
12	G1/4	3669 12 13	20	19.5	47	22	31	0.075
12	G3/8	3669 12 17	20	19.5	46	22	31	0.072
14	G1/2	3669 14 21	24	21.5	49	26	34	0.094

## 3629 extended male elbow — metric tube to BSPT

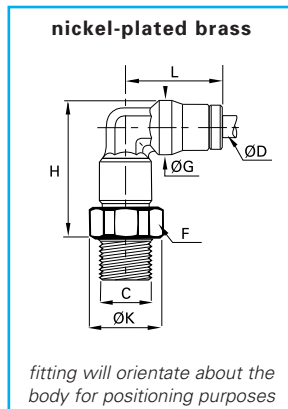

ØD mm	C BSPT		F mm	G mm	H mm	K mm	L mm	
4	R1/8	3629 04 10	10	10	24.5	11	18	.016
6	R1/8	3629 06 10	13	12	29.5	14	21.5	.025
6	R1/4	3629 06 13	14	12	30.5	15	21.5	.031
8	R1/8	3629 08 10	14	15	32.5	15	23.5	.031
8	R1/4	3629 08 13	14	15	34	15	23.5	.036
10	R1/4	3629 10 13	18	17.5	39	19.5	29	.053

= suitable for food applications