

**GH506 / GH506B / GH466 /
GH466B / FC325 / GH213
GH810 (-12 to -32)**

Nipples with
wire trap

Nippel mit
Ausreiß-
sicherung

Nipples avec
gorge pour
retenir les
nappes

Nipples con
protezione da
strappo

Manguito
roscados para
seguro de
arranque

GH506(B)/FC325/GH466(B)/GH213/GH810

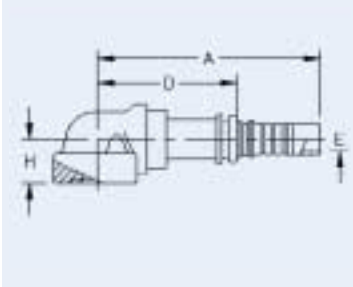

Fixed Captive Flange 90° - short (6000 psi)

Captive Flange Code 62, 90° Elbow
Captive Flansch-Code 62, 90° Krümmer
Captive Bride Code 62, coude 90°
Captive Flangia codice 62 a 90°
Captive Brida-código 62 acodado a 90°

| Part Number GH506(B)/FC325/213-20 GH810-12,-16,20 | Part Number GH466(B)/GH213-24,-32 GH810-24 | Thread T | Flange | Tube O.D. mm | Hose ND | Hose Size | A mm | D mm | H mm | E mm | K Ø mm | Bolt Ø metric/ inch | HEX [1] | HEX [2] |
|---|--|-------------|--------|--------------------|------------|--------------|---------|---------|---------|---------|-----------|---------------------------|------------|------------|
| FJ2218-1212S | | | 3/4" | | 19 | -12 | 138,9 | 86,9 | 28 | 15,1 | | M10 | | |
| FJ2218-1216S | | | 3/4" | | 25 | -16 | 131,2 | 64,6 | 28 | 19,6 | | M10 | | |
| FJ2218-1616S | | | 1" | | 25 | -16 | 137,2 | 70,6 | 34 | 19,6 | | M12 | | |
| FJ2218-2020S | | | 1 1/4" | | 31 | -20 | 147,5 | 72,6 | 38 | 25,5 | | M14 | | |

GH506(B)/FC325/GH466(B)/GH213/GH810

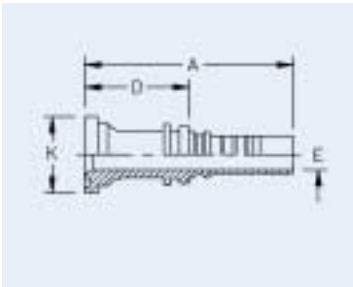

CT (6000 psi)

CAT Flange
CAT Flansch
CAT Bride
CAT Flangia
CAT Bride

| Part Number GH506(B)/FC325/ GH810-12,-16 | Part Number GH466(B)/GH213-24,-32 GH810-20,-24,-32 | Thread T | Flange | Tube O.D. mm | Hose ND | Hose Size | A mm | D mm | H mm | E mm | K Ø mm | HEX [1] | HEX [2] |
|--|--|-------------|--------|--------------------|------------|--------------|---------|---------|---------|---------|-----------|------------|------------|
| 1W12CT12 | | | 3/4" | | 19 | -12 | 116,1 | 64,1 | | 15,1 | 41,3 | | |
| 1W16CT12 | | | 1" | | 19 | -12 | 122,9 | 70,9 | | 15,1 | 47,6 | | |
| 1W16CT16 | | | 1" | | 25 | -16 | 138,7 | 72,1 | | 19,6 | 47,6 | | |
| 1W20CT16 | | | 1 1/4" | | 25 | -16 | 138,7 | 72,1 | | 19,6 | 54,0 | | |
| 1W20CT20 | 1W20CT20 | | 1 1/4" | | 31 | -20 | 149,1 | 74,2 | | 25,5 | 54,0 | | |
| 1W24CT20 | 1W24CT20 | | 1 1/2" | | 31 | -20 | 187,3 | 112,3 | | 26,5 | 63,5 | | |
| 1W24CT24 | 1W24CT24 | | 1 1/2" | | 38 | -24 | 204,6 | 106,1 | | 30,0 | 63,5 | | |