

EAO – Your Expert Partner for Human Machine Interfaces

31-940 - PCB plug-in base

31-940 - PCB plug-in base



Attention: The preview is based on a sample product. This can differ from your current configuration.

Other Attributes

Weight 0.002 kg
Pins axial

Connection Method

Terminal PCB

Dimensions

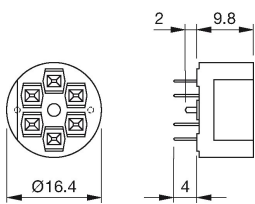

Component layout

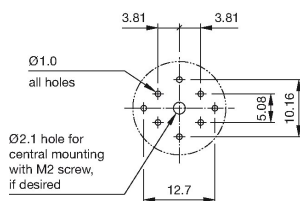

Additional information

For low level switching element

PCB plug-in base pins right-angle: With the extendable mounting the distance between plug-in base and PCB can be varied up to 3 mm