

E20856

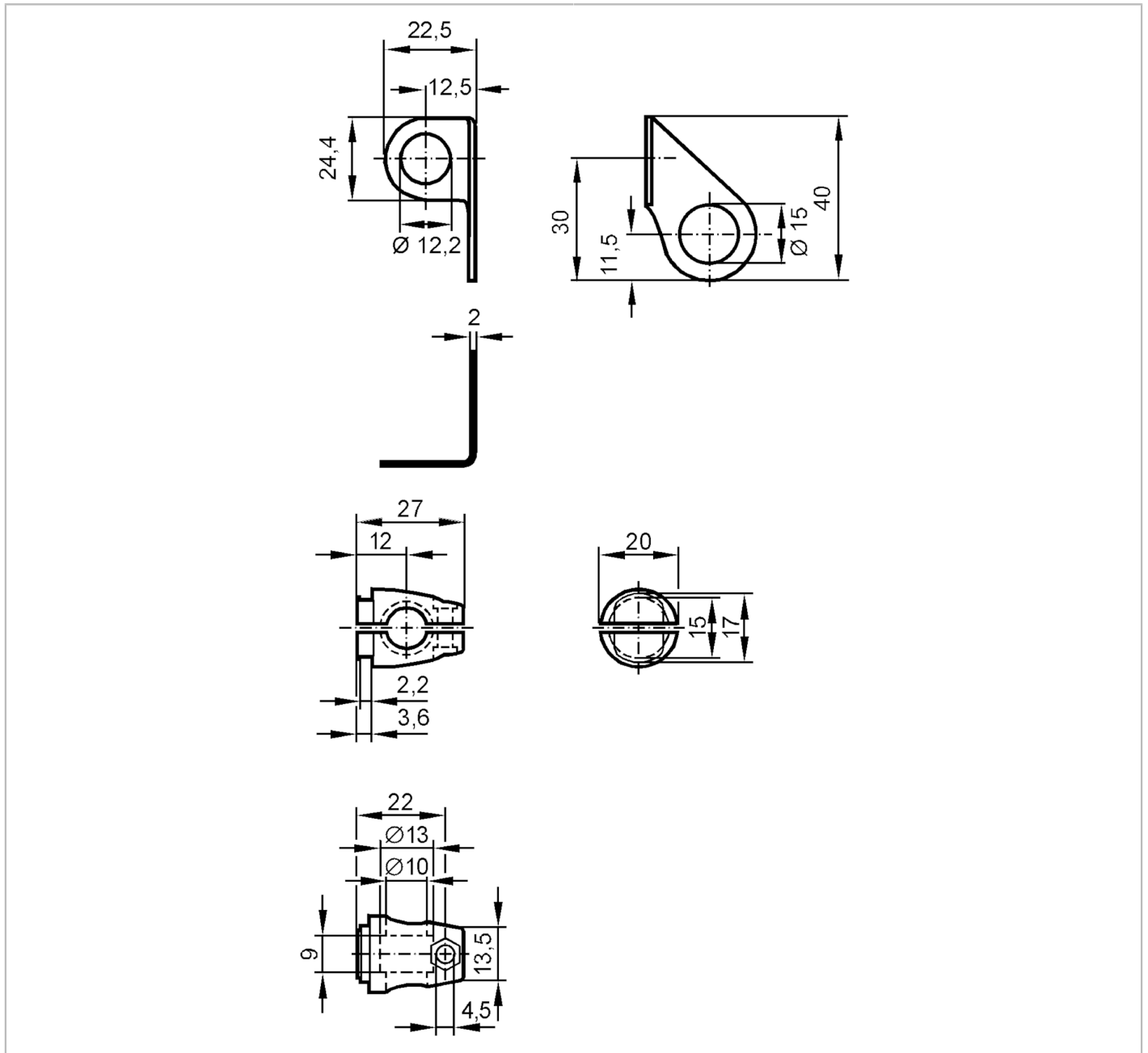

Mounting set for position sensors

SYSTEM COMPONENT M12 BOLT



| Application | |
|------------------------|--|
| Design | clamp mounting |
| Mechanical data | |
| Weight [g] | 83 |
| Type of mounting | free-standing; (M8) |
| Dimensions [mm] | $\varnothing 12.2$ |
| Materials | fixture: stainless steel (1.4571/316Ti); Clamp: diecast zinc |
| Accessories | |
| Accessories (supplied) | screw: 1 x M8 x 40 |
| Remarks | |
| Pack quantity | 1 pcs. |