

PARALLEL CONNECTION WITH TERMINAL, 3-POLE
FOR 3RT.03



General technical data:

product brand name	SIRIUS
Product designation	Infeed terminal
Design of the product	Parallel switching connection for contactors S2
Size of contactor	S2

Installation/ mounting/ dimensions:

Mounting type	screw fixing
---------------	--------------

Certificates/ approvals:

General Product Approval			Declaration of Conformity	Test Certificates	
 CSA	 UL		 EG-Konf.	Type Test Certificates/Test Report	Special Test Certificate

Shipping Approval					other
 ABS	 BUREAU VERITAS	 GL	 PRS	 RINA	Environmental Confirmations

other	
Confirmation	other

Further information

Information- and Downloadcenter (Catalogs, Brochures,...)

<http://www.siemens.com/industrial-controls/catalogs>

Industry Mall (Online ordering system)

<http://www.siemens.com/industrymall>

Cax online generator

<http://support.automation.siemens.com/WW/CAXorder/default.aspx?lang=en&mlfb=3RT19364BB31>

Service&Support (Manuals, Certificates, Characteristics, FAQs,...)

<http://support.automation.siemens.com/WW/view/en/3RT19364BB31/all>

Image database (product images, 2D dimension drawings, 3D models, device circuit diagrams, EPLAN macros, ...)

<http://www.automation.siemens.com/bilddb/index.aspx?attID9=3RT19364BB31&lang=en>

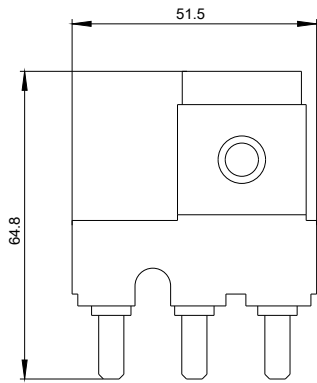

last modified:

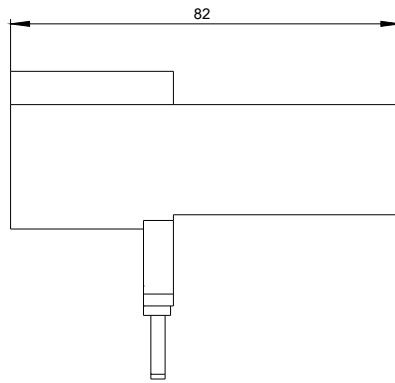

09.03.2015