

Linear Bearings KB-3 ISO Series 3, Premium, Closed Design, Stainless

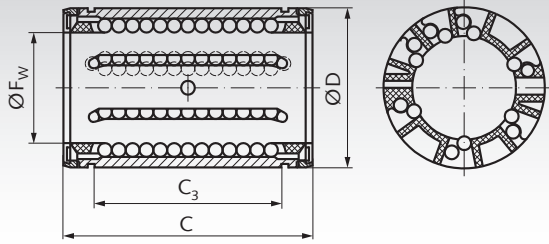

Stainless linear bearings series 3 of ISO standard 10285 from premium brand in top quality.

High load-bearing capacity, due to the asymmetric position of the rows of balls and the specially shaped raceway segments. These linear bearings can be fitted inside a closed or open housing and are thus adjustable.

With shields or wiping double-lip seals.

Bearings with FW 5mm must be lubricated before use. All other bearings are lubricated ready-to-install.

Recommended shaft tolerance h6, housing tolerance H6.

Ordering Details: e.g.: Product No. 646 990 12, Linear Bearing KB-3, Stainless, Internal Ø 12 mm, with Shields



Product No. with Shields	Product No. with Seals	F _w mm	D mm	C mm	C ₃ mm	Number of Rows of Balls	Load Rating dyn. C N	Load Rating stat. C ₀ N	Weight g
-	646 991 05	5	12	22	12	4	280	210	5
-	646 991 08	8	16	25	14	4	490	355	9
646 990 12	646 991 12	12	22	32	20	5	1370	1120	20
646 990 16	646 991 16	16	26	36	22	5	1600	1290	26
646 990 20	646 991 20	20	32	45	28	6	3250	2650	56
646 990 25	646 991 25	25	40	58	40	6	4550	3800	108
646 990 30	646 991 30	30	47	68	48	6	7100	5700	122
646 990 40	646 991 40	40	62	80	56	6	11200	8300	205
-	646 991 50	50	75	100	72	7	13400	12200	460

Shaft steel page 539. Shaft blocks page 549.
Precision housings page 556.

Linear Bearings KB-3-A ISO Series 3, Premium, Self-Aligning, Closed Design, Stainless

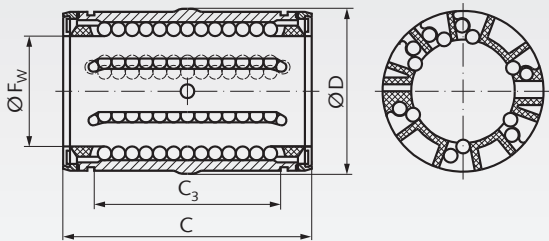

Stainless self-aligning linear bearings series 3 of ISO standard 10285 from premium brand in top quality.

High load-bearing capacity, due to the asymmetric position of the rows of balls and the specially shaped raceway segments. These linear bearings can be fitted inside a closed or slotted housing and are thus adjustable.

With wiping double-lip seals.

These bearings are self-aligning up to +/- 0,5°. All bearings are lubricated ready-to-install.

Recommended shaft tolerance h6, housing tolerance H6.

Ordering Details: e.g.: Product No. 646 992 12, Linear Bearing KB-3-A, Stainless, Internal Ø 12 mm



Product No. with Seals	F _w mm	D mm	C ^{-0,02} mm	C ₃ ^{-0,02} mm	Load rating dyn. C N	Load rating stat. C ₀ N	Weight g
646 992 12	12	22	32	20,3	1220	930	20
646 992 16	16	26	36	22,3	1400	1060	25
646 992 20	20	32	45	28,3	2550	1800	55
646 992 25	25	40	58	40,4	3800	2320	106
646 992 30	30	47	68	48,4	5600	3750	120
646 992 40	40	62	80	56,3	9650	5700	200
646 992 50	50	75	100	72,3	11200	6950	440

Shaft steel page 539. Shaft blocks page 549.
Precision housings page 556.