

Magnet-Adapter XMA-...

Zur Kontaktierung von Schraubenköpfen mit starrer Ø 4 mm-Buchse im Isolierkörper, geeignet zur Aufnahme federnder Ø 4 mm-Stecker mit starrer Isolierhülse.

XMA-7



XMA-7L



XMA-11



Magnetic Adapter XMA-...

For connection of screw heads with rigid Ø 4 mm socket in insulator, suitable for mating with spring-loaded Ø 4 mm plugs with rigid insulating sleeve.

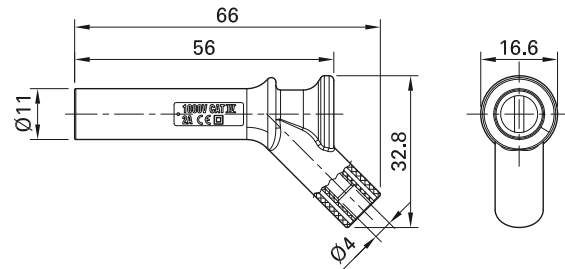
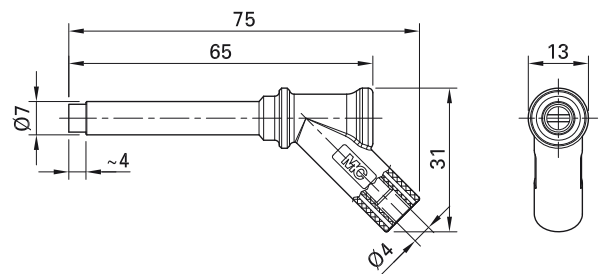
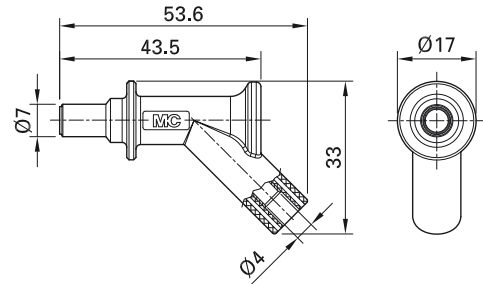

Typ Type	Bestell-Nr. Order No.	Bemessungsspannung/-strom Rated voltage/current	Magnet-Durchmesser Diameter of magnet		* Farben * Colors
XMA-7	66.9516-*	1000 V, CAT III / 2 A 600 V, CAT IV / 2 A	Ø 7 mm	Ni CE	21 22 23
XMA-7L	66.9509-*	1000 V, CAT IV / 2 A	Ø 7 mm	Ni CE	21 22 23
XMA-11	66.9515-*	1000 V, CAT IV / 2 A	Ø 11 mm	Ni CE	21 22 23