

# KEL 24

## Cable entry frames



Split inserts



Surrounding tongue and groove connection

Description	Type	Order No.	Inserts KT		PU
			small	large	

1

### Product description

The KEL-24 matches exactly the cut-out dimensions of 24-pole standard industrial connectors.

The split insert matching the cable diameter is placed around the cable and inserted into the cable entry frame.

Either a cut out of 36mm or 46mm tall can be chosen depending on the cables being routed. This flexibility is perfect for pre-terminated cables.

### Advantages

- Warranty of pre-terminated cables remains
- Retrofitting and maintenance can be carried out easily and quickly
- High packing density, wide variety of frames and inserts
- Strain relief according DIN EN 50262

### Specification

Material	Polyamide
Flame class	UL-94 Vo, self-extinguishing
Protection class	IP 54, with gasket and correct selection of the cable inserts
Temperature	- 40°C to + 140°C (static)
Properties	halogen-free, silicone-free
Cut-out dimensions	36 x 112 mm / page 106

### Accessories

KT Cable inserts	Page 20   24
KEL-SNAP SNAP frames	Page 15
KEL-EMC Cable collector	Page 82   84
KDR2   KDR Base plates	Page 90   93
FP Flanged plates	Page 94   97
MP Module plates	Page 98

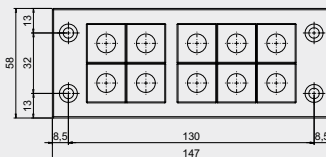

KEL 24 | 10

42241

10 | -

10

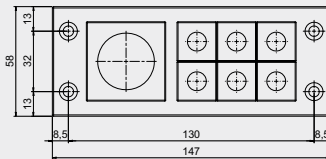

KEL 24 | 7

42247

6 | 1

10

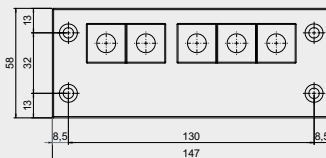

KEL 24 | 5

42248

5 | -

10

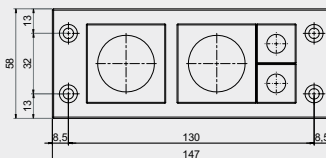

KEL 24 | 4

42244

2 | 2

10

# KEL 16

## Cable entry frames



Surrounding tongue and groove connection



Split inserts



Type	Order No.	Inserts KT small   large	PU	Description
------	-----------	-----------------------------	----	-------------

KEL 16   8	42168	8   -	10	
KEL 16   5	42165	4   1	10	
KEL 16   4	42164	4   -	10	
KEL 16   2	42162	-   2	10	

### Product description

The KEL-16 matches exactly the cut-out dimensions of 16-pole standard industrial connectors.

The split insert matching the cable diameter is placed around the cable and inserted into the cable entry frame.

Either a cut out of 36mm or 46mm tall can be chosen depending on the cables being routed. This flexibility is perfect for pre-terminated cables.

### Advantages

- Warranty of pre-terminated cables remains
- Retrofitting and maintenance can be carried out easily and quickly
- High packing density, wide variety of frames and inserts
- Strain relief according DIN EN 50262

### Specification

Material	Polyamide
Flame class	UL-94 V0, self-extinguishing
Protection class	IP 54, with gasket and correct selection of the cable inserts
Temperature	- 40°C to + 140°C (static)
Properties	halogen-free, silicone-free
Cut-out dimensions	36 x 86 mm / page 106

### Accessories

KT Cable inserts	Page 20   24
KEL-SNAP SNAP frames	Page 15
KEL-EMC Cable collector	Page 82   84
KDR Base plates	Page 92   93

# KEL 10

## Cable entry frames



Split inserts



Surrounding tongue and groove connection

Descripton	Type	Order No.	Inserts KT small   large	PU
------------	------	-----------	-----------------------------	----

1

### Product description

The KEL-10 matches exactly the cut-out dimensions of 10-pole standard industrial connectors.

The split insert matching the cable diameter is placed around the cable and inserted into the cable entry frame.

Either a cut out of 36mm or 46mm tall can be chosen depending on the cables being routed. This flexibility is perfect for pre-terminated cables.

### Advantages

- Warranty of pre-terminated cables remains
- Retrofitting and maintenance can be carried out easily and quickly
- High packing density, wide variety of frames and inserts
- Strain relief according DIN EN 50262

### Specificationen

Material	Polyamide
Flame class	UL-94 Vo, self-extinguishing
Protection class	IP 54, with gasket and correct selection of the cable inserts
Temperature	- 40°C to + 140°C (static)
Properties	halogen-free, silicone-free
Cut-out dimensions	36 x 65 mm / page 106

### Accessories

KT Cable inserts	Page 20   24
KEL-SNAP SNAP frames	Page 15
KEL-EMC Cable collector	Page 83   84

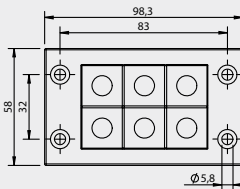

KEL  
10 | 6

42216

6 | -

10

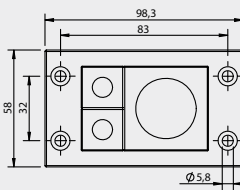

KEL  
10 | 3

42212

2 | 1

10

# KEL - B Cable entry frames



Surrounding tongue and groove connection



Split inserts



## Product description

The KEL-B matches exactly the cut-out dimensions of 46 x 46 mm measuring instruments.

The split insert matching the cable diameter is placed around the cable and inserted into the cable entry frame.

For routing cables and conduits up to 34 mm diameter.

## Advantages

- Warranty of pre-terminated cables remains
- Retrofitting and maintenance can be carried out easily and quickly
- Space saving shape
- Small cut-out, high packing density
- Strain relief according DIN EN 50262

## Specification

Material	Polyamide
Flame class	UL-94 Vo, self-extinguishing
Protection class	IP 54, with gasket and correct selection of the cable inserts
Temperature	- 40°C to + 140°C (static)
Properties	halogen-free, silicone-free
Cut-out dimensions	46 x 46 mm / page 106

## Accessories

KT Cable inserts	Page 20   24
KEL-SNAP SNAP frames	Page 15
KEL-EMC Cable collector	Page 83   84

Type	Order No.	Inserts KT small   large	PU	Description
KEL - B4	42204	4   -	10	
KEL - B1	42206	-   1	10	