

SAH. Clamping bolts

Steel



BASE

Zinc-plated steel.

THREADED STEM

Zinc-plated steel.

NUTS

Zinc-plated steel.

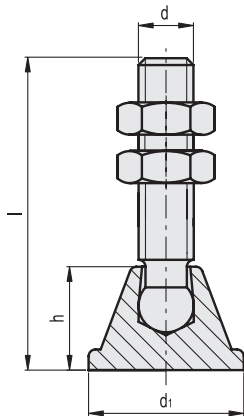

| Code | Description | d | d1 | h | l | ⚖️ |
|----------|-------------|-----|----|-----|-----|----|
| GG.AU120 | SAH.M5x36 | M5 | 14 | 9.5 | 36 | 10 |
| GG.AU121 | SAH.M6x45 | M6 | 16 | 10 | 45 | 17 |
| GG.AU122 | SAH.M8x65 | M8 | 18 | 12 | 65 | 30 |
| GG.AU123 | SAH.M10x75 | M10 | 20 | 14 | 75 | 56 |
| GG.AU124 | SAH.M12x85 | M12 | 24 | 16 | 85 | 47 |
| GG.AU125 | SAH.M12x125 | M12 | 24 | 16 | 125 | 95 |

SAH-SST Clamping bolts

Stainless steel



BASE

AISI 304 stainless steel.

THREADED STEM

AISI 304 stainless steel.

NUTS

AISI 304 stainless steel.

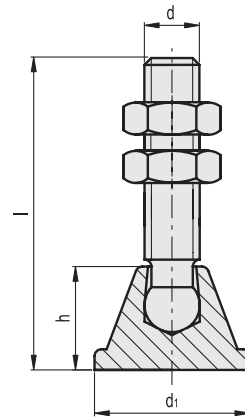

| Code | Description | d | d1 | h | l | ⚖️ |
|----------|---------------|----|----|-----|----|----|
| GG.AU520 | SAH-SST-M5x36 | M5 | 14 | 9.5 | 36 | 10 |
| GG.AU521 | SAH-SST-M6x45 | M6 | 16 | 10 | 45 | 17 |
| GG.AU522 | SAH-SST-M8x65 | M8 | 18 | 12 | 65 | 30 |



- 1
- 2
- 3
- 4
- 5
- 6
- 7
- 8
- 9
- 10
- 11
- 12
- 13
- 14
- 15
- 16
- 17
- 18