



Figure similar

WITHDR. COIL FOR MOD. S6 FOR CONTACTORS
 3RT105/3RT145 AC/DC ACTUATOR UC110-127V
 DRIVE: CONVENTIONAL

General technical data:

product brand name		SIRIUS
Product designation		Magnet coil

Control circuit:

Type of voltage of the control supply voltage		AC/DC
Control supply voltage		
<ul style="list-style-type: none"> • 1 with AC <ul style="list-style-type: none"> — at 50 Hz Rated value — at 60 Hz Rated value • 2 with AC <ul style="list-style-type: none"> — at 50 Hz Rated value — at 60 Hz Rated value 	<ul style="list-style-type: none"> V V V V 	<ul style="list-style-type: none"> 110 110 127 127
Control supply voltage		
<ul style="list-style-type: none"> • 1 for DC Rated value • 2 for DC Rated value 	<ul style="list-style-type: none"> V V 	<ul style="list-style-type: none"> 110 127

Certificates/ approvals:

General Product Approval	Functional Safety/Safety of Machinery	Declaration of Conformity	Test Certificates
--------------------------	---------------------------------------	---------------------------	-------------------



[Type Examination](#)



[Special Test Certificate](#)

Shipping Approval



Shipping Approval	other
-------------------	-------



[Confirmation](#)

[Environmental Confirmations](#)

[other](#)

Further information

Information- and Downloadcenter (Catalogs, Brochures,...)

<http://www.siemens.com/industrial-controls/catalogs>

Industry Mall (Online ordering system)

<http://www.siemens.com/industrymall>

Cax online generator

<http://support.automation.siemens.com/WW/CAXorder/default.aspx?lang=en&mlfb=3RT19555AF31>

Service&Support (Manuals, Certificates, Characteristics, FAQs,...)

<http://support.automation.siemens.com/WW/view/en/3RT19555AF31/all>

Image database (product images, 2D dimension drawings, 3D models, device circuit diagrams, EPLAN macros, ...)

<http://www.automation.siemens.com/bilddb/index.aspx?attID9=3RT19555AF31&lang=en>

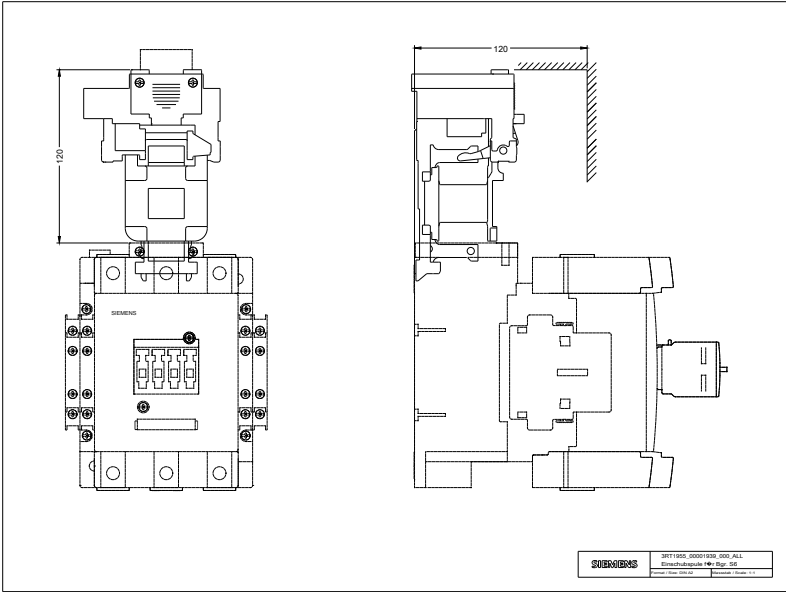

last modified:

09.03.2015