

MI1206K601R-10

UNCONTROLLED DOCUMENT

PHYSICAL DIMENSIONS:

A	3.20 [.126]	+ 0.20 [.008]
B	1.60 [.063]	+ 0.20 [.008]
C	1.10 [.043]	+ 0.20 [.008]
D	0.51 [.020]	+ 0.25 [.010]

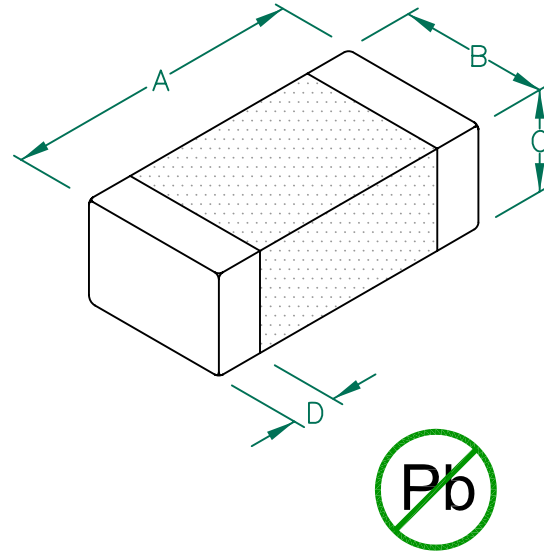

ELECTRICAL CHARACTERISTICS:			
Z @ 100MHz (Ω)	DCR (Ω)	Rated Current	
Nominal	600		
Minimum	450		
Maximum	750	0.080	1500 mA

Z vs FREQUENCY
IMPEDANCE UNDER DC BIAS

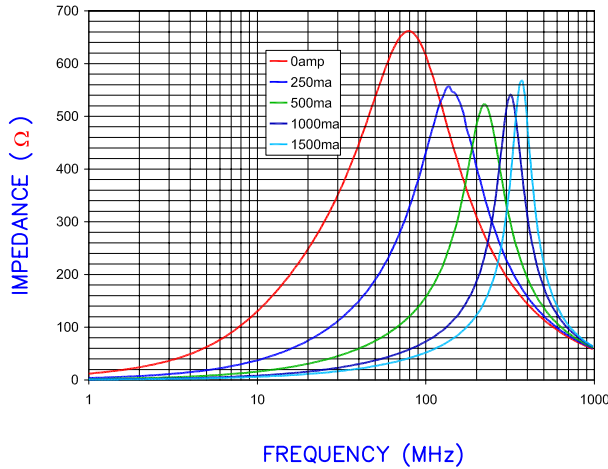

|Z|, R, AND X vs. FREQUENCY

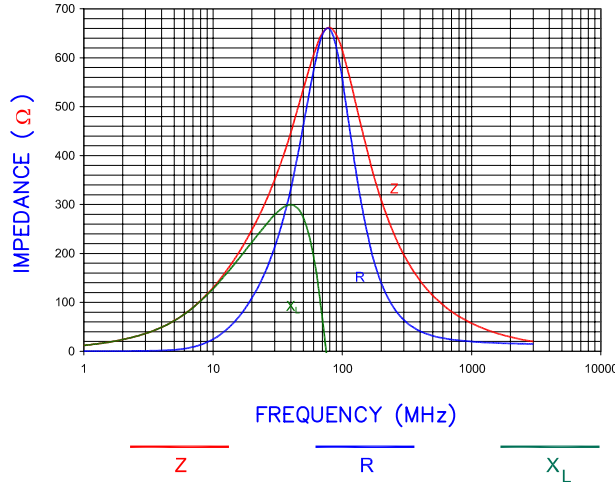

LAND PATTERNS FOR REFLOW SOLDERING

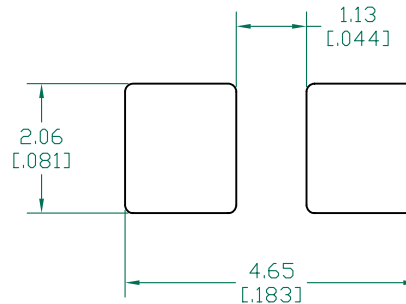

(For wave soldering, add 0.762 (.030) to this dimension)

RECOMMENDED SOLDERING CONDITIONS

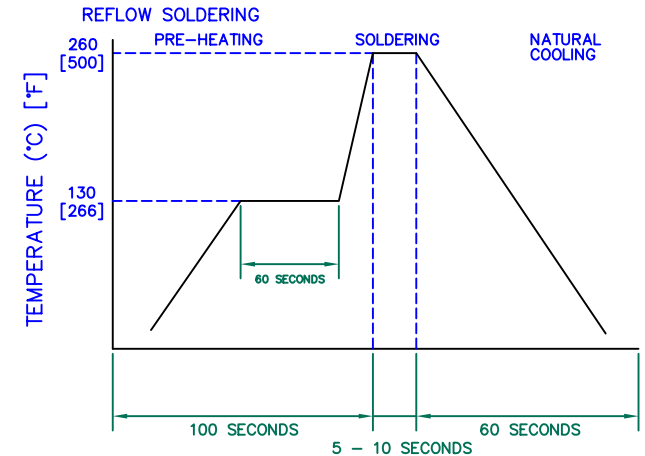

DIMENSIONS ARE IN mm [INCHES].

This print is the property of Laird Tech. and is loaned in confidence subject to return upon request and with the understanding that no copies shall be made without the written consent of Laird Tech. All rights to design or invention are reserved.



PROJECT/PART NUMBER:		REV	PART TYPE:	DRAWN BY:
MI1206K601R-10		D	CO-FIRE	TMB
DATE:	03/26/04	SCALE:	NTS	SHEET:
CAD #	MI1206K601R-10-D	TOOL #	-	2 of 2
REV	DESCRIPTION	DATE	INT	
D	CHANGE SOLDERING TEMPERATURE FROM 250	07/12/10	JUN	
C	UPDATE COMPANY LOGO	08/22/08	JRK	
B	ADD ROHS SYMBOL CHANGE CURRENT RATING	06/24/05	JRK	
A	ORIGINAL DRAFT	03/26/04	TMB	

