

PRODUCT NUMBER

71600-YXXLF

- LEAD FREE, SEE NOTE 6
- TOTAL NB OF POSITION 04 TO 64 SEE SHEET 2
- OPTIONAL STRAIN RELIEF SEE SHEET 2

TRIANGLE INDICATES POSITION 1  
NOTE 5

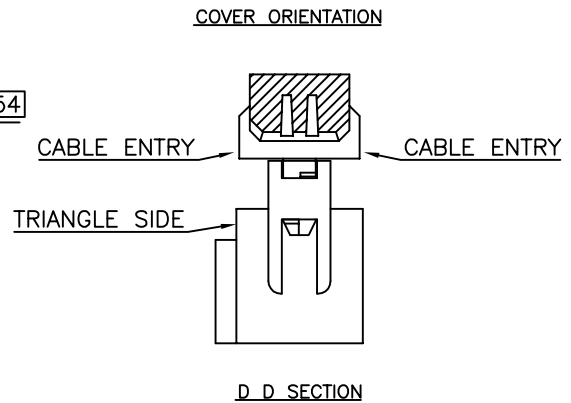
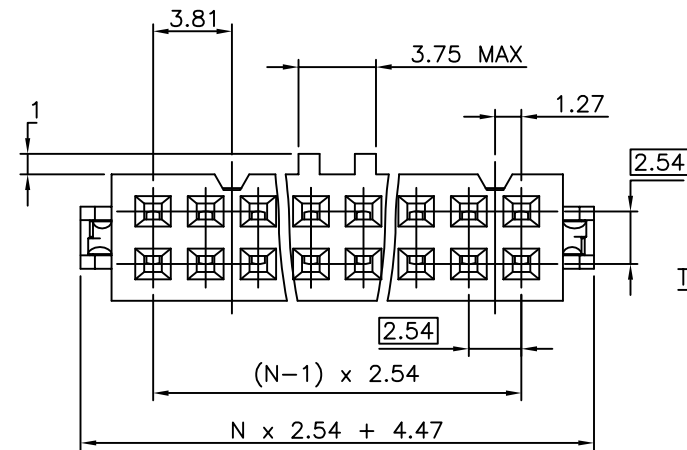
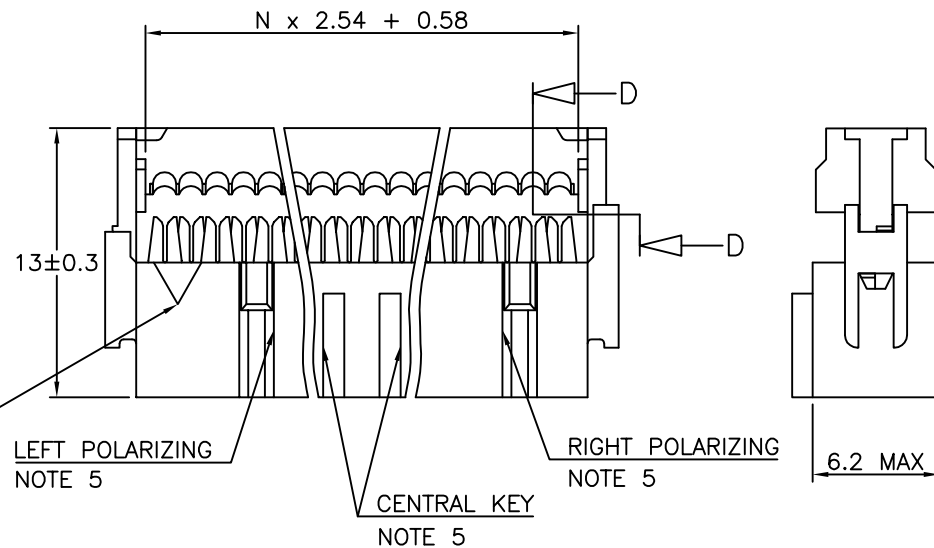

NOTES:

- 1 - PLASTIC MAT'L : GLASS FILLED HIGH TEMPERATURE THERMOPLASTIC. UL94V-0 COLOR: GREY
- 2 - PIN MATERIAL : PHOSPHOR BRONZE
- 3 - PRODUCT PACKAGED IN TUBES.
- 4 - TO DETERMINE DIMENSIONS :  
N = NUMBER OF POSITIONS PER ROW  
EXAMPLE : 8 POS N x 2.54 = 20.32mm
- 5 - 2x5, 2x6, 2x7 HAVE NO LEFT POLARIZING SLOT.  
- 2x2, 2x3 WITH CENTRAL KEY HAVE NO TRIANGLE, NO LEFT AND RIGHT POLARIZING SLOT.  
- 2x2 WITHOUT CENTRAL KEY HAS NO LEFT AND RIGHT POLARIZING SLOT.  
- 2x3, 2x4 WITHOUT CENTRAL KEY HAVE NO LEFT POLARIZING SLOT  
- 2x4 WITH CENTRAL KEY HAVE NO LEFT AND RIGHT POLARIZING SLOT
- 6 - THIS PRODUCT MEETS EUROPEAN UNION DIRECTIVES AND OTHER COUNTRY REGULATIONS AS PER GS-22-008.  
PACKAGING SPECIFICATION AS PER GS-14-920.

mat'l. code		surface		tolerance		projection		product family	
SEE NOTES		ISO 1302		ISO 406 ISO 1101		mm		2.54MM IDC	
ltr	ecn no	dr	date	tolerances unless otherwise specified		mm		title	
AP	F12-0046	LMU	12.04.25	angles	linear	X.X ±0.3	scale 5:1	QUICKIE III FEM	
AR	B-17851	LMU	14.06.05			X.XX ±0.13		0.76µm Au	
						X.XXX ±0.05			
AK	F05-0180	LMU	05.04.22	dr	D.LE	01.01.24	FCJ	dwg no	
AL	F06-0270	LMU	06.09.12	enr	P.NZ	01.01.24		sheet 1 of 2	
AM	F06-0274	LMU	06.09.25	chr	JF.N	01.01.24		71600	
AN	F09-0233	LMU	09.12.15	app	P.NZ	01.01.24		A3	
sheet	revision	AR	AF					type	
index	sheet	1	2					CUSTOMER Drawing	

STRAIN RELIEF OPTION AVAILABILITY	Nbr OF POSITIONS
1/6	04
0/1/2/3/6	06
0/1/2/3/6	08
0/1/2/3/6	10
0/1/2/3/6	14
0/1/2/3/6	16
0/1/2/3/6	18
0/1/2/3/6	20
0/1/3	24
0/1/2/3/6	26
0/1/2/3/6	30
0/1/2/3/6	34
0/1/2/3/6	40
0/1/2/3/6	50
0/1/2/3/6	60
0/1/2/3/6	64

624
304
204 / 224
004

PLATING  
0.76µm GOLD ON CONTACT AREA  
1.27 µm Ni REMAINDER OF PRODUCT

DASHES NOT AVAILABLE

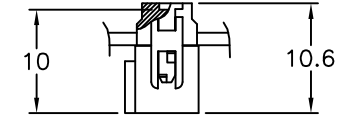

WITHOUT STRAIN RELIEF

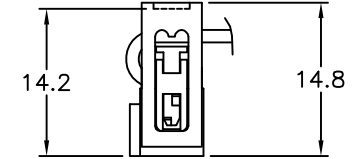

WITH LOW PROFILE STRAIN RELIEF

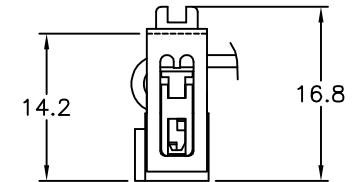

WITH STANDARD STRAIN RELIEF

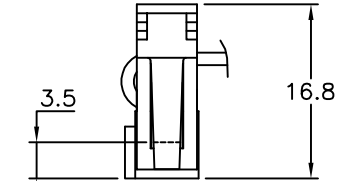

WITH LATCHING STRAIN RELIEF

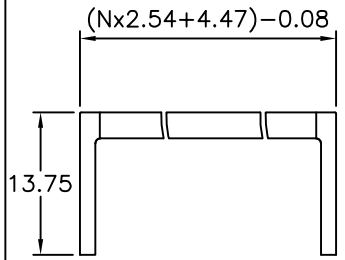

LOW PROFILE STRAIN RELIEF

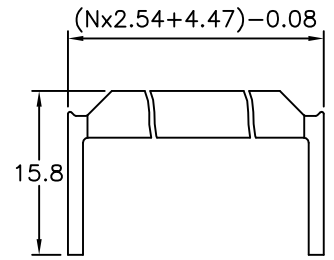

STANDARD STRAIN RELIEF

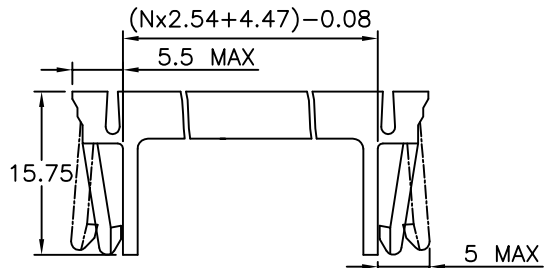

LATCHING STRAIN RELIEF FOR SLIM HEADER

71600-6YYLF	●					●
71600-3YYLF		●	●			
71600-2YYLF	●				●	
71600-1YYLF	●				●	
71600-0YYLF	●		●			
PRODUCT NUMBER	WITH CENTRAL KEY	WITHOUT CENTRAL KEY	STANDARD STRAIN RELIEF	WITHOUT STRAIN RELIEF	LOW PROFILE STRAIN RELIEF	LATCHING STRAIN RELIEF

mat'l. code		surface		tolerance		projection		product family	
		ISO 1302		ISO 406 ISO 1101		mm		QUICKIE	
ltr	ecn no	dr	date	tolerances unless otherwise specified		mm		title	
AF	B-17851	LMU	14.06.05	angles linear		scale N/A		IDC RECEPT DR	
AA	F10199	GCO	01.04.26					dwg no	
AB	F03019	DLE	03.01.23	dr	D.LE	01.01.24		sheet 2 of - size	
AC	F05-0180	LMU	05.04.22	engr	P.NZ	01.01.24		71600 A3	
AD	F06-0270	LMU	06.09.12	chr	JF.N	01.01.24		CUSTOMER Drawing	
AE	F06-0274	LMU	06.09.25	app	P.NZ	01.01.24			
sheet index	revision sheet								