



# HID-DynaVision Control for SON

HID-DVC 250 SON 220-240V 50/60Hz

HID-DynaVision Controller in combination with electromagnetic systems for SON lamp and continuous dimming

## Product data

### • General Characteristics

Interface	1-10V
Rated Number of Lamps	1 piece
Rated Ballast-Lamp Power	250
Rated Lamptype	SON
Line Voltage	220-240 V
Line Frequency	50/60 Hz
Suitable for Outdoor use?	Yes

### • Operating Characteristics

Inrush current Peak	3.6 (max) A
Inrush current Width	0.10 ms
Earth leakage current	0.5 mA
Mains voltage safety (AC)	-10%/+10%
Mains voltage performance (AC)	-8%/+6%
Overvoltage protection 320Vac	48 hr
Overvoltage protection 350Vac	2 hr
Overvoltage protection 380Vac	5 min
PowerFactor 100% output power	0.85 (min) -
Power losses gear	40 W

### • Wiring Characteristics

Connector type	Screw
Striplength	6.0 mm
Wcs Ballast contacts	0.70-2.50 mm <sup>2</sup>

### • Temperature Characteristics

T-case life	85 C
T-case maximum	85 (max) C
T-ambient	-20 (min), 50 (max) C
T-storage	-25 (min), 80 (max) C

### • Approval & Application Chars

EMI 30 MHz .. 1000MHz	EN 55022 level B [Level = Class]
CE marking	Yes
VDE-EMV certificate	Yes
CB Certificate	Yes

### • Product Dimensions

Length A1	116.0 mm
Fixing Hole Distance	108.0 mm
Length A2	
Length A3	10.0 mm
Width B1	50.0 mm
Fixing Hole Distance	42.0 mm
Width B2	
Height C1	38.0 mm
Fixing Hole Diameter D1	4.5 mm

### • Product Data

Order code	913700151095
Full product code	913700151095
Full product name	HID-DVC 250 SON 220-240V 50/60Hz
Order product name	HID-DVC 250 SON 220-240V 50/60Hz

# PHILIPS

sense and simplicity

# HID-DynaVision Control for SON

Pieces per pack 1  
Packing configuration 6  
Packs per outerbox 6  
Bar code on pack - EAN1 8711500748546

Bar code on outerbox - EAN3 8711500748553  
Logistic code(s) - 12NC 913700151095  
Net weight per piece 0.363 kg

## Dimensional drawing

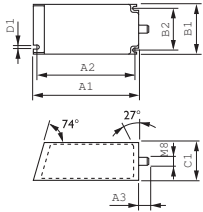

Product	A1 (Norm)	A2 (Norm)	A3 (Norm)	B1 (Norm)	B2 (Norm)	C1 (Norm)	D1 (Norm)
HID-DVC 250 SON 220-240V 50/60Hz	116.0	108.0	10.0	50.0	42.0	38.0	4.5

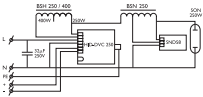

© 2011 Koninklijke Philips Electronics N.V.  
All rights reserved.

Specifications are subject to change without notice. Trademarks are the property of Koninklijke Philips Electronics N.V. or their respective owners.

[www.philips.com/lighting](http://www.philips.com/lighting)

2011, May 14  
data subject to change