

Aluminium Housed Proximity Switch - Normally Open Contacts
Part Number : PRA-SA-001
Product Data Sheet

PICTURE

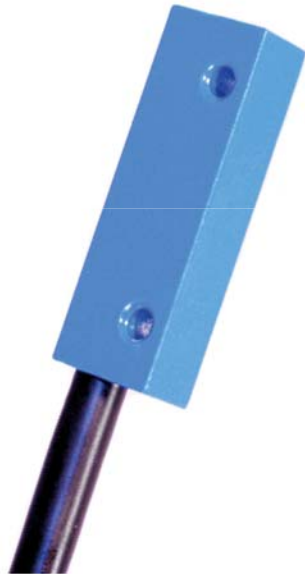

DIMENSIONS

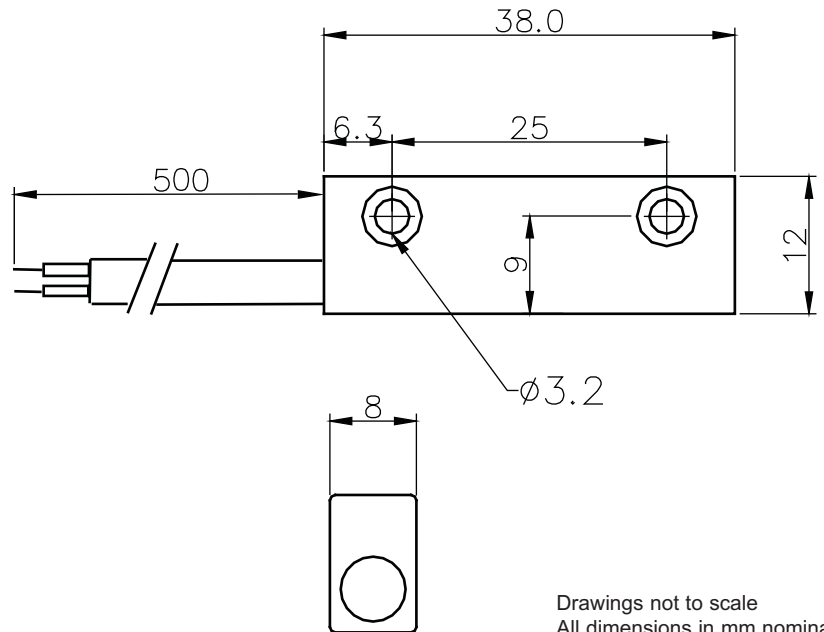

Drawings not to scale
 All dimensions in mm nominal

✓ RoHS Compliant

SPECIFICATION

Contact Form / Style		Normally open
Switching voltage	Max Volts	400 AC/DC
Switching Current	Max Amps	0.5
Switching Capacity	Max W/VA	10
Switching distance	Make	15mm (with recommended magnet PRM-SA-001)
	Break	20mm (with recommended magnet PRM-SA-001)
Carry Current	Max Amps	1.0
Contact Resistance	Max mOhms	150
Operating Temperature	Celsius	-20° to 85°
Case Material		Blue powder coated Aluminium
Cable		2 core 0.50mm ² Black PVC insulated, Brown / Blue

Applications Include

- Position sensing.
- Linear actuators.
- Security switching.
- Safety guards/devices

Options/Features

- Robust sealed switch, custom housings available.
- Changeover version available.
- Custom cable types, cable lengths, connectors or crimp terminals available.
- Hermetically sealed reed switch for long life.
- Powder coated housing for added corrosion resistance.

Did you know we also sell?



Rev. No.

Revision Note

Date

Signature

1

Datasheet

10-09-12

ML



As part of the company policy of continued product improvement, specifications may change without notice. Our sales office will be pleased to help you with the latest information on this product range and the details of our full design and manufacturing service. All products are supplied to our standard conditions of sale unless otherwise agreed in writing.

Phone : +44 (0)1255 862236

www.assemtech.co.uk

Fax: +44 (0)1255 862014

©2012 Copyright Assemtech Europe Ltd, Unit 7, Rice Bridge Industrial Estate, Thorpe - Le - Soken, Essex, CO16 0HL, ENGLAND.
 USA: Comus International:+1 973 777 6900, Belgium: Comus Belgium BVBA: +32 (0)12 390400

Aluminium Housed Proximity Switch - Normally Open Contacts

Part Number : PRA-SA-002

Recommended Magnet PRM-SA-003

Product Data Sheet

PICTURE



✓ RoHS Compliant

DIMENSIONS

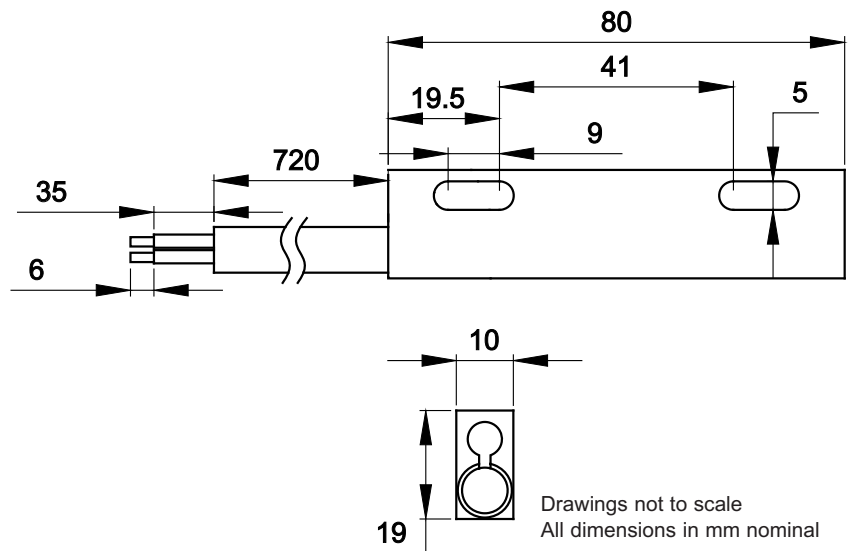

SPECIFICATION

Contact Form / Style		Normally open
Switching voltage	Max Volts	1500 AC/DC
Switching Current	Max Amps	3.0
Switching Capacity	Max W/VA	120
Switching distance	Make	15mm (with recommended magnet)
	Break	23mm (with recommended magnet)
Carry Current	Max Amps	5.0
Contact Resistance	Max mOhms	100
Operating Temperature	Celsius	-20° to 85°
Case Material		Blue powder coated Aluminium
Cable		3 core 0.75mm ² Black PVC insulated, Br / BI / G&Y

Applications Include

- Position sensing.
- Linear actuators.
- Security switching.
- Safety guards/devices

Options/Features

- Robust sealed switch, custom housings available.
- Changeover version available.
- Custom cable types, cable lengths, connectors or crimp terminals available.
- Hermetically sealed reed switch for long life.
- Earthed housing for added safety.

Did you know we also sell?



Rev. No.

2

Revision Note

Image/logo update

Date

22-11-13

Signature

ML



As part of the company policy of continued product improvement, specifications may change without notice. Our sales office will be pleased to help you with the latest information on this product range and the details of our full design and manufacturing service. All products are supplied to our standard conditions of sale unless otherwise agreed in writing.

Phone : +44 (0)1255 862236

www.comus-group.com

Fax: +44 (0)1255 862014