

**TECHNICAL SPECIFICATIONS**

**D-Sub Hood:**

Material: Zinc, Nickel Plated  
 Operating Temperature: -45°C to + 105°C  
 Cable Entry: Top Entry  
 Thumbscrews: UNC 4-40 (Standard)  
 Cable O.D:  
 9-Way: Up to 9,5mm  
 15-Way: Up to 12,5mm  
 25-Way: Up to 12,5mm  
 37-Way: Up to 15,5mm

**D-Sub High Density:**

Insulator: PBT, Black, UL94 V-0  
 Shell: Stamped Steel, Tin Plated  
 Contact pins: Copper Alloy  
 Stamped & Formed pins: 100 inserts min  
 Contacts Plating: Selective Gold over Nickel  
 Operating Temperature: -55°C to +105°C  
 Withstanding voltage: 500V for 1 minute  
 Insulator resistance: 500MΩ min

**Features:**

- Available in sizes HD15-26-44-62
- Excellent EMI Shielding
- Re-openable
- Spring-Clip mounted Jackscrews

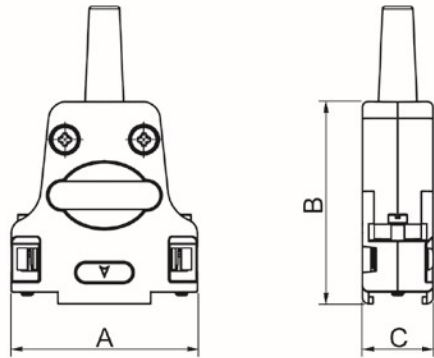

Size DTZF	Dim A	Dim B	Dim C
9-way	31,6	39,5	15,2
15-way	40,0	41,0	15,2
25-way	53,7	47,5	15,2
37-way	70,2	48,0	15,2

**Ordering information:**

**Class 3 D-Sub Connector Kits (100 inserts min.)**

Size:	P/N - Kitted:	Product Code - MALE Conn. Kit
HD 15	6355-0063-01	DTZF09-HDP15-K
HD 26	6355-0063-02	DTZF15-HDP26-K
HD 44	6355-0063-03	DTZF25-HDP44-K
HD 62	6355-0063-04	DTZF37-HDP62-K

Size:	P/N - Kitted:	Product Code - FEMALE Conn. Kit
HD 15	6355-0063-11	DTZF09-HDS15-K
HD 26	6355-0063-12	DTZF15-HDS26-K
HD 44	6355-0063-13	DTZF25-HDS44-K
HD 62	6355-0063-14	DTZF37-HDS62-K

