

# Signal Towers KombiSIGN

## Signals to combine – At the twist of a hand



- ✓ Signal elements in every common voltage
- ✓ Modular system allows combination as required
- ✓ High protection rating IP 54 or IP 65
- ✓ Wide range of optical and audible elements
- ✓ LED technology ensures even better visibility
- ✓ New attention-grabbing light effects (e.g. EVS)



### KombiSIGN 71

#### Protection Rating IP 65

Modular signal tower system with 70 mm diameter for use in extreme conditions.

Not compatible with KombiSIGN 70

#### Terminal Element



Either: improved screw terminal



Or: terminal element with CAGE CLAMP® technology



Cylindrical terminal element

See page 16.



### KombiSIGN 70

#### Protection Rating IP 54

Modular signal tower system with 70 mm diameter for use in normal conditions.

Not compatible with KombiSIGN 71

#### Terminal Element



Screw terminal



Conical terminal element

See page 36.



### KombiSIGN 50

#### Protection Rating IP 54

Modular signal tower system with 50 mm diameter for use on smaller machines.

#### Terminal Element



Screw terminal

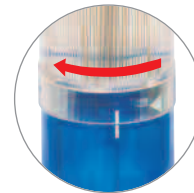

Practical bayonet fixing system tool-free bulb-change.

See page 54.





## Simple operation thanks to bayonet mechanism



WERMA was the first signal beacon manufacturer to offer a bayonet mechanism allowing elements to be mechanically and electrically connected within seconds.

- ✓ Simple mounting and removal of the elements
- ✓ New combinations at the twist of a hand
- ✓ Tool-free bulb change

## A fitting solution for every mounting requirement

The comprehensive range of accessories for KombiSIGN signal towers offers solutions for the most diverse mounting needs and exceeds the industry standards in this respect.

Besides the wide choice of brackets, bases and tubes WERMA also offers unique special solutions, for example the Foldaway Base, the Tube with Clamp or the Indication Board.

You will find an overview of the entire range of accessories for KombiSIGN Signal Towers on pages 60 and 61.



KombiSIGN Signal Tower with Foldaway Base



Indication board for the addition of instructions

## Safe and efficient connection thanks to CAGE CLAMP® technology

Terminal elements with CAGE CLAMP® technology enable leads to be quickly and easily wired, guaranteeing a secure and reliable contact.

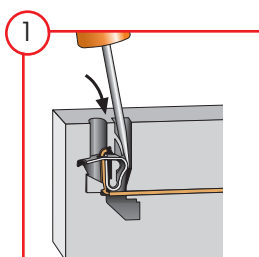

1 Insert screwdriver at a slight angle into opening as far as possible.

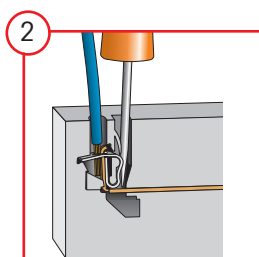

2 Open spring-loaded clamp with the help of the screwdriver and insert wire as far as possible

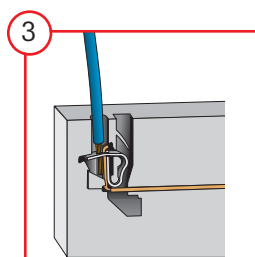

3 Remove screwdriver – the wire is firmly clamped.

CAGE CLAMP® is a registered trademark of WAGO Kontakttechnik GmbH.



# Signal Tower KombiSIGN 71

This is how you can assemble your KombiSIGN 71 signal tower!

► **STEP 1**

Select the required optical or audible elements.

Many KombiSIGN highlights are also available (for details see page 17).



**Audible Signal Elements**

- Buzzer Element
- Siren Element
- Vocal Element

**Optical Signal Elements**

- (LED) Permanent Light
- LED Permanent Light ultrabright
- (LED) Flashing Light
- LED EVS Element
- LED Blinking Light
- LED Rotating Light

**NEW**

► **STEP 2**

Select the appropriate mounting option for your application.

► **STEP 3**

Select the correct terminal element for your mounting option.

**Base Mounting**



Improved screw terminal  
Order no. **640 820 00**

Terminal element with CAGE CLAMP® technology  
Order no. **640 800 00**

**Tube Mounting**



Improved screw terminal  
Order no. **640 830 00**

Terminal element with CAGE CLAMP® technology  
Order no. **640 810 00**









► **STEP 4**

Where appropriate, select a base and the desired tube length (only for tube mounting).

 <p>Tube with clamp Order no. <b>960 000 18</b></p>	 <p>Adaptor for single hole mounting Order no. <b>960 000 25</b></p>	 <p>Base with integrated tube Order no. <b>975 840 10</b></p>	<p>Tube Ø 25 mm, all anodized Order no.</p> <table border="0"> <tr><td>100 mm long</td><td><b>975 845 10</b></td></tr> <tr><td>250 mm long</td><td><b>975 840 25</b></td></tr> <tr><td>400 mm long</td><td><b>975 840 40</b></td></tr> <tr><td>600 mm long</td><td><b>975 840 60</b></td></tr> <tr><td>800 mm long</td><td><b>975 840 80</b></td></tr> <tr><td>1000 mm long</td><td><b>975 840 03</b></td></tr> </table>  <p>Base for Tube, plastic Order no. <b>975 840 90</b></p>  <p>Base for Tube, metal Order no. <b>975 840 91</b></p>  <p>Foldaway Base Order no. <b>960 000 30</b></p>  <p>Tube Ø 25 mm, plastic, only for Foldaway Base, 45 mm long Order no. <b>960 000 31</b></p> 	100 mm long	<b>975 845 10</b>	250 mm long	<b>975 840 25</b>	400 mm long	<b>975 840 40</b>	600 mm long	<b>975 840 60</b>	800 mm long	<b>975 840 80</b>	1000 mm long	<b>975 840 03</b>
100 mm long	<b>975 845 10</b>														
250 mm long	<b>975 840 25</b>														
400 mm long	<b>975 840 40</b>														
600 mm long	<b>975 840 60</b>														
800 mm long	<b>975 840 80</b>														
1000 mm long	<b>975 840 03</b>														

► **STEP 5**

Where appropriate, select the bracket and the contact box.

 <p>Contact box for cable exit at side Order no. <b>975 840 01</b></p>	 <p>Bracket for base mounting Order no. <b>960 000 02</b></p>	 <p>Contact box for cable exit at side Order no. <b>975 840 01</b></p>	 <p>Contact box with magnetic base and cable exit at side Order no. <b>975 840 04</b></p>
 <p>Bracket for 1-sided mounting Order no. <b>975 840 85</b></p>	 <p>Bracket for 2-sided mounting Order no. <b>975 840 86</b></p>	 <p>Bracket for base mounting with concealed cable entry Order no. <b>960 000 14</b></p>	 <p>Bracket for tube mounting Order no. <b>960 000 01</b></p>

**TIP**

The Signal Devices Site on the Internet:  
[www.werma.com](http://www.werma.com)

With our new **signal tower configurator** you can put together your own individual signal tower.

# The Highlights for KombiSIGN 71

**NEW**

## WIN – Wireless Information Network



- Economical wireless-based Machine Data Collection system (MDC system)
- Central monitoring of a wide range of different machines via PC

See page 24

**NEW**

## KombiSIGN reflect



- Simple monitoring of signal towers out of view
- Signal tower "reflection" to a central location

See page 23

## GSM Transmitter Element

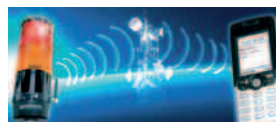

- Malfunction signalled by signal tower is transmitted via SMS or call to a mobile phone
- Activation without the need for programming
- No additional power supply needed

See page 26

## AS-Interface Element



- LEDs indicate current status
- 31 or 62 addresses
- Available with standard or A/B technology

See page 27

**NEW**

## LED Permanent Light Element ultrabright



- Up to 20 times brighter than conventional LED elements
- Maximum brightness via intelligent LED control

See page 28

## LED Flashing Light Element



- Extremely long life duration up to 50,000 hrs
- Low current consumption
- Shock-proof and vibration resistant

See page 18

## LED EVS Element



- Attention-grabbing flickering light
- Extremely powerful signal effect
- Random sequence of light signals prevents acclimatisation effect

See page 29

## Vocal Element



- Plays customer-specific audio files in mp3 format (sounds, alarms, music or spoken text)
- Easy programming via USB interface
- Up to 60 minutes replay capacity

See page 30

## Siren Element with self-adjusting sound output



- Sound output is automatically adjusted to the background noise level
- Warning tone can be heard without being irritatingly loud

See page 31

## Terminal Element with USB Interface



- Direct triggering of signal tower elements via USB Interface
- Easy activation

See page 32

## Customer-specific coloured coatings



- Signal towers in customer-specific colours – complete range of RAL colours available
- Meets the demands of an increasing design orientation

See page 33

## Foldaway base



- Enables signal towers to be folded down completely, even when connected
- Vertical alignment of signal towers even on sloping surfaces

See page 35

640

## Signal Tower KombiSIGN 71



Bracket (accessory)



Base with tube (accessory)

- High protection rating IP 65
- Signal tower system 70 mm Ø with modular construction
- Improved illumination
- Flexible combination of optical and audible elements

**i TECHNICAL SPECIFICATIONS:**

<b>Dimensions</b> (Ø x Height):	Terminal element: 70 mm x 26.5 mm Light element: 70 mm x 65 mm Audible element: 70 mm x 72/79/111 mm
<b>Housing:</b>	Terminal element: PA fibreglass, high-impact Cap: PC
<b>Lens:</b>	PC, transparent Audible and ASI elements: PC
<b>Fixing:</b>	Base mounting Tube mounting, for tube Ø 25 mm Bracket mounting (accessory)
<b>Socket:</b>	Bayonet, B15d, for bulbs max. 7 W
<b>Connection:</b>	CAGE CLAMP® technology max. 2.5 mm <sup>2</sup> or screw terminal max. 2.5 mm <sup>2</sup> Contact protection according to VDE
<b>Cable entry:</b>	Cable diameter max. 14 mm
<b>Element seal:</b>	Pre-mounted with each module
<b>Protection rating:</b>	Light elements: IP 65 Audible elements: IP 65 (Order no. 645 830 55 = IP 40)
<b>Number of modules possible:</b>	Max. 5 / max. 10 elements with 2-sided bracket
<b>Permanent light element</b>	12 - 240 V≈ Bulb not included in assembly.
<b>LED Permanent light element</b>	24 V≈ 115 V~ 230 V~ Current consumption: < 30 mA < 20 mA < 20 mA
<b>NEW LED Permanent light element ultrabright</b>	24 V≈ Life duration: Up to 50,000 hrs Current consumption: Max. 190 mA Up to 20 times brighter than conventional LED beacons.
<b>Flashing light element (Xenon)</b>	24 V≈ 115 V~ 230 V~ Life duration: 4 x 10 <sup>6</sup> flashes Current consumption: 125 mA 22 mA 15 mA Reduced for AS-Interface: 80 mA Flash frequency: c. 1 Hz
<b>LED Flashing light element</b>	24 V≈ Life duration: 50,000 hrs Current consumption: < 30 mA (red/yellow) < 25 mA (green/clear/blue) Flash frequency: c. 1 Hz (Double Flash)
<b>LED EVS* element</b>	24 V≈ Current consumption: 350 mA (red/yellow) 250 mA (green/clear/blue) * EVS = Enhanced Visibility System
<b>LED Blinking light element</b>	24 V≈ 115 V~ 230 V~ Current consumption: 25 mA 25 mA 25 mA Blink frequency: c. 1 Hz
<b>LED Rotating light element</b>	24 V≈ Current consumption: 70 mA Rotation frequency: c. 120 r.p.m.

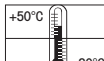
Improved  
light effect

24 V





(LED) Permanent/Flashing element



Permanent light, clear with info



LED EVS element



LED element

Life duration  
up to 50,000 hrs

**ORDER SPECIFICATIONS OPTICAL ELEMENTS:**

<b>Permanent light element</b>	12-240 V≈			
red	641 100 00			
green	641 200 00			
yellow	641 300 00			
clear	641 400 00			
blue	641 500 00			
Bulb not included in assembly. Accessories see page 22.				
<b>LED Permanent light element</b>	24 V≈	115 V~	230 V~	
red	644 100 75	644 100 67	644 100 68	
green	644 200 75	644 200 67	644 200 68	
yellow	644 300 75	644 300 67	644 300 68	
clear	644 400 75	644 400 67	644 400 68	
blue	644 500 75	644 500 67	644 500 68	
<b>NEW LED Permanent light element ultrabright</b>	24 V≈			
red	644 180 55			
green	644 280 55			
yellow	644 380 55			
clear	644 480 55			
blue	644 580 55			
<b>Flashing light (Xenon)</b>	24 V= (ASI)	24 V=	115 V~	230 V~
red	643 110 55	643 100 55	643 100 67	643 100 68
green	643 210 55	643 200 55	643 200 67	643 200 68
yellow	643 310 55	643 300 55	643 300 67	643 300 68
clear	643 410 55	643 400 55	643 400 67	643 400 68
blue	643 510 55	643 500 55	643 500 67	643 500 68
<b>LED Flashing light element</b>	24 V≈			
red	644 120 55			
green	644 220 55			
yellow	644 320 55			
clear	644 420 55			
blue	644 520 55			
<b>LED EVS element</b>	24 V≈			
red	644 140 55			
green	644 240 55			
yellow	644 340 55			
clear	644 440 55			
blue	644 540 55			
<b>LED Blinking light element</b>	24 V≈	115 V~	230 V~	
red	644 110 75	644 110 67	644 110 68	
green	644 210 75	644 210 67	644 210 68	
yellow	644 310 75	644 310 67	644 310 68	
clear	644 410 75	644 410 67	644 410 68	
blue	644 510 75	644 510 67	644 510 68	
<b>LED Rotating light element</b>	24 V≈			
red	644 130 75			
green	644 230 75			
yellow	644 330 75			
clear	644 430 75			
blue	644 530 75			

Compare the prices  
and advantages of  
an LED Flashing light

Improved  
light effect

Further voltages on request.

**TECHNICAL DIAGRAMS:**

see page 277 onwards



640

## Signal Tower KombiSIGN 71



Audible element



Siren element with self-adjusting sound output



Terminal element with cap



Vocal element



GSM transmitter element



## ORDER SPECIFICATIONS AUDIBLE ELEMENTS:

<b>Buzzer element</b> 85 dB, 25 mA, IP 65, Continuous or pulse tone	24 V~ <b>645 800 75</b>	115 V~ <b>645 800 77</b>	230 V~ <b>645 800 68</b>
<b>Siren element</b> 105 dB, 150 mA, IP 40 Continuous tone alternating	24 V== <b>645 830 55</b> no UL approval		
<b>Multi-functional Siren</b> 100 dB, IP 65, 8 different tones, adjustable sound output	24 V~ / 80 mA <b>645 820 75</b>	115 V~ / 40 mA <b>645 820 67</b>	230 V~ / 40 mA <b>645 820 68</b>
<b>Multi-functional Siren, can be triggered externally</b> 100 dB, 80 mA, IP 65, 7 diff. tones can be triggered externally, adjustable sound output, number of tones depending on the number of optical elements.	24 V== <b>645 850 55</b>		
<b>Siren element with self-adjusting sound output</b> Technical specifications see page 31.	24 V== <b>645 810 55</b>		



## ORDER SPECIFICATIONS TERMINAL ELEMENTS :

<b>Terminal element for tube mounting including cap</b>	<b>CAGE CLAMP®</b> <b>640 810 00</b>	<b>Screw terminal</b> <b>640 830 00</b>
<b>Terminal element for bracket or base mounting including cap and seal</b>	<b>640 800 00</b>	<b>640 820 00</b>
<b>Terminal element with USB Interface (for tube mounting)</b> Technical specifications see page 32.	<b>640 840 00</b>	



## ORDER SPECIFICATIONS KOMBISIGN-HIGHLIGHTS:

<b>NEW</b> WIN system for KombiSIGN 71 Technical specifications see page 24.	<b>860 640 01</b>	
<b>NEW</b> WIN complete for KombiSIGN 71 Technical specifications see page 24.	<b>860 640 03</b>	
<b>NEW</b> WIN slave for KombiSIGN 71 Technical specifications see page 24.	<b>860 640 02</b>	
<b>NEW</b> KombiSIGN 71 reflect Technical specifications see page 23.	<b>861 640 01</b>	
<b>GSM Transmitter Element for KombiSIGN 71</b> Technical specifications see page 26.	24 V== <b>646 700 55</b>	
<b>Vocal Element for KombiSIGN 71</b> Technical specifications see page 30.	24 V== <b>645 840 55</b>	
<b>AS-Interface Element for KombiSIGN 71</b> Technical specifications see page 27.	Standard Slave 24 V== <b>646 830 55</b>	A/B-Slave 24 V== <b>646 810 55</b>

# Accessories for Signal Tower KombiSIGN 71



## ORDER SPECIFICATIONS ACCESSORIES:

Contact box for cable exit at side, with mounting material	975 840 01
Contact box with magnetic base and cable exit at side	975 840 04
Bracket for tube mounting with cable gland	960 000 01
Bracket for surface mounting with cable gland	960 000 02
Bracket for base mounting with concealed cable entry, incl. rubber seals	960 000 14
Bracket for 1-sided mounting, incl. rubber seals	975 840 85
Bracket for 2-sided mounting, incl. rubber seals	975 840 86
Tube with clamp, Ø 25 mm 250 mm long, with cable gland	960 000 18
Tube Ø 25 mm, all anodized aluminium	
100 mm long	975 845 10
250 mm long	975 840 25
400 mm long	975 840 40
600 mm long	975 840 60
800 mm long	975 840 80
1000 mm long	975 840 03
Foldaway Base incl. rubber seals, suitable for tube, Ø 25 mm, all anodized aluminium (Technical specifications see page 35)	960 000 30
Tube Ø 25 mm, plastic for mounting the Terminal Element directly on the Foldaway Base	960 000 31
Base for tube mounting Ø 25 mm, plastic, incl. rubber seal	975 840 90
Base for tube mounting Ø 25 mm, metal, incl. rubber seal, recommended for tube lengths of 400 mm and longer	975 840 91
Base with integrated tube, Ø 25 mm, 110 mm long, plastic, incl. rubber seal	975 840 10
Adaptor for tube mounting, Ø 25 mm / 1/2" NPT thread	975 840 02
Adaptor for single hole mounting Ø 25 mm, M 18	960 000 25
Cable gland for surface mounting M 16 x 1.5 mm	960 000 04

## TECHNICAL DIAGRAMS:

see page 292 onwards



# Accessories for Signal Tower KombiSIGN 71

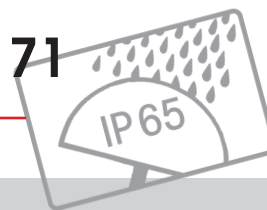

## ORDER SPECIFICATIONS ACCESSORIES:



Bulb BA15d, total length max. 42 mm  
(for permanent light 641)

12 V, 5 Watt	<b>955 840 34</b>
24 V, 5 Watt	<b>955 840 35</b>
30 V, 5 Watt	<b>955 840 32</b>
115 V, 5 Watt	<b>955 840 57</b>
230 V, 5 Watt	<b>955 840 38</b>



LED bulb BA15d, total length max. 42 mm  
(for permanent light 641)

Voltage	24 V ~	115 V ~	230 V ~
Current consumption	< 45 mA	< 15 mA	< 15 mA
red	<b>956 100 75</b>	<b>956 100 67</b>	<b>956 100 68</b>
green	<b>956 200 75</b>	<b>956 200 67</b>	<b>956 200 68</b>
yellow	<b>956 300 75</b>	<b>956 300 67</b>	<b>956 300 68</b>
white	<b>956 400 75</b>	<b>956 400 67</b>	<b>956 400 68</b>
blue	<b>956 500 75</b>	<b>956 500 67</b>	<b>956 500 68</b>

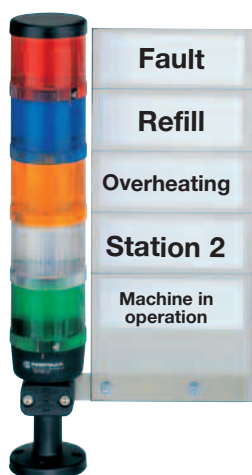

### Indication Board

- Indication Board for one to five modules
- Simple mounting onto signal tower tube
- Ample space for written information
- Simply break off unwanted segments

Dimensions of indication board (W x H):	153 x 345 mm
Surface area per section (W x H):	c. 140 x 50 mm
Material:	PMMA
Assembly:	Indication board (5 sections) incl. mounting material
Mounting:	Fixing only possible on 25 mm diameter tube
Indication board	<b>960 000 05</b>

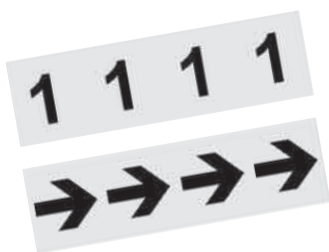

Info transparencies: To place inside optical elements, not for use in Flashing Light, LED EVS, LED Flashing Light and LED Permanent Light Element ultrabright.

neutral	<b>975 840 49</b>	number „6“	<b>975 840 56</b>
number „0“	<b>975 840 50</b>	number „7“	<b>975 840 57</b>
number „1“	<b>975 840 51</b>	number „8“	<b>975 840 58</b>
number „2“	<b>975 840 52</b>	number „9“	<b>975 840 59</b>
number „3“	<b>975 840 53</b>	number „10“	<b>975 840 92</b>
number „4“	<b>975 840 54</b>	arrow	<b>975 840 62</b>
number „5“	<b>975 840 55</b>		



## ADDITIONAL INFORMATION:

You will find an overview of the entire range of accessories for KombiSIGN Signal Towers on pages 60 and 61.



## TECHNICAL DIAGRAMS:

see page 292 onwards

**NEW**



The slave sends the status directly to the master, and reflects the status of the signal tower installed on the machine

- Simple monitoring of signal towers out of view
- Signal tower "reflection" to a central location
- Shortening of reaction times and reduction of costs
- KombiSIGN reflect is integrated into existing WERMA signal towers
- No additional wiring costs
- Simple commissioning due to pre-configured modules

**i TECHNICAL SPECIFICATIONS:**

**Slave**

Dimensions (Ø x Height):	70 mm x 65.5 mm
Housing:	PC, black
Connection:	Bayonet
Operating voltage:	24 V ≈
Current consumption:	40 mA

**Master**

Dimensions (Ø x Height):	70 mm x 65.5 mm (without antenna)
Housing:	PC, black
Connection:	Bayonet
Operating voltage:	24 V =
Current consumption:	40-90 mA

**Wireless connection**

ISM frequency:	868 MHz (KombiSIGN reflect conforms to the EU's EN 300220 harmonised standard and can thus be used in all EU member countries. Further countries upon request.)
Transmission range:	Up to 300 m (unobstructed line of sight)



Remote transmission via wireless signal with a maximum range of up to 300 m (unobstructed line of sight)

**ORDER SPECIFICATIONS:**

KombiSIGN 71 reflect	861 640 01
----------------------	------------

**ADDITIONAL INFORMATION:**

**Signal tower "reflection"**

WERMA Signaltechnik provides a simple solution for the remote wireless monitoring of machinery. The new "KombiSIGN reflect" kit can be integrated into existing signal towers which are already installed on your machines. KombiSIGN reflect "reflects" the status of the machine to a signal tower within your line of sight.

This enables you to wirelessly monitor machines situated at a greater distance and respond quickly to malfunctions. With KombiSIGN reflect, even machines which were not previously network-capable can now be remotely monitored.

Further information can be found in the chapter "Tech-Talk" on page 324.

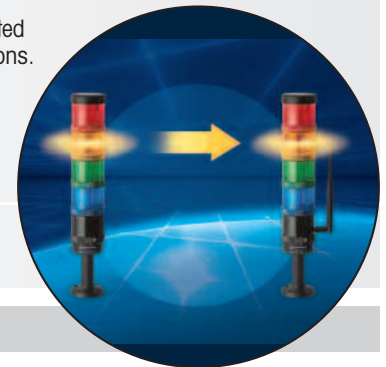

Simple monitoring of signal towers out of view



Simply fit the KombiSIGN reflect slave to the signal tower on the machine

**TECHNICAL DIAGRAMS:**

see page 289

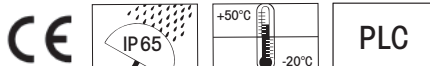

NEW



"WIN system" is immediately ready for use: Fit the slaves in the existing signal towers and connect the master to the PC

- Economical wireless-based Machine Data Collection system (MDC system)
- Central monitoring of a wide range of different machines via PC
- Relevant machine information at a glance
- Reduction of reaction times, repair and maintenance requirements and costs
- No additional wiring as existing WERMA signal towers can be used
- Downtime analysis



#### TECHNICAL SPECIFICATIONS:

Patent pending

##### WIN slave

Dimensions (Ø x Height):	70 mm x 65.5 mm
Housing:	PC, black
Connection:	Bayonet
Operating voltage:	24 V ≈
Current consumption:	40 mA

##### WIN master

Dimensions (L x H x W):	76 mm x 30 mm x 80 mm (without antenna)
Housing:	ABS, black
Connection:	Via USB
Operating voltage:	Via USB
Current consumption:	< 100 mA
Suitable for:	Windows 2000, Windows XP, Windows Vista, Windows 7



The all inclusive kit for KombiSIGN 71: "WIN complete" consists of three pre-configured signal towers and the master

##### Wireless connection

ISM frequency:	868 MHz (WIN conforms to the EU's EN 300220 harmonised standard and can thus be used in all EU member countries. Further countries upon request.)
Transmission range:	Up to 300 m (unobstructed line of sight) Every slave simultaneously functions as a "repeater", enabling the transmission range to be significantly increased.

##### WIN complete

With the all inclusive kit "WIN complete" you can immediately start monitoring up to three machines. All you have to do is mount the signal towers from the kit onto your machines. After installing the supplied software on to your PC you can immediately start monitoring the status of your machines.



Expandable at any time: With additional "WIN slaves" up to 50 machines can be integrated into the network

Assembly:	WIN master, 3 WIN slaves for KombiSIGN 71 (pre-configured), 3 KombiSIGN 71 signal towers (LED permanent light elements in red, yellow and green, terminal element, base with integrated tube), software
-----------	---

##### WIN system

With "WIN system" the user has even more choice: The kit consists of a WIN master including the software, a USB cable and three pre-configured WIN slaves. The slaves are fitted to the existing WERMA signal towers which need to be monitored. Or you can order your own signal towers from WERMA's wide range of KombiSIGN products - enabling you to combine audible elements, different light effects, colours and mounting options as required.

Assembly:	WIN master, 3 WIN slaves for KombiSIGN 71 (pre-configured), Software
-----------	--



With the supplied software, users can wirelessly monitor their machinery via PC



The software displays the status of the signal towers integrated into wireless network



### ORDER SPECIFICATIONS:

WIN system for KombiSIGN 71 860 640 01

Assembly: WIN master, 3 WIN slaves KombiSIGN 71 (pre-configured), Software

WIN complete for KombiSIGN 71 860 640 03

Assembly: WIN master, 3 WIN slaves for KombiSIGN 71 (pre-configured), 3 KombiSIGN signal towers (LED permanent light elements in red, yellow and green, terminal element, base with integrated tube), software

WIN slave for KombiSIGN 71 860 640 02

To expand WIN complete or WIN system.

Both networks can be expanded to up to 50 WIN slaves per network as required.



### ADDITIONAL INFORMATION:

\* WIN = Wireless Information Network

The "Wireless Information Network", "WIN" for short, is a simple MDC system (Machine Data Collection system).

WIN enables you to centrally monitor and evaluate the performance of up to fifty machines of varying ages and functions via wireless technology. Even machines which were not previously network-capable can now be integrated into networks.

#### Software for monitoring and analysing the machine operating status

With the supplied software, users can wirelessly monitor machinery on their Pc.

They can search for faults or analyse the operating status, thus raising the efficiency and productivity of their machines.

#### Examples:



Module 1: Status indication of the networked signal towers

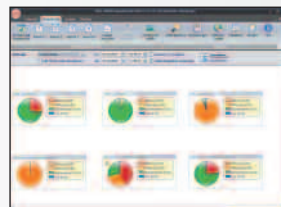

Module 2: Productivity per machine

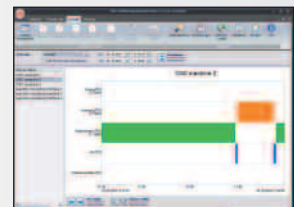

Module 3: Failure analysis over time

Further informationen can be found in the chapter „Tech-Talk“ beginning on page 320.



### TECHNICAL DIAGRAMS:

see page 288

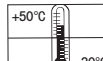



646

# GSM Transmitter Element for KombiSIGN 71

Patent approved



- Unique Signal Tower solution
- GSM transmitter element can be simply integrated into an existing signal tower
- Activation without the need for programming
- Malfunction signalled by signal tower is transmitted via SMS to a mobile phone
- No additional power supply
- Also suitable for US frequencies (Quadband)

**i TECHNICAL SPECIFICATIONS:**

Dimensions (Ø x Height):	70 mm x 65.5 mm (without antenna)
Housing:	PC
Current consumption:	50 mA
Max. current draw (momentary):	450 mA
GSM frequency:	850, 900, 1800/1900 MHz
Plug-in slot for SIM card:	Integrated (SIM card is not included in assembly)
Antenna connection:	FME plug connector (bracket antenna included)



Also suitable for US frequencies

**🛒 ORDER SPECIFICATIONS:**

GSM Transmitter Element	24 V =
	646 700 55

**📏 TECHNICAL DIAGRAMS:**

see page 278

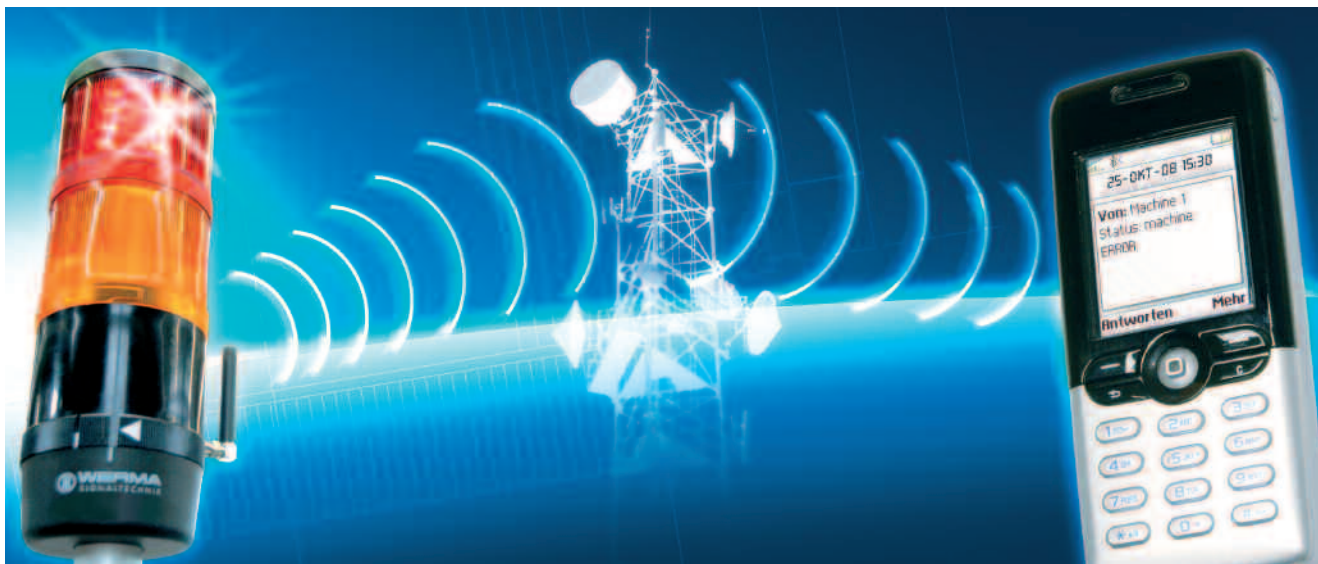

Class 2



# AS-Interface Element for KombiSIGN 71



Cable not included in assembly

LEDs display the  
current status

- LEDs indicate current status
- 31 or 62 addresses
- Available with standard or A/B technology
- Voltage supply switchable from internal bus supply to additional external voltage supply
- With addressing socket

## **i** TECHNICAL SPECIFICATIONS:

	Standard Slave	A/B-Slave
Number of addresses:	Max. 31	Max. 62
Number of signal elements:	Max. 4	Max. 3
IO-Code:	8	8
ID-Code:	F	A
ID2-Code:	–	E
Outputs:	4 semiconductor relays	3 semiconductor relays
Approved in accordance with:	Spec. V 3.0	Spec. V 3.0

### Specif. Power supply

AS-Interface Element:	Via bus conduction
Operating voltage:	25 V ... 31.6 V according to the AS-Interface specification
Reverse battery protection:	Integrated
Watchdog:	Integrated
Additional external voltage:	24 V $\overline{\text{m}}$

	With internal add. voltage	With external add. voltage
Current carrying cap. $\Sigma$ I <sub>max</sub> :	200 mA	200 mA per signal element
Current consumption max:	250 mA	75 mA
Voltage at signal element:	18 V - 31 V	24 V +/- 10%
Short circuit/overload protection:	Integrated	Pre-fuse M 1.6 A

## **🛒** ORDER SPECIFICATIONS:

AS-Interface Element	Standard Slave	A/B-Slave
	<b>646 830 55</b>	<b>646 810 55</b>

## **⚠️** ADDITIONAL INFORMATION:



The KombiSIGN Signal Towers 70 and 71 with AS-Interface Element are capable of total communication: Through simple integration of an AS-Interface Element the actuators are connected to the networking system Actuator-Sensor-Interface – this considerably reduces complex wiring. The necessary power supply (supply via bus or external) can be selected with a switch. This element is mounted as the first tier of the individual signal tower directly on top of the terminal element. (Further Information see page 319).

## **📐** TECHNICAL DIAGRAMS:

see page 278

Class 2

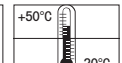
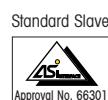



- Up to 20 times brighter than conventional LED elements
- Extremely good visibility – even in direct sunlight
- Life duration up to 50,000 hrs
- Maximum brightness via intelligent LED control
- Low current consumption and maintenance-free
- Shock-proof and vibration-resistant

Life duration  
up to 50,000 hrs

## TECHNICAL SPECIFICATIONS:

Dimensions (Ø x Height):	70 mm x 65.5 mm
Lens:	PC, transparent
Seal:	Pre-mounted with each element
Number of modules possible:	5, with 2-sided bracket max. 10
Current consumption:	Max. 190 mA

## ORDER SPECIFICATIONS:

LED Permanent light element ultrabright 24 V =	
red	<b>644 180 55</b>
green	<b>644 280 55</b>
yellow	<b>644 380 55</b>
clear	<b>644 480 55</b>
blue	<b>644 580 55</b>



Maximum brightness via  
intelligent LED control

## ADDITIONAL INFORMATION:

### Sophisticated triggering

Thanks to its sophisticated triggering, the innovative LED element "ultrabright" is up to 20 times brighter than conventional LED elements – making it almost certainly the brightest permanent light that the world of signalling technology currently has to offer.

Furthermore, the intelligent electronics ensure that the LEDs operate at maximum brightness, depending on the ambient and operating temperatures. The "ultrabright" LED element is therefore always working at its optimum, and the energy-saving LED technology ensures that power consumption is kept to a minimum.

Further information can be found in the chapter "Tech-Talk" beginning on page 325.

## TECHNICAL DIAGRAMS:

see page 277



The high level of brightness  
guarantees good visibility –  
even in direct sunlight

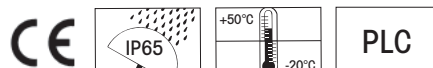

Patent pending



Integrated into the KombiSIGN Signal Towers, the new LED EVS Element generates a highly attention-grabbing signal

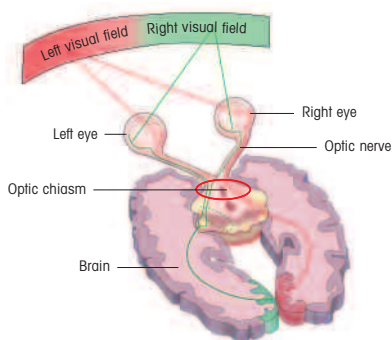

The way in which the brain processes visual stimuli formed the basis for the development of the new EVS technology

- Attention-grabbing flickering light
- Developed on a neurobiological basis
- Extremely powerful signal effect
- Random sequence of light signals prevents acclimatisation effect
- For signalling extremely hazardous situations and the need for immediate action

Life duration up to 50,000 hrs

**i TECHNICAL SPECIFICATIONS:**

Dimensions (Ø x Height):	70 mm x 65 mm
Lens:	PC, transparent
Seal:	Pre-mounted with each element
Number of modules possible:	5, with 2-sided bracket max. 10
Current consumption:	red / yellow: 200 mA green / blue / clear: 150 mA

**🛒 ORDER SPECIFICATIONS:**

Voltage	24 V <sub>==</sub>
red	644 140 55
green	644 240 55
yellow	644 340 55
clear	644 440 55
blue	644 540 55

**⚠️ ADDITIONAL INFORMATION:**

\* EVS = Enhanced Visibility System  
Further informationen can be found in the chapter "Tech-Talk" on page 326.

**EVS – Attention-grabbing light effect on neurobiological basis**

The flickering of neon lamps and comparable light effects are highly effective at attracting our attention. The neurobiological basis of this phenomenon is explained by a university scientist as follows: Light signals are processed in the human brain, not directly in the eye.

In order to be consciously registered there, incoming stimuli first have to pass through a form of filter. This filter has a "protective" function. During sleep it reduces disturbing stimuli to a minimum and assists in "overlooking" regular or continuous signals.

**EVS – Flickering light without acclimatisation effect**

On the basis of this understanding, WERMA's R+D department set out to find a flickering light with a high degree of effectivity in attracting attention. In a multistage laboratory experiment 20 test candidates were asked to judge a series of different light signals and to determine the most eye-catching light. The result of the study was a stochastic flickering light with optimal attention-grabbing characteristics: EVS – Enhanced Visibility System! The light effect of this system is completely new and distinguishes it from all previous systems.

**📐 TECHNICAL DIAGRAMS:**

see page 277

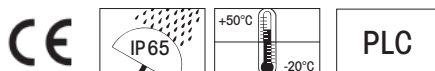



German utility  
model approved



The vocal element can be combined with up to 3 signal elements.



Individual messages can be recorded via the headset with microphone directly on to the PC (accessory, specific version may vary from photo)

- Plays customer-specific audio files in mp3 format (sounds, alarms, music or spoken text)
- Easy programming via USB interface
- Excellent sound quality
- Up to 60 minutes replay capacity
- Positive and negative logic possible
- Adjustable sound output

**i TECHNICAL SPECIFICATIONS:**

Dimensions (Ø x Height):	70 mm x 111 mm
Housing:	PC
Current consumption:	400 mA
Integrated memory:	Approx. 60 min. of replay capacity
Number of sequences recordable:	15, depending on the number of signal elements
Number of additionally signal elements:	Max. 3
Programming:	Via USB connection cable from PC
Sound output:	Adjustable, max. 85 dB

Assembly includes USB connection cable.

mp3 compatible

**ORDER SPECIFICATIONS:**

Vocal element	24 V=
	<b>645 840 55</b>

**ACCESSORIES:**

Headset with microphone	<b>960 645 01</b>
-------------------------	-------------------

**TECHNICAL DIAGRAMS:**

see page 278

This Signal Tower communicates with you – the WERMA Vocal Element!

Plays customer-specific audio files in mp3 format (sounds, alarms, music or spoken text)

Easy programming via USB interface

Excellent sound quality

Up to 60 minutes replay capacity

Adjustable sound output



# Siren Element with self-adjusting sound output for KombiSIGN 71

Patent approved



- Automatic sound output adjustment between 80 and 100 dB
- Sound output is c. 5 dB louder than the background noise level
- Continual measurement of the ambient noise level
- Ideal for applications with changing ambient sound levels

**i TECHNICAL SPECIFICATIONS:**

Dimensions (Ø x Height):	70 mm x 111 mm
Housing:	PC
Tone type:	Pulse tone
Tone frequency:	2.5 KHz
Sound output:	80 dB - max. 100 dB

Loud enough yet not disturbing!

**🛒 ORDER SPECIFICATIONS:**

Voltage:	24 V <sup>≡</sup>
Current consumption:	< 150 mA
	645 810 55

**⚠️ ADDITIONAL INFORMATION:**

The siren element adjusts its sound output through continual measurement of the ambient noise level. The emitted tone is c. 5 dB louder than the background noise level. The warning signal can always be heard without being irritatingly loud for people in the sounder's vicinity.

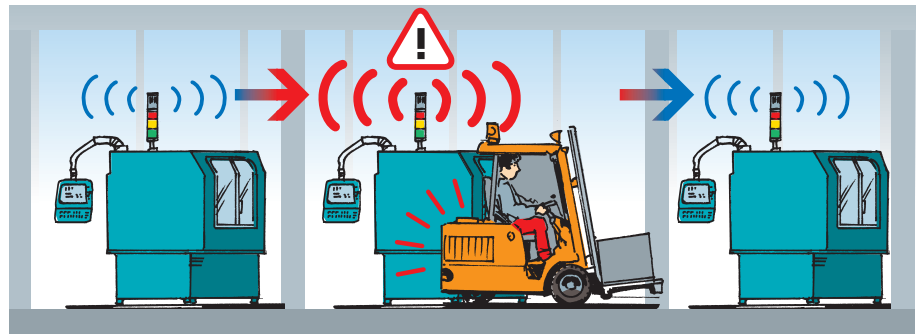

**📏 TECHNICAL DIAGRAMS:**

see page 278





640

# Terminal Element with USB Interface for KombiSIGN 71



Direct triggering of the signal tower via USB Interface



Base for tube (metal) and tube Ø 25 mm (accessories)

- Direct triggering of signal tower elements via USB Interface
- Easy activation
- Can be combined with up to 4 signal elements
- Assembly includes installation software and USB connection cable
- No additional power supply necessary
- No additional hardware needed

## TECHNICAL SPECIFICATIONS:

<b>Dimensions</b> (Ø x Height):	70 mm x 26.5 mm
<b>Material:</b>	PA-GF, shock resistant
<b>Fixing:</b>	Tube mounting
<b>Connection:</b>	USB-Bus
<b>Current carrying capacity</b>	Assembly includes installation software and USB connection cable (AWG 22), 2 m long
<b>Imax:</b>	Maximum permitted length of USB cable (min. AWG 22): 7 m
<b>Current carrying capacity</b>	
<b>Imax:</b>	100 mA

## ORDER SPECIFICATIONS:

Terminal element USB	24 V =
	<b>640 840 00</b>

## ACCESSORIES:

Base with integrated tube	<b>975 840 10</b>		
Tube mounting with base for tube (metal)	<b>975 840 91</b>		
Tube Ø 25 mm			
100 mm long	<b>975 845 10</b>	250 mm long	<b>975 840 25</b>
400 mm long	<b>975 840 40</b>	600 mm long	<b>975 840 60</b>
800 mm long	<b>975 840 80</b>	1000 mm long	<b>975 840 03</b>

## ADDITIONAL INFORMATION:

### Direct triggering via USB Interface

In many applications, it is necessary to indicate operating states or faults by means of an optical signal. A PLC or machine controller is not available in all areas; PCs are often also connected to control the machines. The optimal solution for this is the terminal element with USB interface for KombiSIGN 70, 71 and Kompakt 71.

This innovation in the field of signal towers is controlled directly from the PC and can therefore be put into operation easily and in an uncomplicated manner. Neither a separate power supply nor additional hardware is required because the terminal element with USB interface is based on a standard USB interface.

## TECHNICAL DIAGRAMS:

see page 277





- Signal towers in customer-specific colours
- Meets the demands of an increasing design preference
- Simple ordering procedure
- Complete range of RAL colours available
- High protection rating IP 65

**i TECHNICAL SPECIFICATIONS:**

<b>Dimensions Terminal Elements</b> (Ø x Height):	70 mm x 26.5 mm
<b>Housing Terminal Elements:</b>	PA-GF, fibreglass, high-impact, Cap: PC
<b>Connection:</b>	CAGE CLAMP® technology max. 2.5 mm <sup>2</sup> Contact protection according to VDE
<b>Cable entry:</b>	Cable diameter max. 14 mm
<b>Number of modules possible:</b>	Max. 5
<b>Minimum order quantity:</b>	10 pieces
<b>Delivery time:</b>	By arrangement
<b>Colour Finish:</b>	Matt or gloss

Please state the required RAL number

**🛒 ORDER SPECIFICATIONS TERMINAL ELEMENTS:**

	CAGE CLAMP®	Screw terminal
<b>Terminal element for tube mounting, coated, including cap</b>	640 710 00	640 730 00
<b>Terminal element for bracket or base mounting, coated including cap and seal</b>	640 700 00	640 720 00

**🏠 ACCESSORIES:**

Base with integrated tube, coated Ø 25 mm, 110 mm long, plastic, incl. rubber seals	960 000 24
Bracket for 1-sided mounting, coated, incl. rubber seals	960 000 22

**⚠️ ADDITIONAL INFORMATION:**

Please state the required RAL number and colour finish (matt or gloss) with each of your orders. Slight colour deviations are possible.

**📐 TECHNICAL DIAGRAMS:**

see page 277

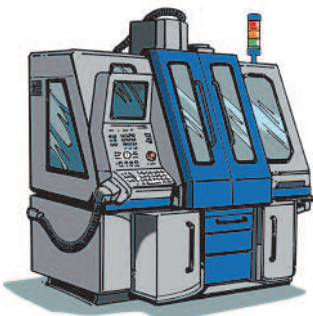

The Signal Towers are designed to harmonise with the colour of the customer's product design, guaranteeing a uniform appearance



The KombiSIGN Signal Towers 71 can be coated in any colour within the RAL spectrum

960

# Interface Box for KombiSIGN 71



Assembly:  
Interface Box and  
terminal element for  
signal tower KombiSIGN 71



Assembly without  
laptop and signal tower elements

- Direct triggering from PC via RS 232 or RS 485 interfaces
- Programming of various drives via serial interface
- Triggering of up to 4 independent elements of a KombiSIGN tower
- Up to 127 signal towers can be addressed (RS 485)
- Monitoring of each element possible
- Versions for Bus systems available on request

## **i** TECHNICAL SPECIFICATIONS:

<b>Dimensions of the Interface box (L x H x W):</b>			80 x 66 x 82 mm
<b>Material:</b>			ABS
<b>Drive:</b>			24 V =
<b>Interfaces:</b>			RS 232, RS 485
<b>Assembly:</b>	<b>960 000 16</b>	<b>960 000 17</b>	
	• Interface box	• Interface box	
	• Terminal element	• Terminal element	
	• 2 cable glands M16	• 1 cable gland M16	
		• Network appliance with cable	
		• Connection cable RS 232, 2 m long, with Sub-D 9-pin and socket for power supply	
		• CD with demonstration programme	
		• Programming handbook	

## **🛒** ORDER SPECIFICATIONS:

Interface box	<b>960 000 16</b>
Interface box incl. accessories	<b>960 000 17</b>

## **📐** TECHNICAL DIAGRAMS:

see page 292 + 293



German utility  
model approved



Maximum stability even with strong shocks and vibrations thanks to the locking mechanism



When transporting the machine, the signal tower can be folded away in a few simple steps



Vertical alignment of signal towers even on sloping surfaces

- The signal tower can be folded away while still connected
- Minimises packaging costs and optimises machine transportation
- Simple mounting and cable entry – for up to Ø 14 mm
- Vertical alignment of signal towers even on sloping surfaces
- Positioning in 7.5° steps, markings for 30, 45, 60 or 90 degrees

### **i** TECHNICAL SPECIFICATIONS:

Dimensions (Ø x Height):	70 mm x 117 mm
Material:	PA-GF
Cable diameter:	Max. 14 mm
Assembly:	Incl. rubber seals
Fixing:	Vertical, horizontal Positioning in 7.5° steps
Suitable for:	Tube, Ø 25 mm, all anodized aluminium, not included in assembly (accessory)

### **🛒** ORDER SPECIFICATIONS:

Foldaway base for KombiSIGN 71      **960 000 30**

### **🏠** ACCESSORIES:

Tube Ø 25 mm, plastic 45 mm long, for direct mounting of the Terminal Element onto the Foldaway Base      **960 000 31**

Tube Ø 25 mm, all anodized aluminium, see page 21

Cable gland M 16 x 1.5 mm      **960 000 04**

### **✓** QUICK AND SIMPLE MOUNTING:

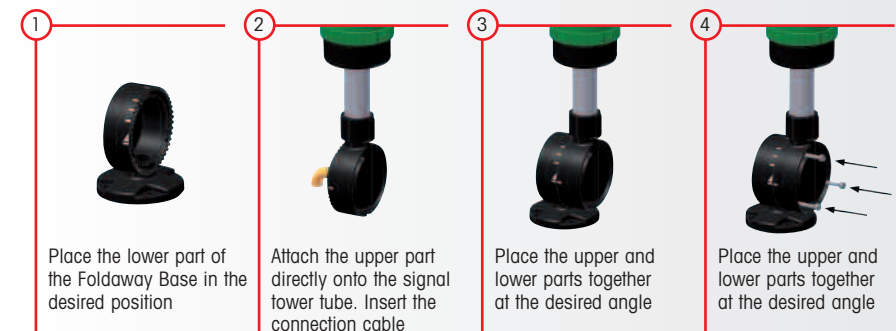

### **📏** TECHNICAL DIAGRAMS:

see page 293

