

WORKING WITH  
OPTIMUM LIGHT

# TANEO



ENGINEERS OF LIGHT

UNIVERSAL LUMINAIRE



ENG

Waldmann



**TANEO.  
ALLROUND TALENT FOR WORKING  
WITH OPTIMUM LIGHT.**

If activities are to meet the highest demands and vision is particularly challenging, then the lighting must certainly not compromise. We at Waldmann have been passionately dedicated to this task since 1928. For the best lighting conditions at any workplace. Always with the user and his benefits in mind.

With application-oriented light output, high lighting quality and ergonomic handling, our TANEO ensures optimum working conditions and can be adapted to individual and activity-related requirements like no other. Whether in manufacturing, assembly, quality assurance or analysis, whether in laboratories, the electronics, metal, textile or watch industries: TANEO is a true universal talent. And because we don't rest on our laurels, but always strive for the best possible technical solution, with TANEO you can now see even better than ever before!

# TANEO. WORKING WITH OPTIMUM LIGHT



## Light quality

**TANEO illuminates homogeneously, free of shadows, reflected glare and flicker, without IR and UV components.** Contrasts are clearly visible and colors are optimally reproduced: with a standard color rendering value of  $Ra > 90$  or daylight-like  $Ra > 95$  for the full-spectrum LED variants for all those for whom color fastness not only plays an important but an outstanding role.

## Individuality

**Personal preferences and different materials require individual light.** The choice of three power levels, two fixed light colors (4000 or 5000 K) or TunableWhite (3000 - 6500 K switchable), cone prisms or opal white screen makes it possible to illuminate exactly as required. And because the amount of light is infinitely dimmable, TANEO also adapts effortlessly here. This ensures well-being and satisfaction for young and old.

**We developed TANEO to make their users' jobs easier: for better vision, better eye health and highly satisfying results. Because when lighting and visual task are in perfect harmony, ideal conditions are created for creating or checking products of the highest quality. No matter if young or older. With TANEO, employees focus on the essentials of their demanding work because the conditions are simply right.**



## **Longevity**

**We design for eternity!** Therefore, TANEO has a closed design to protect the user and the integrated technology. Robust aluminum and fiberglass-reinforced high-performance plastic, just like the maintenance-free LED technology with up to 60,000 hours of service life and more are also the best prerequisites for a long-lasting product choice.

## **Mounting**

**We offer more individual setting options** with the uniquely movable and balanced linkage with an enormous radius of action. Alternatively, TANEO enables space-saving substructure mounting.



# ERGONOMICS IN ALL DETAILS



### Outstanding glare control

TANEO illuminates two-dimensional, homogeneous, glare- and shadow-free.

**The conical prismatic screen (CDP)** is available for bundled light with better luminous efficacy and optimum glare control.

**The opal screen** produces a homogeneous light emission surface. It is ideal for specular or reflective surfaces such as in the jewelry, watch or dental industries. Without reflecting the aperture structure, TANEO optimally supports precise work there.



### Performance levels according to requirements

In three sizes and thus three available power levels, the TANEO can meet any illuminance requirement as needed. The advantage being that both the purchase and the operating costs are based on what is actually needed.



### Unique arm technology

The uniquely movable and balanced arm of the TANEO allows any position to be adjusted with little effort. This is held without further intervention, but can be locked if required. The arm also has a particularly large radius of action. Additionally, the luminaire head is variably thanks to the maximum movable 3D head joint.



### Excellent back protection

The TANEO arm-mounted luminaire is AGR certified: for back-friendly work. Because only those who have ergonomic light that can be perfectly adjusted to individual needs and the requirements of the visual task do not adopt an incorrect posture to compensate for poor visual conditions. This allows you to work in an upright, back-friendly position. More info at [www.waldmann.com](http://www.waldmann.com)

## TUNABLE WHITE. LIGHT COLOR ACCORDING TO INDIVIDUAL REQUIREMENTS.

Different colors of light reflect surfaces and colors quite differently. Depending on the spectrum, our contrast vision differs. It's good when the luminaire ensures that conditions are always perfectly matched to the visual task and optimally support processes. In this way, normative specifications and recommendations or internal test specifications are easily met.

Warm white, neutral white, daylight white? If you have the choice, you're spoiled for choice. Or take all light colors in one luminaire! With TANE0 as Tunable White variant these are quite simply switchable between 3000 K, 4000 K, 5000 K and 6500 K by double click. Also the dimming value is continuously adjustable. And always remains the color rendering with  $Ra > 90$  outstanding. For best visibility, highest concentration and healthy eyes.

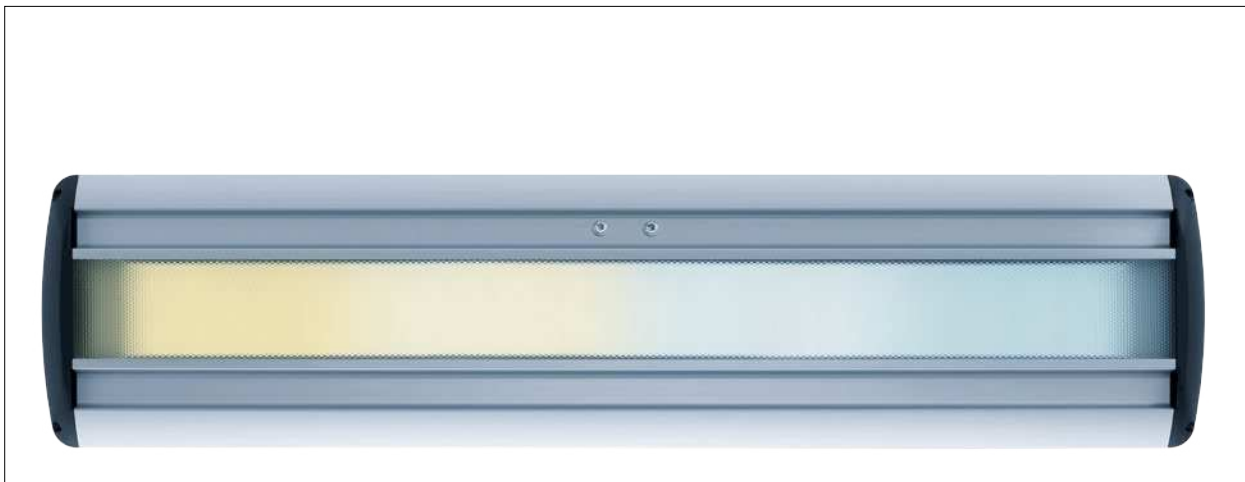

3000 K

4000 K

5000 K

6500 K







**CONVENTIONAL LED**

**FULL SPECTRUM LED IN 5000 K**

## FULL SPECTRUM LED. SEE LIKE DAYLIGHT.

Natural daylight is the best light we humans know. We need it for our well-being and complex biological processes. Our vision is also deeply influenced by it.

Artificial light cannot reproduce all colors as vividly as we know it from daylight. The reason for this is the color spectrum of the illuminants. LEDs in particular differ perceptibly here. That's why TANEО has full-spectrum LED variants and supports true-color vision wherever precision and color fidelity are paramount.

The full spectrum LED technology with a color rendering value of Ra>95 produces a light with a homogeneous light spectrum that is very close to daylight. For brilliant vision and brilliant results. For watchmakers, goldsmiths, dental lab technicians, textile experts and all those who need not only good, but outstanding light for their work.

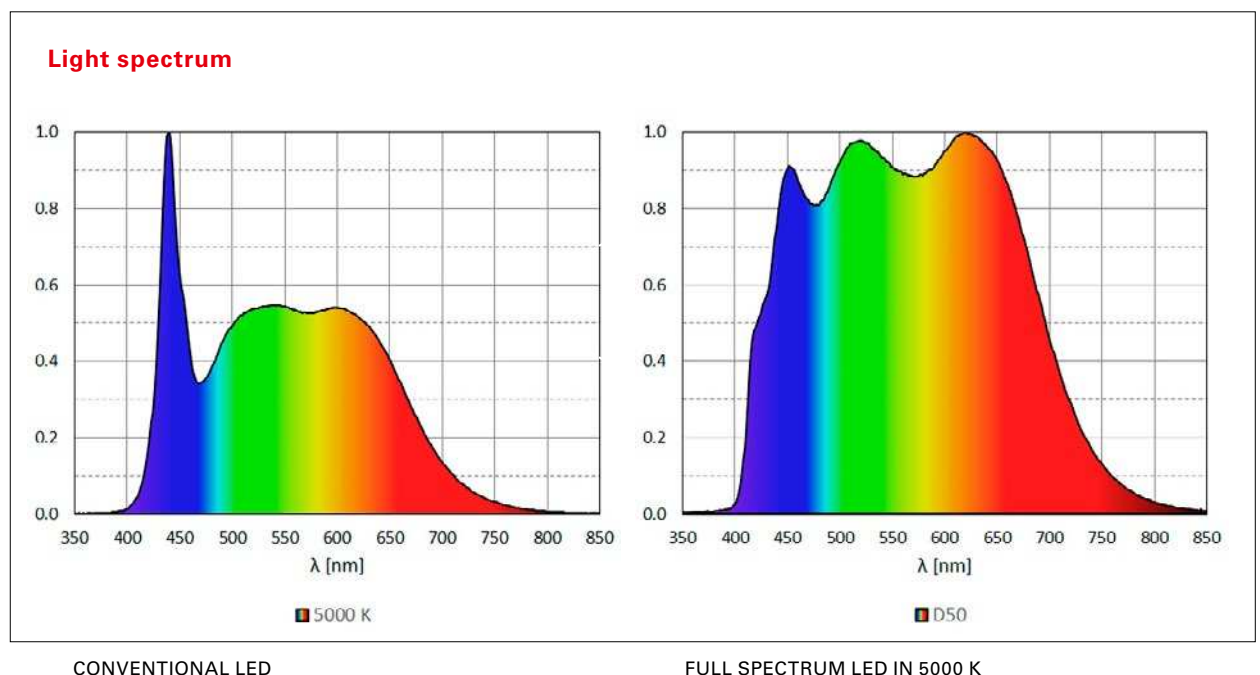

The spirit of Waldmann's founder radiates from the EMIL 28 showroom, a space filled with inspirational lighting ideas.

[#blackforestlight](#)

# SHINE A

Waldmann

The light of precision,  
so productivity improves.

The light of reason,  
so everyone understands.

The light of creativity,  
so better ideas emerge.

The light of knowledge,  
so R&D delivers more findings.

The natural light of day,  
so people stay healthy.

The light of sustainability,  
so nothing goes to waste.

The light of connectivity, so everything  
in the building works as a system.

The light of experience,  
so mistakes don't occur.

The light of success,  
so companies can grow.

Shine the #blackforestlight and  
defeat darkness everywhere.

# ALL LIGHT



# AS SHORT AND TECHNICAL AS POSSIBLE

## Arm-Mounted Luminaire

- Power consumption 12, 23 or 30 W
- Color temperature neutral white 4000 K or 5000 K or TunableWhite switchable between 3000 K, 4000 K, 5000 K and 6500 K
- Glare control via CDP screen or white opal screen
- Color rendering Ra>90 and Ra>95 at full spectrum LED
- Housing of colorless anodised aluminium and black plastic, PMMA screen (CDP) or PC (white opal screen)
- Spring-relieved arm with 3D head joint
- Membrane switch in luminaire head for on/off and dimming
- Protection class IP20, protection class III (luminaire) and II (Power supply unit)
- Plug-in power supply (12 W) or table power supply (23 and 30 W), 100 – 240 V, 50/60 Hz, 3 m connection cable
- Various fasteners as accessories

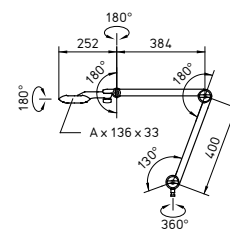

Dimension  
 A: 12 W = 218 mm,  
 23 W = 398 mm,  
 30 W = 577 mm

## Arm-Mounted Luminaire with CDP screen

Power	Dimensions	Specifics	Luminous flux	Model	Ord. No.
12 W	218 mm	5000 K, CDP screen	700 lm	TND 700/950/D	113734000-00809716
12 W	218 mm	4000 K, CDP screen	700 lm	TND 700/940/D	113734000-00809715
12 W	218 mm	3000 K - 6500 K, CDP screen	700 lm	TND 700/930-965/D	113734000-00810075
23 W	398 mm	5000 K, CDP screen	1500 lm	TND 1400/950/D	113735000-00809726
23 W	398 mm	4000 K, CDP screen	1500 lm	TND 1400/940/D	113735000-00809724
23 W	398 mm	3000 K - 6500 K, CDP screen	1500 lm	TND 1400/930-965/D	113735000-00810081
30 W	577 mm	5000 K, CDP screen	2300 lm	TND 2100/950/D	113736000-00809765
30 W	577 mm	4000 K, CDP screen	2300 lm	TND 2100/940/D	113736000-00809764
30 W	577 mm	3000 K - 6500 K, CDP screen	2300 lm	TND 2100/930-965/D	113736000-00810093

## Arm-Mounted Luminaire with white opal screen

Power	Dimensions	Specifics	Luminous flux	Model	Ord. No.
12 W	218 mm	5000 K, Polycarbonate (PC); white opal	600 lm	TND 700/940/D	113734000-00809717
12 W	218 mm	4000 K, Polycarbonate (PC); white opal	600 lm	TND 700/950/D	113734000-00809718
12 W	218 mm	3000 K - 6500 K, Polycarbonate (PC); white opal	600 lm	TND 700/930-965/D	113734000-00810076
14 W	218 mm	5000 K, Full spectrum, Polycarbonate (PC); white opal	600 lm	TND 700/D50/D	113734000-00810077
23 W	398 mm	4000 K, Polycarbonate (PC); white opal	1400 lm	TND 1400/940/D	113735000-00809728
23 W	398 mm	5000 K, Polycarbonate (PC); white opal	1400 lm	TND 1400/950/D	113735000-00809729
23 W	398 mm	3000 K - 6500 K, Polycarbonate (PC); white opal	1400 lm	TND 1400/930-965/D	113735000-00810082
27 W	398 mm	5000 K, Full spectrum, Polycarbonate (PC); white opal	1400 lm	TND 1400/D50/D	113735000-00810083
30 W	577 mm	4000 K, Polycarbonate (PC); white opal	2000 lm	TND 2100/940/D	113736000-00809766
30 W	577 mm	5000 K, Polycarbonate (PC); white opal	2000 lm	TND 2100/950/D	113736000-00809767
30 W	577 mm	3000 K - 6500 K, Polycarbonate (PC); white opal	2000 lm	TND 2100/930-965/D	113736000-00810094
38 W	577 mm	5000 K, Full spectrum, Polycarbonate (PC); white opal	2000 lm	TND 2100/D50/D	113736000-00810095

### Arm-Mounted Luminaire with white opal screen and short support arm for watchmaker workplace

Power	Dimensions	Specifics	Luminous flux	Model	Ord. No.
23 W	398 mm	5000 K, Polycarbonate (PC); white opal	1400 lm	TND 1400/950/D	113735000-00809730
27 W	398 mm	5000 K, Full spectrum, Polycarbonate (PC); white opal	1400 lm	TND 1400/D50/D	113735000-00810084

### Arm-Mounted Luminaire with CDP screen in ESD design

Power	Dimensions	Specifics	Luminous flux	Model	Ord. No.
24 W	398 mm	4000 K, CDP screen; painted black	1500 lm	TND 1400/940/AD	113735000-00809725
24 W	398 mm	5000 K, CDP screen; painted black	1500 lm	TND 1400/950/AD	113735000-00809727

### Workplace-System Luminaire

- Power consumption 23 and 30 W (fixed connection)
- Color temperature neutral white 4000 K or 5000 K
- Glare control via CDP screen or white opal screen
- Color rendering  $R_a > 90$
- Housing of colorless anodised aluminium and black plastic, PMMA screen (CDP) or PC (white opal screen)
- Fixed connection (23 and 30 W), with rotatable head joint
- Membrane switch in luminaire head for on/off and dimming
- Protection class IP20, protection class III (luminaire) and II (Power supply unit)
- Table power supply (23 and 30 W), 100 – 240 V, 50/60 Hz, 4 m connection cable

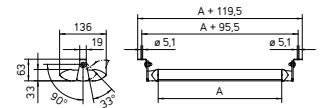

Dimension  
 A: 23 W = 359,5 mm,  
 30 W = 538,5 mm

Power	Dimensions	Specifics	Luminous flux	Model	Ord. No.
23 W	398 mm	4000 K, CDP screen	1500 lm	TNU 1400/940/D	114460000-00811087
23 W	398 mm	5000 K, CDP screen	1500 lm	TNU 1400/950/D	114460000-00811088
23 W	398 mm	4000 K, Polycarbonate (PC); white opal	1400 lm	TNU 1400/940/D	114460000-00811074
23 W	398 mm	5000 K, Polycarbonate (PC); white opal	1400 lm	TNU 1400/950/D	114460000-00811075
30 W	577 mm	4000 K, CDP screen	2300 lm	TNU 2100/940/D	114461000-00811084
30 W	577 mm	5000 K, CDP screen	2300 lm	TNU 2100/950/D	114461000-00811085
30 W	577 mm	4000 K, Polycarbonate (PC); white opal	2000 lm	TNU 2100/940/D	114461000-00811086
30 W	577 mm	5000 K, Polycarbonate (PC); white opal	2000 lm	TNU 2100/950/D	114461000-00811109

Herbert Waldmann GmbH & Co. KG  
Peter-Henlein-Straße 5  
78056 Villingen-Schwenningen, Germany  
Telephone +49 7720 601-0  
Telephone +49 7720 601-100 (Sales)  
Fax +49 7720 601-290  
www.waldmann.com  
sales.germany@waldmann.com

**(1 of 1000)**

We would like to spotlight the people at Waldmann who do their utmost to create the best possible lighting solutions. Thank you Kim!

A portrait of a woman with short blonde hair, wearing a blue blazer over a white top and a gold necklace. She is smiling and looking slightly to the right.

**ENGINEERS  
OF LIGHT:  
KIM**