

NOTES:

- MATERIALS AND FINISHES (PLATING THICKNESS IN MICROINCHES):
  - BODY ASSEMBLY - BRASS, GOLD PLATING (50 MIN THICK)
  - CAP - BRASS, GOLD PLATING (50 MIN THICK)
  - LOOSE CONTACT & ASSEMBLED CONTACT - BeCu, GOLD PLATING (50 MIN THICK)
  - GASKET - SILICONE RUBBER
  - RETAINGING RING - BeCu
  - COUPLING NUT - BeCu, GOLD PLATING (50 MIN THICK)
  - OUTER FERRULE - COPPER, GOLD PLATING (50 MIN THICK)
  - HEAT SHRINK TUBING - POLYOLEFIN
  - ASSEMBLED CONTACT - BRASS, GOLD PLATING (50 MIN THICK)
  - INSULATORS - PTFE

- ELECTRICAL:
  - IMPEDANCE: 50 OHM
- MECHANICAL:
  - DURABILITY: 500 CYCLES MIN.
  - TEMPERATURE RANGE: -65° C TO +165° C

- PACKAGING:
  - QUANTITY: SINGLE PACK
  - MARKING: BAG TO BE MARKED "AMPHENOL, 901-148-15, AND DATE CODE"

- CABLE ASSEMBLY INSTRUCTIONS
  - TRIM CABLE AS SHOWN.
  - SOLDER CABLE CENTER CONDUCTOR TO CONTACT.
  - INSERT CABLE WITH PTFE INSULATOR ENTERING CONNECTOR AND BRAID OVER KNURL.
  - CRIMP FERRULE WITH AMPHENOL TOOL 227-944 AND DIE SET 227-1221-57 CLOSURE 'A', .213" HEX DIE. USE M22520/1-15 POSITIONER.

6 SHOWS CABLE ENTRY DIMENSIONS.

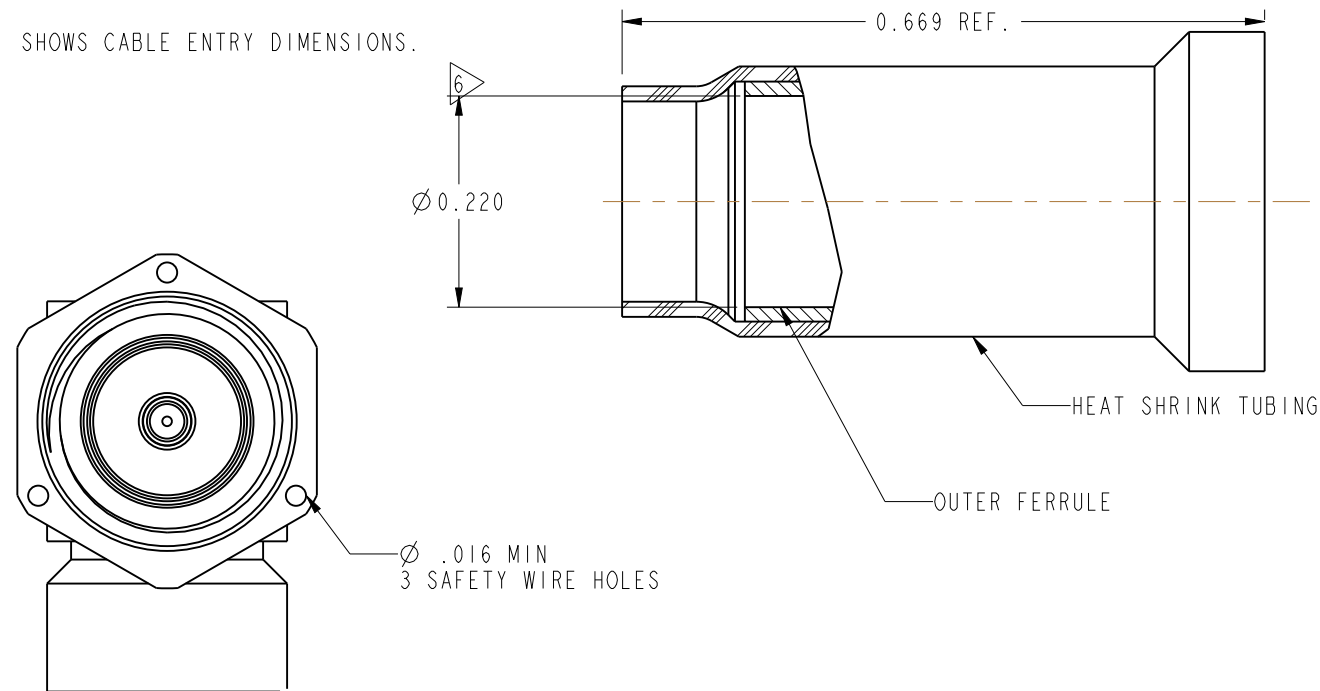

THIRD ANGLE PROJ.

REVISIONS

REV	DESCRIPTION	DATE	ECO	APPR
--	OFFICIAL ENG. RELEASE TO MFG.	-----	-----	
AA	REDRAWN IN PRO E & ADDED COD	9/20/13	49679	KR
AB	ADDED VIEW FOR WIRE HOLES	3/19/14	49912	CPM

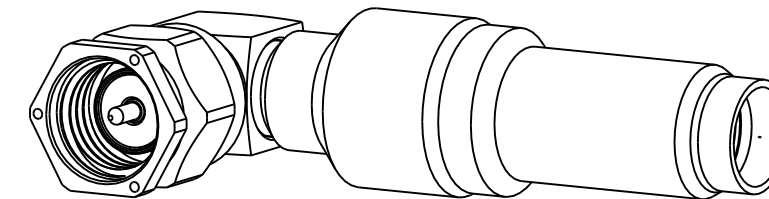

SCALE 2.500

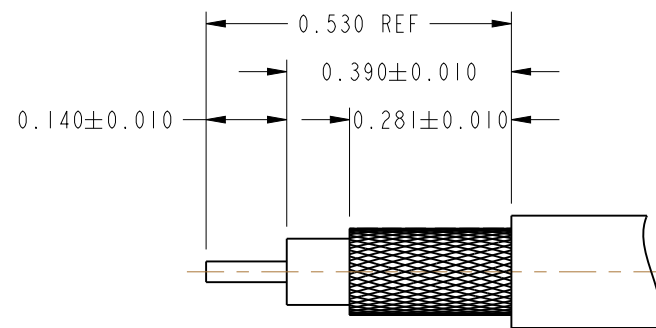

**RECOMMENDED CABLE STRIPPING DIMENSIONS**

**MIL-C-39012 INSPECTION**

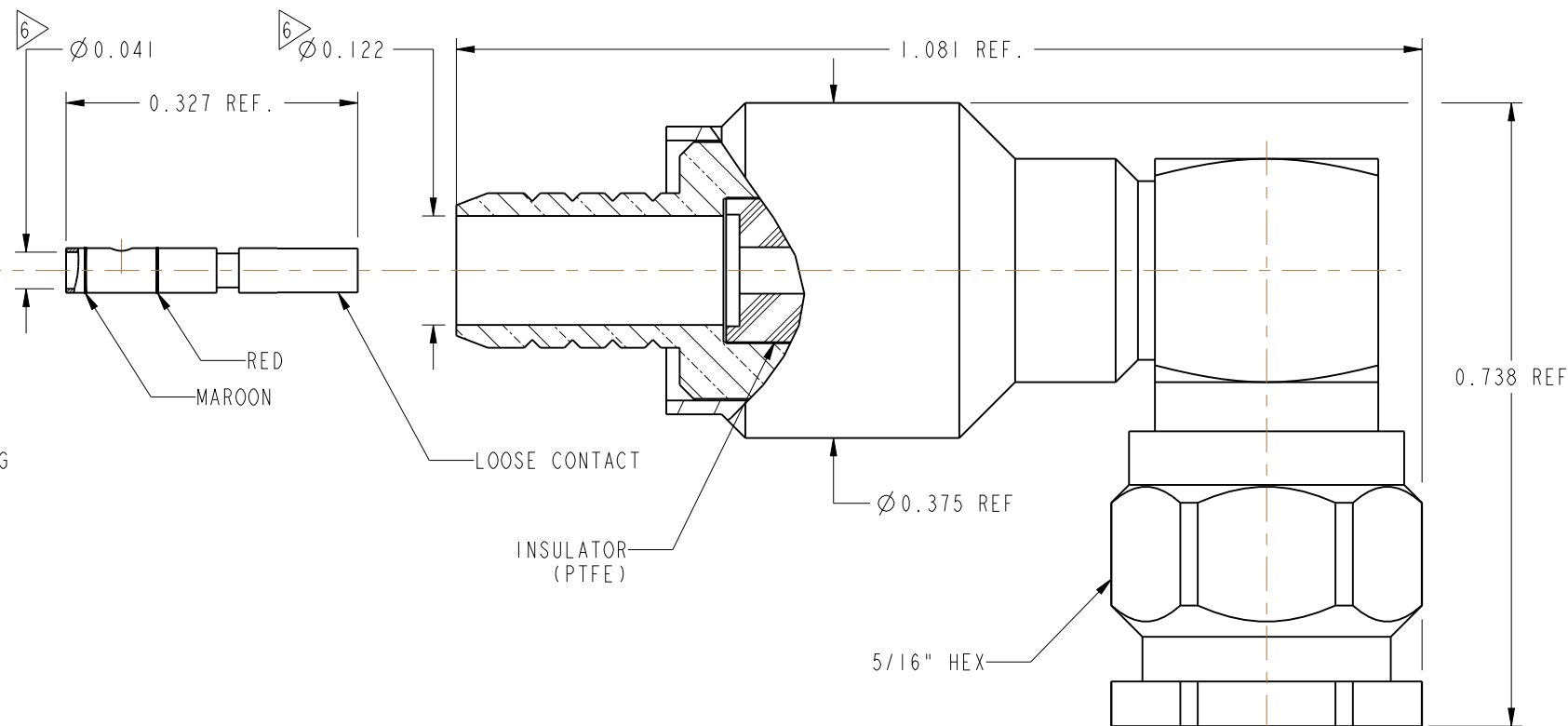

**CUSTOMER OUTLINE DRAWING**

ALL OTHER SHEETS ARE FOR INTERNAL USE ONLY

INTERFACE PER MIL-STD-348 SMA SERIES

**THIS CONNECTOR IS COVERED BY U.S. PATENT 3,439,294.**

UNLESS OTHERWISE SPECIFIED, DIMENSIONS ARE IN INCHES AND TOLERANCES ARE:  
 2 PLACE DECIMAL 3 PLACE DECIMAL ANGLES  
 ±.015 (0.381 mm) ±.005 (0.127 mm) ± 1°

NOTICE - These drawings, specifications, or other data (1) are, and remain the property of Amphenol corp. (2) must be returned upon request; and (3) are confidential and not to be disclosed to any person other than those to whom they are given by Amphenol Corp. the furnishing of these drawings, specifications, or other data by Amphenol Corp., or to any other person to anyone for any purpose is not to be regarded by implication or otherwise in any manner licensing, granting rights to permitting such holder or any other person to manufacture, use or sell any product, process or design, patented or otherwise, that may in any way be related to or disclosed by said drawings, specifications, or other data.

MATERIAL	SEE NOTES	DRAWN	KARTHIK R	DATE	12-Aug-13	TITLE	SMA 90° PLUG CRIMP TYPE FOR RG-400/U & 142/U CABLE	Amphenol RF	www.amphenolrf.com
REFERENCE	DOR 312191-51 M39012/56-4502	ENGINEER	ABR	DATE	09-Jul-80				
FINISH		APPROVED	K. CAPOZZI	DATE	9/20/13	SCALE: 5.0:1.0	SHEET 2 OF 2	DRAWING NO. 901-148-15	ITEM NO. 901-148-15
		CAD FILE				DWG SIZE	B	PART NO. 901-148-15	
						REV	AB		