

E20060

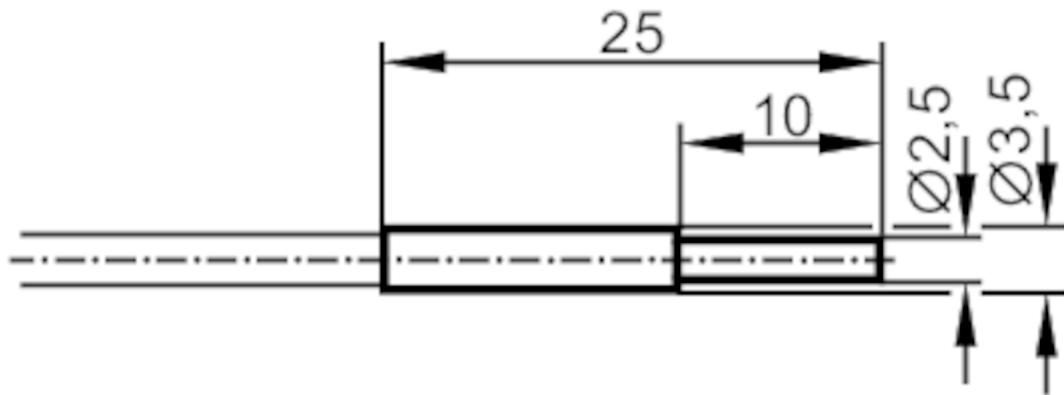

Fibre optic through beam sensor

FE-00-P-A-E2,5



Application	
Function principle	Through-beam sensor
Detection zone	
Range with fibre optic amplifier type	OKF; OUF; OOF
OKF	
Range of fibre optics [mm]	120
OUF	
Range of fibre optics [mm]	400
OOF	
Range of fibre optics [mm]	120
Operating conditions	
Ambient temperature [°C]	-20...80

E20060



Fibre optic through beam sensor

FE-00-P-A-E2,5

Mechanical data	
Weight [g]	53.5
Version of sensing head	straight
Sensing head diameter [mm]	2.5
Sensing head length [mm]	10
Total length [mm]	600
Min. bending radius [mm]	10
Fibre arrangement	●
Materials	Adapter: PPE
Fibre material	glass
Fibre head material	aluminium
Fibre sheath material	PVC
Accessories	
Accessories (supplied)	E20106
Remarks	
Pack quantity	1 pcs.